



Three Bedroom Terraced House  
Hero Walk, Rochester, Kent, ME1 2UZ

£200,000  
Freehold



# Hero Walk, Rochester, Kent, ME1 2UZ

£200,000

Freehold

## Description

A rare opportunity to purchase a house in Rochester requiring significant refurbishment but when done would make a lovely family home. The house is being offered with no chain.

At the front of the property is a porch and an area off of here for potential office/storage. The lounge is to the front aspect. There is a kitchen/breakfast room along with a lean to style conservatory - offering the footprint for an updated version to be created. There is a handy downstairs cloakroom. Upstairs are three good sized bedrooms and bathroom. There is a compact rear garden and a garage space. Unique chance for future investment opportunity.

## Key Features

- Three Bedrooms
- Refurbishment Project
- Rochester
- No Chain
- Mid Terrace House
- Front & Rear Garden
- Investment Opportunity
- Garage Requiring Refurbishment

## Local Area

Historic Rochester offers a variety of historic buildings including Rochester Castle and Cathedral. The area also offers a variety of restaurants, coffee shops and bars. There is a selection of schools in the area including Rochester Grammar for girls and Sir Joseph Williamson Mathematical for boys, along with further secondary and Primary schools near by.

GROUND FLOOR  
650 sq.ft. (60.3 sq.m.) approx.

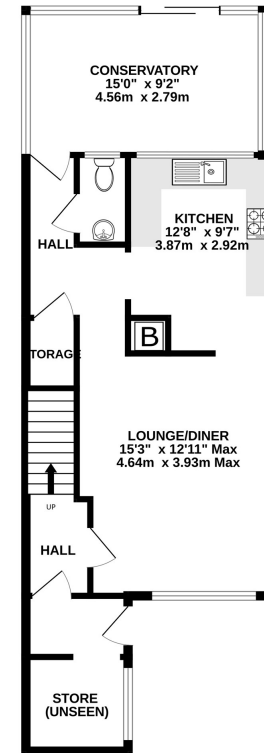

1ST FLOOR  
463 sq.ft. (43.0 sq.m.) approx.

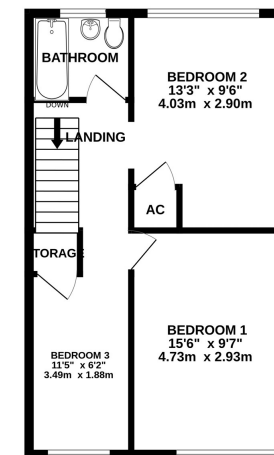

TOTAL FLOOR AREA : 1112 sq.ft. (103.3 sq.m.) approx.

Whilst every attempt has been made to ensure the accuracy of the floorplan contained here, measurements of doors, windows, rooms and any other items are approximate and no responsibility is taken for any error, omission or mis-statement. This plan is for illustrative purposes only and should be used as such by any prospective purchaser. The services, systems and appliances shown have not been tested and no guarantee as to their operability or efficiency can be given.  
Made with Metropix ©2025





### Property Location

Hero Walk, Rochester, Kent, ME1 2UZ

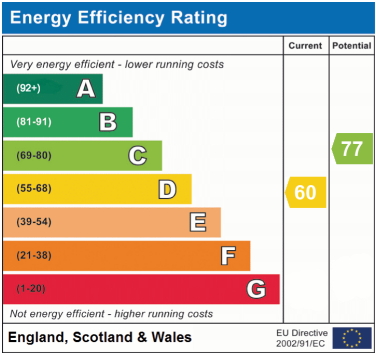
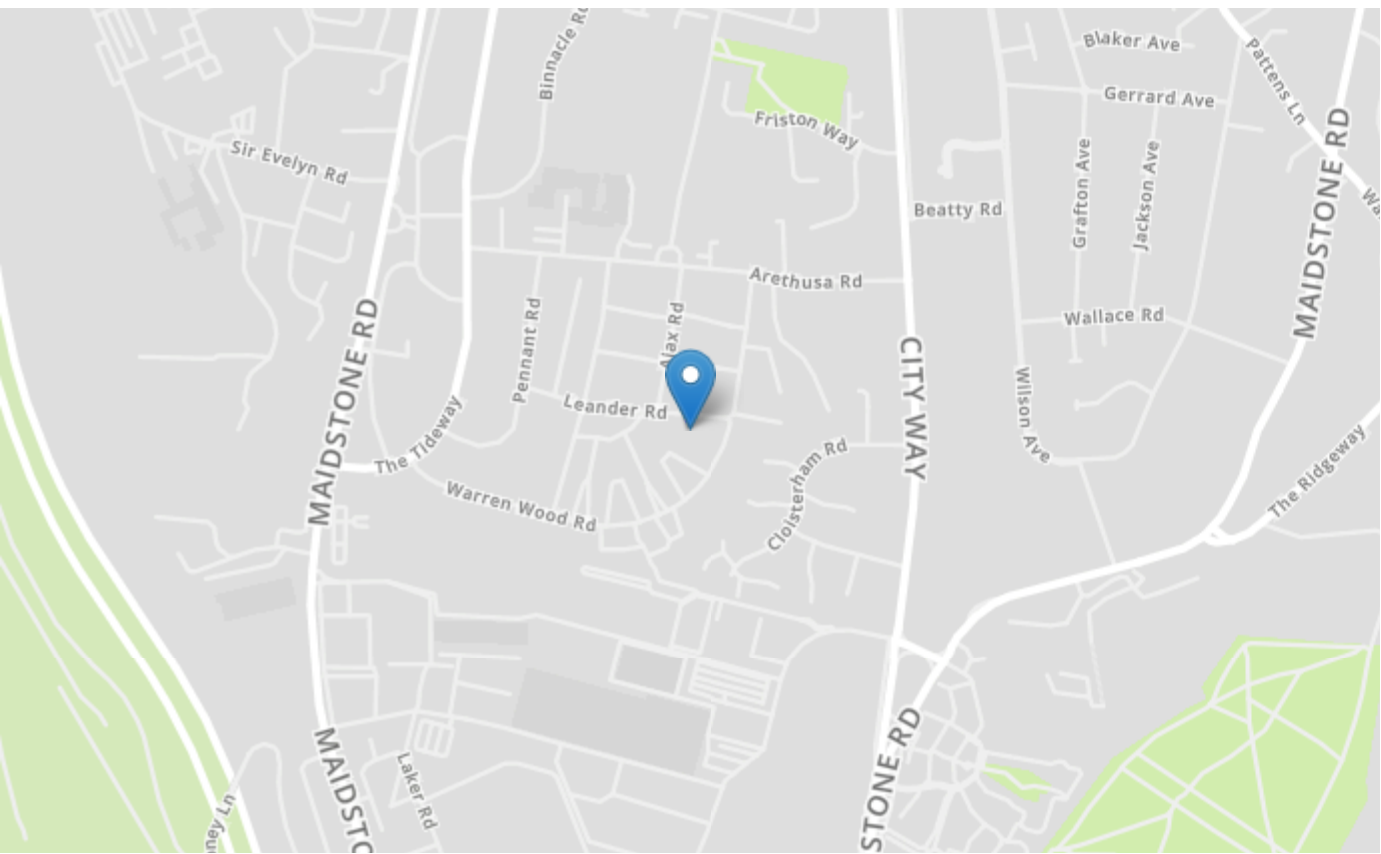

|                 |          |
|-----------------|----------|
| Tenure          | Freehold |
| Lease Term      | N/A      |
| Ground Rent     | N/A      |
| Service Charge  | N/A      |
| Local Authority | Medway   |
| Council Tax     | Band C   |

**Greyfox Walderslade**  
 Unit 2, Thetford House  
 Walderslade Village Centre  
 Walderslade Road  
 Chatham  
 Kent  
 ME5 9LR  
 Tel: 01634 672227 Email:  
 walderslade@greyfox.co.uk

**Greyfox Rainham**  
 67C High Street  
 Rainham  
 Kent  
 ME8 7HS  
 Tel: 01634 377737 Email:  
 rainham@greyfox.co.uk

**Agent Notes**  
 These particulars are prepared as a general guide to a broad description of the property and should not be relied upon as a statement or representation of fact and do not constitute part of an offer or contract. The seller does not make or give nor do our employees or Greyfox have authority to make or give any representation or warranty to the property. We have not carried out a structural survey and the services, appliances and specific fittings have not been tested. All photographs, measurements, floorplans and distances referred to are given as a guide only and should not be relied upon for the purchase of carpets or any other fixtures or fittings. Lease details, service charges and ground rent (where applicable) and council tax are given as a guide only and should be checked and confirmed by you on inspection and your solicitor prior to exchange of contracts. If there are any points of particular importance to you we will be pleased to check the information for you and to confirm that the property remains available. This is particularly important should you be travelling some distance to view and where statements have been made by us to the effect that the information has not been verified. The copyright of all details, photographs and floorplans remain exclusive to Greyfox. For details of our privacy policy and referral fee arrangements with any of our selected partner companies please visit <https://www.greyfox.co.uk/legal/privacy> and <https://www.greyfox.co.uk/referral-fees>.