

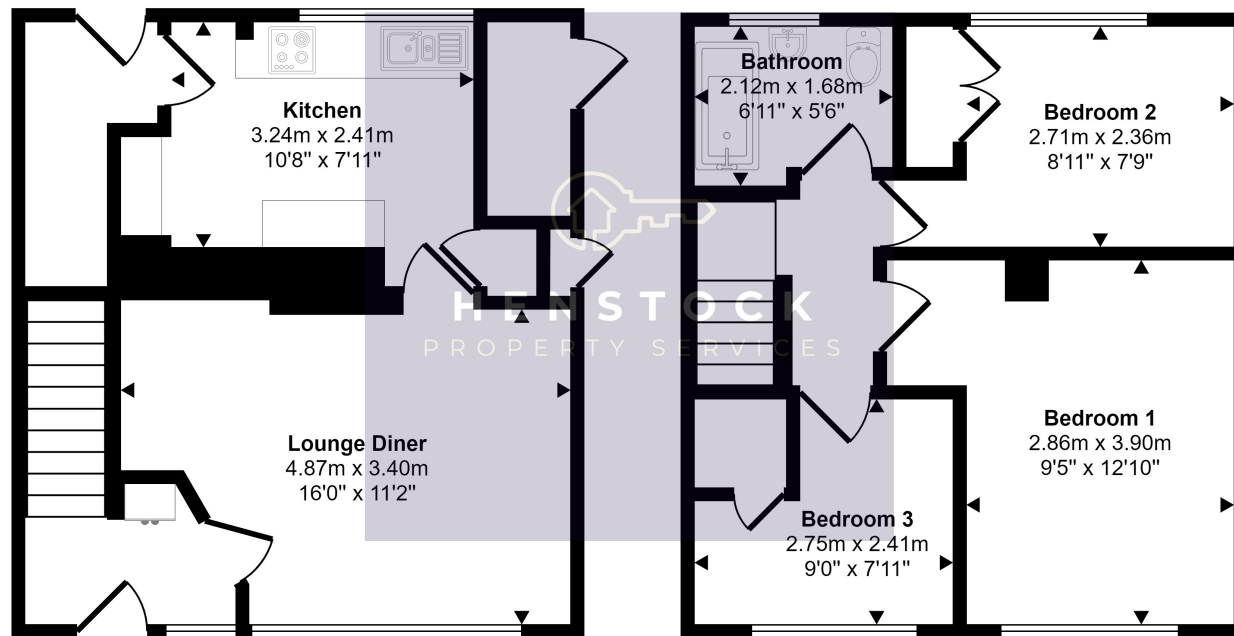

HENSTOCK
PROPERTY SERVICES

Approx Gross Internal Area
74 sq m / 795 sq ft



This floorplan is only for illustrative purposes and is not to scale. Measurements of rooms, doors, windows, and any items are approximate and no responsibility is taken for any error, omission or mis-statement. Icons of items such as bathroom suites are representations only and may not look like the real items. Made with Made Snappy 360.

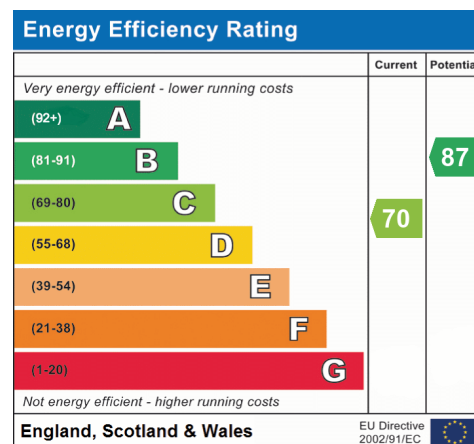

**71 Tintern Road, Middleton, Manchester,
Lancashire M24 6HT**

- 3 BEDROOMED END QUASI
- NO CHAIN
- REAR GARDEN
- DOUBLE GLAZED WINDOWS

£149,950



PROPERTY DESCRIPTION

Henstock Property Services are pleased to market this 3 bedroomed end quasi semi-detached family home. The living accommodation briefly comprises; entrance hallway, front lounge, fitted kitchen/diner with pantry store, 3 bedrooms and a bathroom. The property also has the benefit of part gas central heating, double glazed windows and lawned garden to rear. Ideally situated in this popular spot within easy reach of schools, shops/supermarkets, leisure/fitness facilities, good public transport services and a short distance from the M60 & M62 motorway links.

GROUND FLOOR

Entrance

Hallway

Lounge

4.73m x 3.83m (15' 6" x 12' 7") L shaped into recess, views to front, wall mounted gas fire.

Kitchen/Diner

2.42m x 3.74m (7' 11" x 12' 3") into recess, views to rear, oatmeal style units, matching worktops, 4 ring gas hob, stainless steel sink with chrome taps, small breakfast bar, part tiled walls, double radiator.

Pantry/Store

.77m x 1.04m (2' 6" x 3' 5") door to rear corridor out to garden.

FIRST FLOOR

Bedroom 1

3.97m x 3.87m (13' 0" x 12' 8") views to front, double radiator.

Bedroom 2

2.53m x 2.91m (8' 4" x 9' 7") views to rear, storage cupboard.

Bedroom 3

2.78m x 2.47m (9' 1" x 8' 1") views to front, oak effect laminate flooring, built in cupboard.

Bathroom

2.16m x 1.70m (7' 1" x 5' 7") views to rear, white suite comprising; bath with over bath wall mounted electric shower, close coupled w.c, sink, part tiled walls, oak effect laminate flooring, double radiator.

Exterior

Front Garden - mostly paved and stone chipped.
Rear garden - paved path with central lawn.

