



3 Stonepark Corner Ringwood Road, Parkstone, Poole, Dorset BH12 4LX £250,000 Share of Freehold

A stunning collection of two bedroom purpose built apartments within this elite development of just six. Currently being constructed by renowned award winning developers Fortitudo. This superb home is ideally situated in Parkstone with easy access to both Poole and Bournemouth whilst the popular Tower Park with its array of eateries, entertainment facilities and Tesco Extra is also close to hand. Internal viewing of this luxurious 'London living' property is a must to appreciate the accommodation on offer, which comprises: open plan living area, bespoke kitchen with integrated appliances, BALCONY and contemporary bathroom. Further features include; Air Source Heat pumps, electric heating, communal EV Chargers, SHARE OF FREEHOLD, 10 year ICW building warranty, PET FRIENDLY, holiday lets permitted, £750+VAT SOLICITOR FEE CONTRIBUTION

info@anthonydavid.co.uk  
 www.anthonydavid.co.uk  
 (01202 677444)



FIRST FLOOR  
667 sq.ft. (62.0 sq.m.) approx.

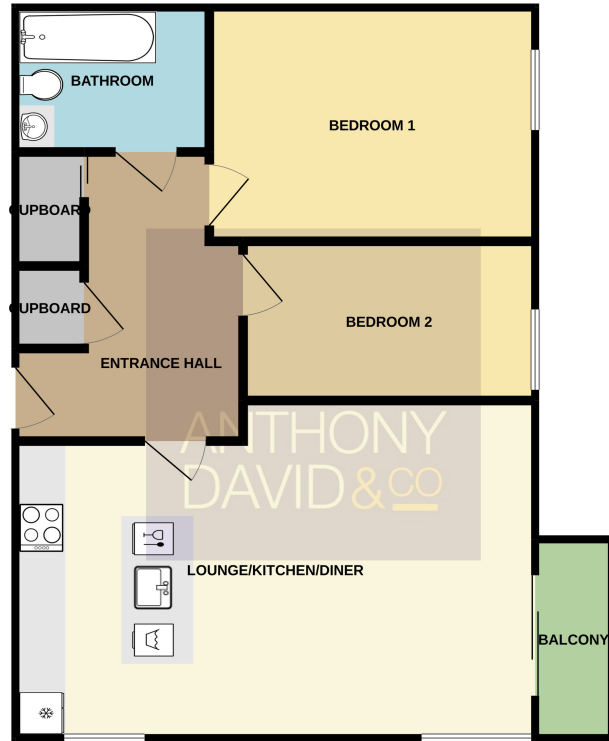

Entrance Hall Doors to

Open Plan Living 21' 3" x 13' 10" (6.48m x 4.22m) max

Balcony

Bedroom One 13' 5" x 9' 8" (4.09m x 2.95m)

Bedroom Two 12' 0" x 6' 7" (3.66m x 2.01m)

Bathroom 7' 3" x 5' 10" (2.21m x 1.78m)

Tenure Share of Freehold

Lease 999 years

Service Charge £1200 per annum

TOTAL FLOOR AREA : 667sq.ft. (62.0 sq.m.) approx.

Whilst every attempt has been made to ensure the accuracy of the floorplan contained here, measurements of doors, windows, rooms and any other items are approximate and no responsibility is taken for any error, omission or mis-statement. This plan is for illustrative purposes only and should be used as such by any prospective purchaser. The services, systems and appliances shown have not been tested and no guarantee as to their operability or efficiency can be given.  
Made with Metropix ©2022



Property Misdescriptions Act 1991  
Property details contained herein do not form part of an offer or contract. Any measurements are included for guidance only and as such must not be used for the purchase of carpets or fitted furniture. We have not tested any apparatus, equipment, fixtures, fittings or services neither have we confirmed or verified the legal title of the property. All prospective purchasers must satisfy themselves as to the correctness and accuracy of such details provided by us. We accept no liability for any existing or future defects relating to any property.