



St Michaels Road

Hitchin | Hertfordshire | SG4 0PZ

www.stonegate-estates.co.uk



ST MICHAELS ROAD

Property Description

Situated in a sought-after location in Hitchin, this immaculately presented two double bedroom mid-terrace home offers the perfect blend of modern living and convenience.

Surrounded by green spaces and just a short walk to Hitchin train station, this property is ideal for commuters, first-time buyers, or young families.

Internally, the home has been finished to a high standard and features:

Two spacious double bedrooms

Stylish modern kitchen and contemporary bathroom

New carpets throughout for a fresh, clean finish

New double glazing (2024) offering excellent energy efficiency

New boiler, providing reliable and efficient heating

Refurbished garden office – ideal for remote working or creative use

Excellent broadband speeds

Highly regarded Ofsted-rated schools within close proximity

This turnkey property is move-in ready, offering light-filled interiors and a private, low-maintenance garden space. With both natural beauty and town amenities on your doorstep, early viewing is highly recommended.

£360,000 Freehold



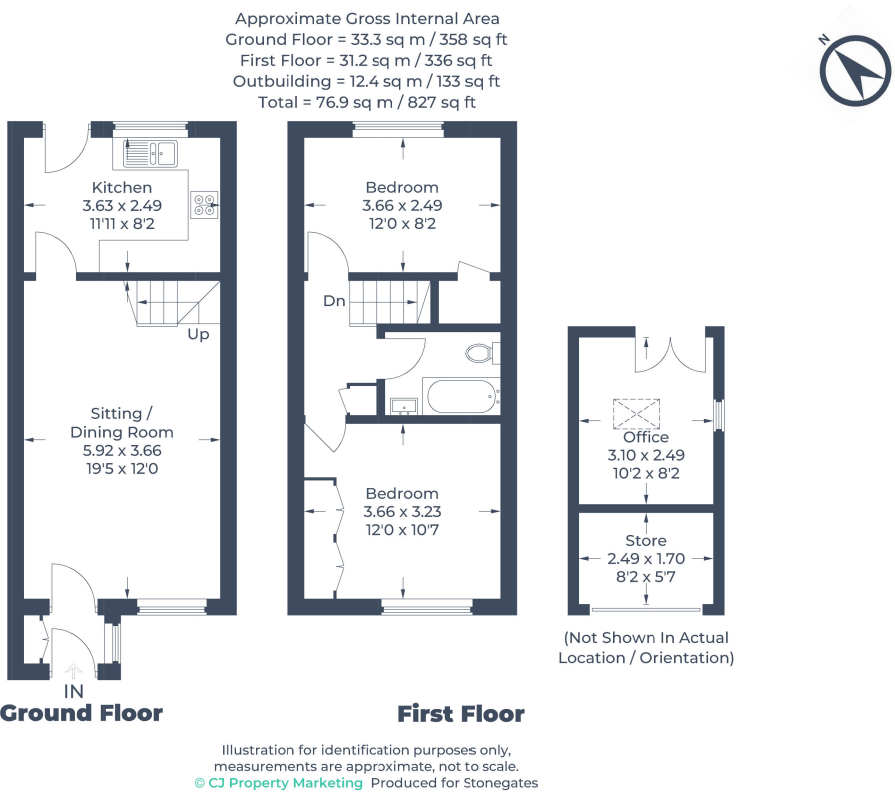



- Two Double Bedrooms
- Walking distance to Main Line Station
- Garage
- Enclosed Courtyard Garden
- Refurbished Throughout
- Excellent Decorative Order
- Ideal First Time Buy
- Viewing Advised to Fully Appreciate

EPC Rating: C

Stonegate Estate Agents

01462 438979

sales@stonegate-estates.co.uk | www.stonegate-estates.co.uk

