



Belsize Park, London, NW3

£2,600
pcm



Belsize Park, London, NW3

Located in the heart of Belsize Park is the two bedroom top floor apartment offering circa 700 Sq Ft (65 Sq M) of internal space. This flat includes a bright and spacious reception room, separate kitchen and a generous principal bedroom.

This property is located just 0.4 miles from Belsize Park Underground station (Northern Line) with local amenities, shops and cafes positioned closed by on Haverstock Hill.

Features

- Located In The Heart Of Belsize Park
- Offered Unfurnished
- Top Floor Apartment
- Available From 8th October 2024
- Two Bedroom Flat
- Spacious Reception Room
- 0.4 Miles From Belsize Park Underground
- Circa 700 Sq Ft (65 Sq M) Of Internal Space



Belsize Park, London, NW3

Belsize Park NW3

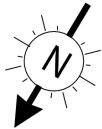

○ - Ceiling Height

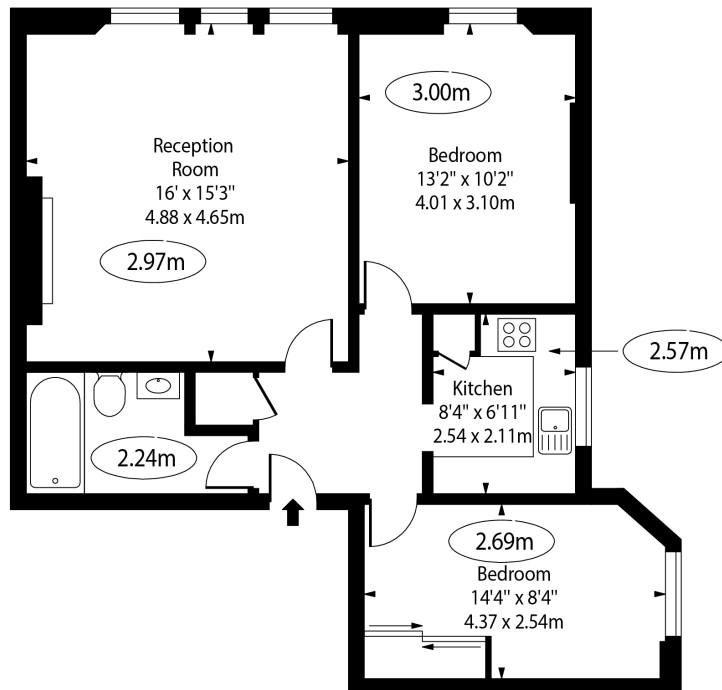

Second Floor

Approx Gross Internal Area 696 Sq Ft - 64.66 Sq M

For Illustration Purposes Only - Not To Scale Floor Plan by www.nogaphotostudio.com Ref: No.50619

This floor plan should be used as a general outline for guidance only. Any intending purchaser or lessee should satisfy themselves by inspection, searches, enquiries and full survey as to the correctness of each statement. Any areas, measurements or distances quoted are approximate and should not be used to value a property or be the basis of any sale or let.