



2 Mount Pleasant Close, Lyminge, Folkestone, Kent, CT18 8HF

EPC Rating = C

Guide Price £375,000





An opportunity to purchase a beautifully presented two bedroom detached bungalow set in a quiet cul de sac with pretty garden, driveway and garage. No Chain!  
EPC Rating = C

**Guide Price £375,000**

**Tenure** Freehold

**Property Type** Detached Bungalow

**Receptions** 2

**Bedrooms** 2

**Bathrooms** 1

**Parking** Driveway & garage

**Heating** Gas

**EPC Rating** C

**Council Tax** Band D

Folkestone And Hythe District Council





## Welcome to this lovely bungalow in a sought after quiet cul de sac

## Welcome to this lovely bungalow in a sought after and quiet cul de sac

The covered porch sets a welcoming tone from the moment you approach the property and the spacious entrance hall provides a sense of openness and flow as you step inside. The living room is a bright and comfortable space, especially with the addition of double glazed sliding doors leading to the conservatory, which offers a perfect spot to relax and enjoy the garden views. The timeless kitchen offers a functional space for cooking and entertaining. With two bedrooms, there's flexibility for various living arrangements, with a bright double bedroom and a guest room or home office. The stylish shower room/WC adds a touch of luxury and convenience. Outside, the property continues to impress with its attractive frontage, with an array of plants and shrubs, offering plenty of curb appeal. The driveway and garage provide practicality and convenience for parking and storage. The pretty rear garden, has been designed for ease of maintenance and is a tranquil oasis, perfect for outdoor relaxation. The sun terrace and large store/summerhouse is undoubtedly a highlight, offering a fantastic space for outdoor dining, entertaining, or simply soaking up the sunshine.



## Situation

The property is situated in 'Mount Pleasant Close' which is a quiet cul de sac in the village of Lyminge which is nestled in the spectacular North downs which has a wonderful semi-rural feel, with an abundance of beautiful walks nearby and benefiting from the amenities the village has to offer. There is a Post Office & convenience Shop, hairdressers, two Doctors surgeries, Chemist and Primary School. The village offers various clubs and societies and there are good bus links to both Canterbury and Folkestone. Lyminge is a thriving community with lots of activities for all ages. In the nearby town of Folkestone there are mainline railway stations with High Speed services to London.





**Covered entrance**

**Spacious entrance hall**

**Kitchen/dining**

15' 4" x 10' 8" (4.67m x 3.25m)

**Living room**

14' 5" x 12' 11" (4.39m x 3.94m)

**Conservatory**

10' 2" x 7' 7" (3.10m x 2.31m)

**Bedroom one**

12' 6" x 9' 11" (3.81m x 3.02m)

**Bedroom two**

9' 9" x 7' 2" (2.97m x 2.18m)

**Shower room/WC**

**Outside**

**Detached garage and driveway**

16' 4" x 8' 4" (4.98m x 2.54m) Detached garage approached over driveway providing off road parking

**Pretty frontage and attractive rear garden**













Approximate Gross Internal Area (Including Low Ceiling) = 68 sq m / 728 sq ft  
 Outbuildings / Garage = 13 sq m / 135 sq ft

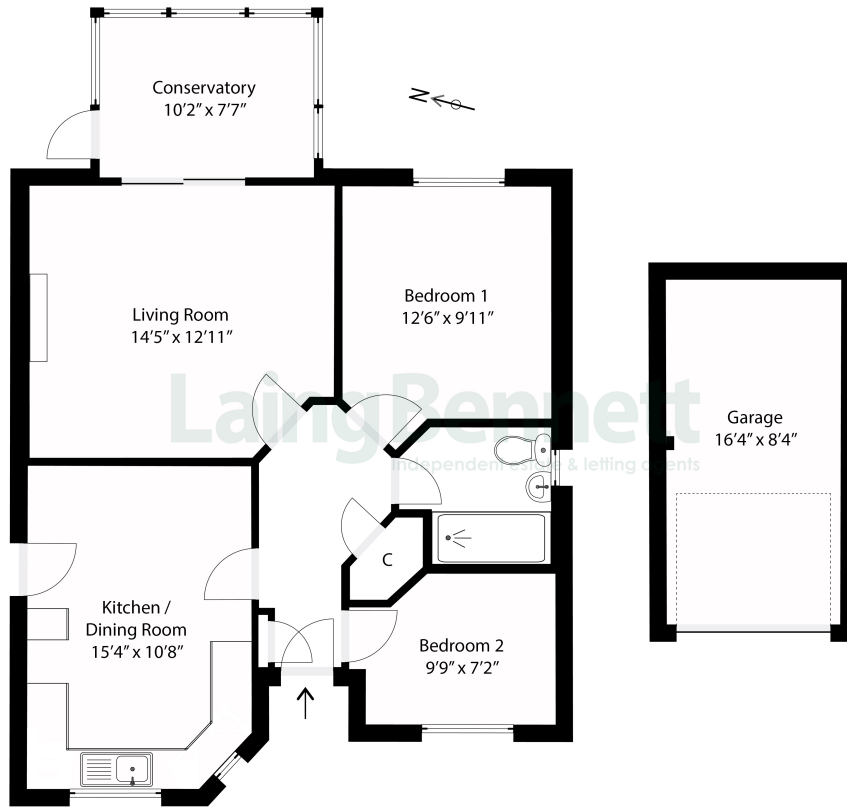

Illustration for identification purposes only. Measurements are approximate. Dimensions given are between the widest points. Not to scale. Outbuildings are not shown in actual location.



Need to book a viewing?

If you would like to book a viewing please contact our office on 01303 863393 or email [sales@laingbennett.co.uk](mailto:sales@laingbennett.co.uk)

See all our properties at



[www.laingbennett.co.uk](http://www.laingbennett.co.uk)

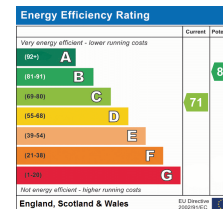

The Estate Office  
 8 Station Road  
 Lyminge  
 Folkestone  
 Kent  
 CT18 8HP



These property details are intended to give a fair description and give guidance to prospective Purchaser/Tenant. They do not constitute an offer or contract of Sale/Tenancy and all measurements are approximate. While every care has been taken in the preparation of these details neither Laing Bennett Ltd nor the Vendor/ Landlord accept any liability for any statement contained herein. Laing Bennett Ltd has not tested any services, appliances, equipment or facilities, and nothing in these details should be deemed to be a statement that they are in good working order or that the property is in good structural condition or otherwise. We advise all applicants to commission the appropriate investigations before Exchange of Contracts/entering into a Tenancy Agreement. It should not be assumed that any contents/furnishing, furniture etc. photographed are included in the Sale/Tenancy, nor that the property remains as displayed in the photographs. No person in the employment of Laing Bennett Ltd has authority to make or give any representation or warranty whatever in relation to this property.