



131 Grosvenor Road, Staines-upon-Thames, Surrey. TW18 2RP.
4 Bedroom Detached House - £950,000 Freehold

131 Grosvenor Road, Staines-upon-Thames, Surrey. TW18 2RP.

01784 451458

4 Bedroom Detached House - £950,000 Freehold

VERY WELL PRESENTED & SPACIOUS FOUR BEDROOM DETACHED PROPERTY SITUATED IN THIS MUCH SOUGHT AFTER ROAD IDEALLY POSITIONED FOR EASY ACCESS TO STAINES TOWN CENTRE, LOCAL SHOPS & SCHOOLS. The property benefits from a spacious kitchen/diner/family room with separate utility, generous lounge, study, downstairs W.C, four double bedrooms (en-suite to bed 1), further modern white bathroom suite, large secluded rear garden with brick-built outbuilding, off-street parking and garage. Viewings Highly Recommended!

Key Features

MUCH SOUGHT AFTER ROAD
WELL PRESENTED THROUGHOUT
LUXURY KITCHEN/DINER/FAMILY ROOM
FOUR DOUBLE BEDROOMS
OFF-STREET PARKING & GARAGE

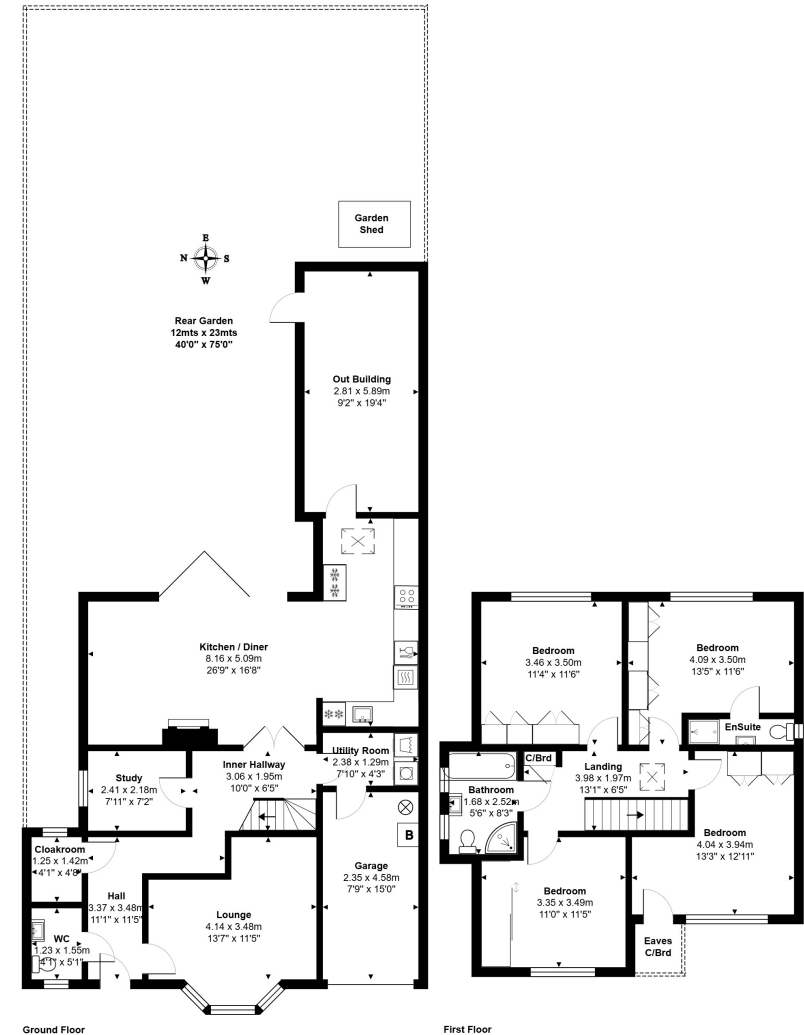

Ground Floor

First Floor

Total Area: 168.7 m² ... 1816 ft²

All measurements are approximate and for display purposes only.



GREGORY BROWN
RESIDENTIAL SALES & LETTINGS





131 Grosvenor Road, Staines-upon-Thames, Surrey. TW18 2RP.

gregory-brown.co.uk

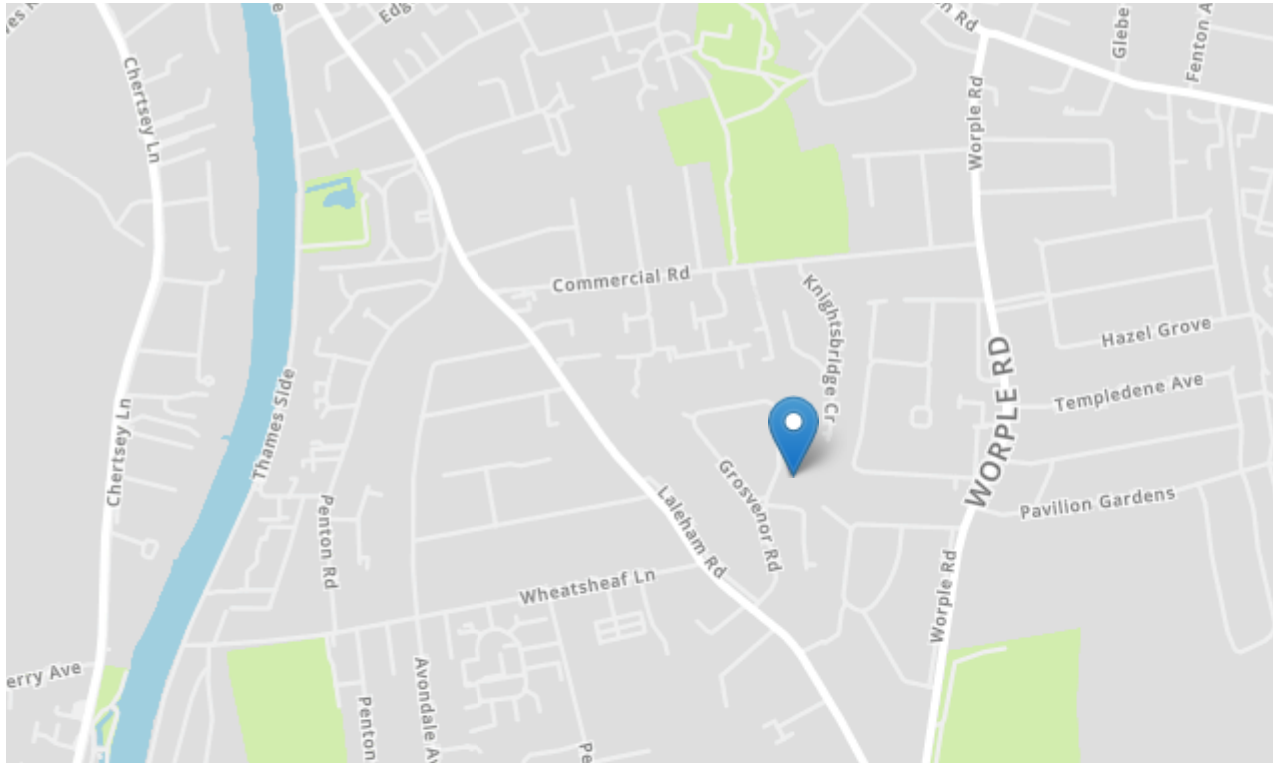

Tenure	Freehold
Lease Term	
Ground Rent	
Service Charge	
Local Authority	Spelthorne
Council Tax	per year (Band G)

We have prepared these property particulars as a general guide to a broad description of the property. They are not intended to constitute part of an offer or contract. We have not carried out a structural survey and the services, appliances and specific fittings have not been tested. All photographs, measurements, floorplans and distances referred to are given as a guide only and should not be relied upon for the purchase of carpets or any other fixtures or fittings. Lease details, service charges and ground rents (where applicable) and council tax are given as a guide only and should be checked and confirmed by your solicitor prior to exchange of contracts. The copyright of all details, photographs and floorplans remain exclusive to Gregory Brown.

