

414 Pacific Wharf, 165 Rotherhithe Street, London SE16 5QF

A smart two double bedroom, two bath/shower room apartment on the fourth floor of this popular development with spacious reception and balcony with views down the river. It boasts a concierge, secure off-street parking and is ideally located for Rotherhithe and Canada Water Stations.

A well-presented fourth floor apartment in this popular development which comprises a spacious open plan kitchen/reception with wooden floors that leads to a balcony with direct river views, master bedroom with en-suite shower rooms, second double bedroom, family bathroom and useful storage cupboard. It also benefits from a concierge, off-street parking and is located a short distance away from Rotherhithe and Canada Water Stations.

- Open Plan Kitchen/Reception
- Two Bath/Shower Rooms
- River Views
- Concierge
- Two Double Bedrooms
- Balcony
- Some Wooden Floors

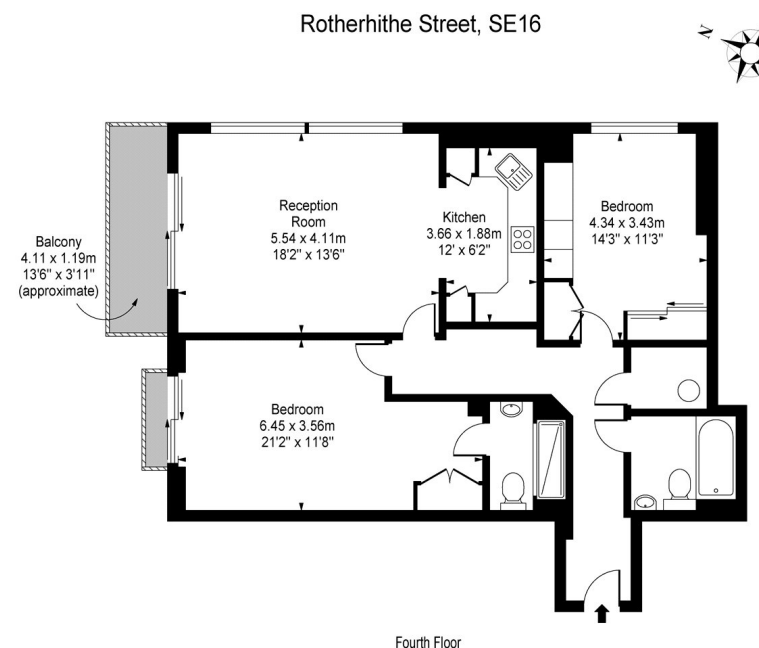

Approx Gross Internal Area 978 Sq Ft - 90.86 Sq M

This floor plan should be used as a general outline for guidance only and does not constitute in whole or in part an offer or contract. Any intending purchaser or lessee should satisfy themselves by inspection, searches, enquiries and full survey as to the correctness of each statement. Any areas, measurements or distances quoted are approximate and should not be used to value a property or be the basis of any sale or let.



