



ARUNDEL DRIVE, HARROW

£1,500 pcm

**** AVAILABLE IMMEDIATELY **** A newly refurbished one bedroom first floor flat with garden. The property briefly comprises living room, bedroom, bathroom and kitchen. Further benefits include double glazing and gas central heating and private rear garden.

- AVAILABLE IMMEDIATELY
- ONE BEDROOM FIRST FLOOR FLAT
- NEWLY REFURBISHED
- DOUBLE GLAZING
- GAS CENTRAL HEATING
- PRIVATE REAR GARDEN
- CONVENIENTLY LOCATED FOR SHOPS AND TRANSPORT LINKS

Ground Floor

Entrance

First Floor

Landing

Living Room

Kitchen

Bedroom

Bathroom

Outside

Rear Garden



DISCLAIMER: These particulars, whilst believed to be accurate are set out as a general outline only for guidance and do not constitute any part of an offer or contract. Intending purchasers should not rely on them as statements or representation of fact, but must satisfy themselves by inspection or otherwise as to their accuracy. We have not carried out a detailed survey nor tested the services, appliances and specific fittings. Room sizes should not be relied upon for carpets and furnishings. The measurements given are approximate. No person in this firms employment has the authority to make or give any representation or warranty in respect of the property.

FIRST FLOOR
418 sq.ft. (38.8 sq.m.) approx.

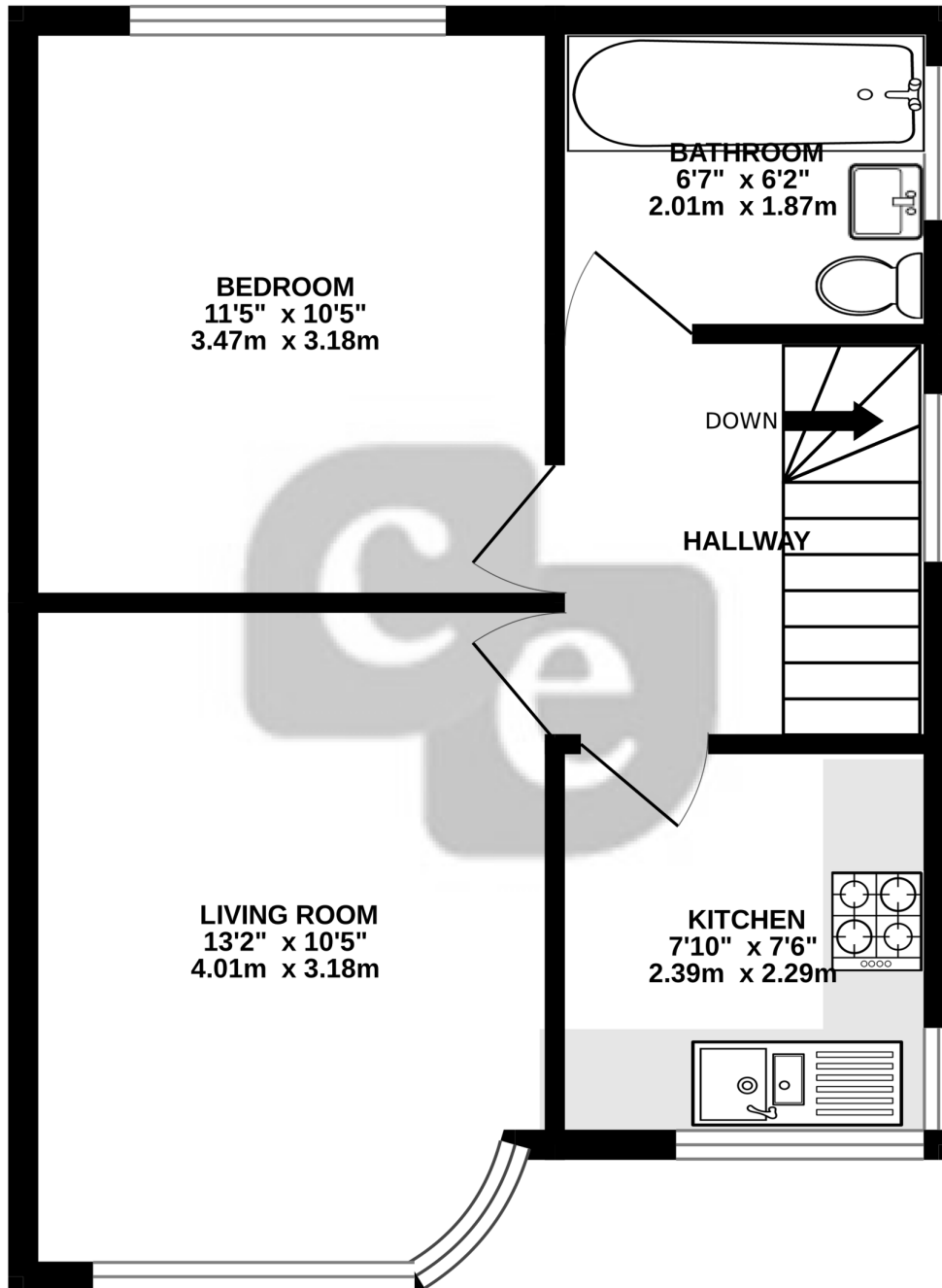

TOTAL FLOOR AREA : 418 sq.ft. (38.8 sq.m.) approx.

Whilst every attempt has been made to ensure the accuracy of the floorplan contained here, measurements of doors, windows, rooms and any other items are approximate and no responsibility is taken for any error, omission or mis-statement. This plan is for illustrative purposes only and should be used as such by any prospective purchaser. The services, systems and appliances shown have not been tested and no guarantee as to their operability or efficiency can be given.

Made with Metropix ©2024