



£210,000 Leasehold



Wickham Street, Welling



PROPERTY DESCRIPTION

RE/MAX SELECT are delighted to offer for sale this first floor apartment conveniently located for public transport, schools, and amenities. The property comprises one double bedroom, spacious lounge, kitchen, and bathroom. Further benefits include double glazing, gas central heating, and large communal garden. CHAIN FREE.

Total Internal Area approx: 467.69 sq ft (43.45 sq m). EPC Rating D57

FEATURES

- First floor apartment
- Large double bedroom
- Large living room
- Large shower room
- Double glazing & gas central heating





ROOM DESCRIPTIONS

FIRST FLOOR

Entrance Hall

Laminate flooring, radiator, entry-phone system.

Living Room

Laminate flooring, radiator, electric fireplace, double glazed windows.

Kitchen

Tiled flooring; range of wood wall and base units with marble-effect worktops and tiled splashback; stainless steel sink and drainer unit; fitted gas hob, fitted oven; fitted stainless steel extractor hood; space and connections for fridge/freezer; space and connections for washing machine; cupboard housing boiler; double glazed windows.

Bedroom

Laminate flooring, radiator, double glazed windows.

Bathroom

Ceramic tiled flooring; tiled walls; large shower enclosure with thermostatic shower; large wash-hand basin with vanity unit; w/c, extractor fan, heated towel rail, double glazed windows.

Information:

- Close to A2 / M25
- 0.7 miles (approx) to Bexleyheath Station (direct to 5 London Terminal stations)
- 1.8 miles (approx) to Abbey Wood Station with Crossrail/Elizabeth Line & Thameslink
- 1.1 miles (approx) to Danson Park and Lake
- 1.5 miles (approx) to Crook Log Leisure Centre and Swimming Pool
- 2.2 miles (approx) to Broadway Shopping Centre
- Lease: 102 years remaining
- Ground Rent: (£10.00) per annum
- Service Charge: (£1,922.04) per annum
- Council Tax: Band B



FLOORPLAN

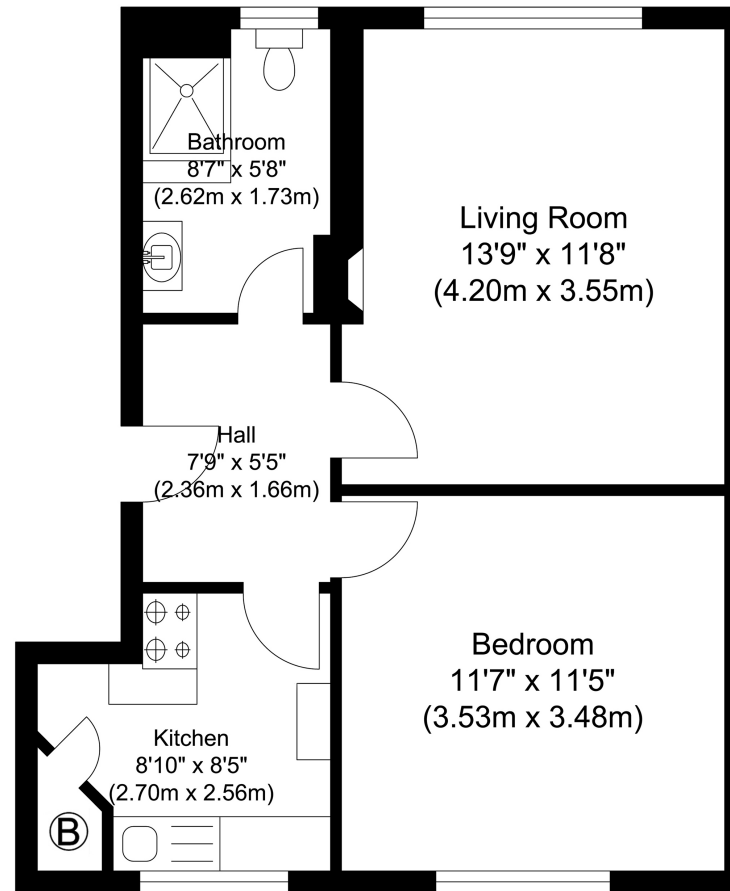

Approximate Floor Area
467.69 SQ.FT.
43.45 SQ.M.

TOTAL APPROX FLOOR AREA 467.69 SQ.FT. 43.45 SQ. M.

Whilst every attempt has been made to ensure the accuracy of the floor plan contained here, measurements of doors, windows, rooms and any other items are approximate and no responsibility is taken for any error, omission or misstatement. This plan is for illustrative purposes only and should be used as such by any prospective purchaser.
Red Hot Camera ©2016

