

# PHILIPPA SOLE

SALES, LETTING & SEARCH AGENT  
TRANSPARENT. BESPOKE. EFFECTIVE



FLAT 4, 1 BEACH CLOSE, BEACH ROAD,  
BRANKSOME PARK, POOLE, DORSET, BH13 7BS



£ 4 4 9 , 0 0 0

---

2 bedrooms

1 bathroom

Currently undergoing  
extensive refurbishment

First floor apartment

0.3 miles from Branksome  
Chine Beach

Terrace adjacent to the  
main bedroom

Visitor parking and  
private garage

Council band D: £1,877.17

£2,500 pa

Share of Freehold

## ABOUT THIS PROPERTY

A fantastic opportunity to acquire this completely refurbished 2 bedroom, 1 bathroom, first floor apartment, renovated to a superb specification, just 480 metres from Branksome Chine beach.

This apartment is set in the heart of Branksome Park. Comprising of two large double bedrooms and a family bathroom with a separate WC. The flat itself has just been extensively refurbished and comes to market with brand new fitted kitchen and bathroom with the rest of the apartment being renovated. The development itself is just moments away from Branksome Chine beach on foot but set in beautiful sylvan surroundings, allowing you to enjoy quiet peaceful evenings on the balcony. Outside, there is ample surface parking and a private garage.

## LOCATION

Located in a quiet road, yet just 0.3 miles from Branksome Chine beach, making it an ideal destination as a primary home or for second homeowners. The local train station at Branksome provides a direct line into London Waterloo in under two hours.

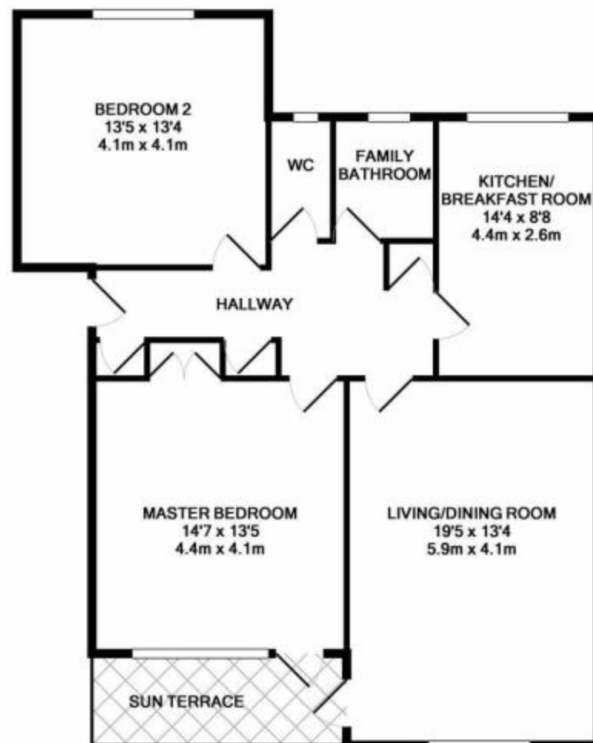

Whilst every attempt has been made to ensure the accuracy of the floor plan contained here, measurements of doors, windows, rooms and any other items are approximate and no responsibility is taken for any error, omission, or mis-statement. This plan is for illustrative purposes only and should be used as such by any prospective purchaser. The services, systems and appliances shown have not been tested and no guarantee as to their operability or efficiency can be given.  
Made with Metropix ©2017

M: 07709111797 | O: 01202 747999

PHILIPPA SOLE GROUND FLOOR, 3A SPRINGFIELD ROAD, BH14 0LG  
ENQUIRIES@PHILIPPASOLE.CO.UK | WWW.PHILIPPASOLE.CO.UK

REGISTERED OFFICE: 21 CHURCH ROAD, PARKSTONE, POOLE, DORSET, BH14 8UF COMPANY REGISTRATION NUMBER: 10389562. REGISTERED IN ENGLAND AND WALES.  
VAT NUMBER: 289886706