

Flat 3 Lonsdale Court 42 Salisbury Road

Dover
CT16 1EY

£180,000 SHARE OF FREEHOLD

DRAFT DETAILS... FOR SALE WITH BURNAP + ABEL... ***GUIDE PRICE £180,000-£190,000 *** A two bedroom ground floor apartment WITH GARAGE within close proximity to both Town Centre, access to travel and the beautiful Connaught Park.

The property has a spacious lounge/dining room, separate kitchen fitted with wall and base units, integrated cooker, hob and extractor fan with space for washing machine and fridge/freezer.

The master bedroom is a good size with fitted carpet. The second bedroom is a good sized single/small double. Perfect for a guest room or home office.

A shower room with WC, hand basin and walk in shower. Tile surround and vinyl flooring.

If you are interested in taking a look at the property, please contact Burnap + Abel on 01304279107.



Lounge/Dining Room

3.77m x 4.58m (12' 4" x 15' 0")

Kitchen

1.85m x 2.87m (6' 1" x 9' 5")

Bedroom 1

3.17m x 3.77m (10' 5" x 12' 4")

Bedroom 2

2.53m x 2.83m (8' 4" x 9' 3")

Shower Room

1.85m x 2.24m (6' 1" x 7' 4")

Garage

2.65m x 6.51m (8' 8" x 21' 4")

Lease Information

We understand from the vendor that the property comes with a Share of Freehold (1/9th).

We understand from the vendor that the Lease was 125 years from 2014 (114 years remaining).

We understand from the vendor that there is no ground rent payable.

We understand from the vendor that the service charges are approximately £380 per annum

Ground Floor

Approx. 52.6 sq. metres (566.2 sq. feet)

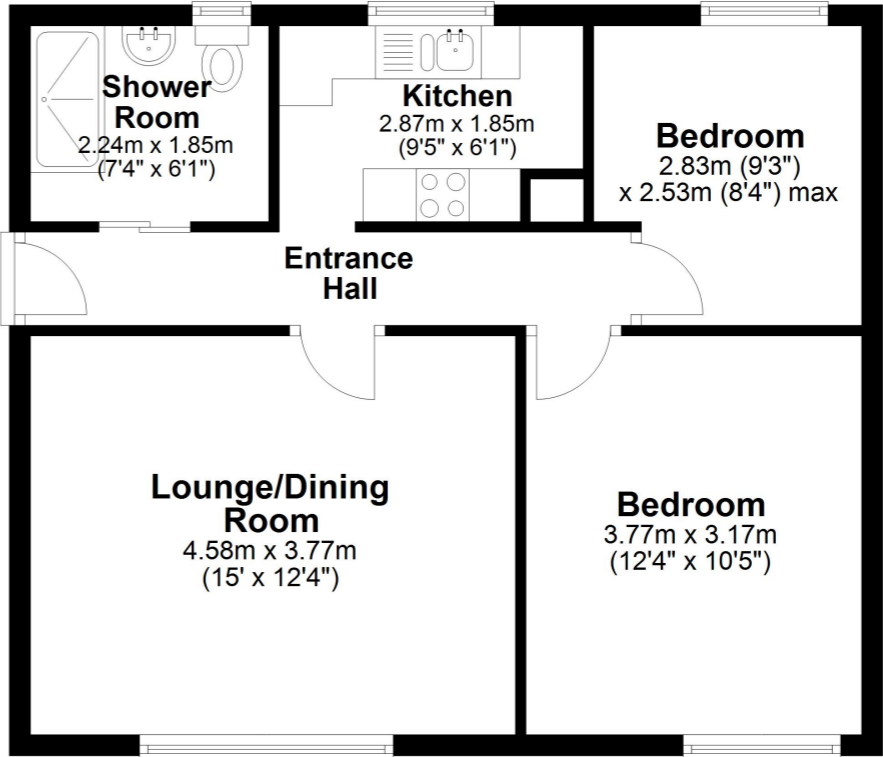

Outbuilding

Approx. 17.3 sq. metres (185.7 sq. feet)

