



Hessle
East Riding of Yorkshire
HU13 9HZ

Offers in Excess of £180,000

bettermove

Gisburn Road

Hessle

Bettermove are proud to present this 3 bedroom semi detached house in Hessle, East Riding Of Yorkshire. This property is available with no forward chain.

The property benefits from double glazing, gas central heating throughout, a combi boiler which was installed in 2023 and has off street parking available via a driveway.

The council tax band is B; This is a freehold property.

The interior of this beautifully presented property comprises a spacious living room, dining room and fitted kitchen on the ground floor. The first floor consists of 3 bedrooms and the family bathroom.

The exterior boasts a private garden, perfect for enjoying the summer months. Located in the popular town of Hessle, the property is close to a range of amenities, including shops, supermarkets, restaurants and pubs.

Excellent transport connections can be found from the A63, the Humber Bridge, various local bus routes and Hessle train station.



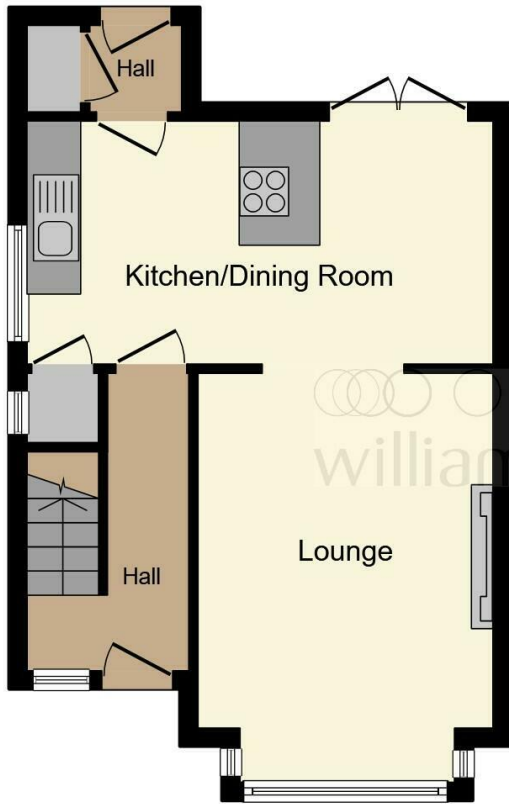

Ground Floor



First Floor

This floorplan is for illustrative purposes only and is not drawn to scale. Measurements, floor-areas, openings and orientations are approximate. They should not be relied upon for any purpose and do not form any part of an agreement. No liability is taken for any error or mis-statement. All parties must rely on their own inspections.

Energy Efficiency Rating		Current	Potential
<i>Very energy efficient - lower running costs</i>			
(92+)	A		
(81-91)	B		86
(69-80)	C		
(55-68)	D	67	
(39-54)	E		
(21-38)	F		
(1-20)	G		
<i>Not energy efficient - higher running costs</i>			
England, Scotland & Wales		EU Directive 2002/91/EC 	



20-22 Bridge End, Leeds, LS1 4DJ
t: 0330 004 0050 e: hello@bettermove.co.uk
www.bettermove.co.uk