



THE ESTATE AGENTS
1977



Roseholme Road, Northampton NN1 4RS
Offers Over £100,000 - Leasehold



PROPERTY DESCRIPTION

The Estate Agents are pleased to present a rare opportunity to purchase this lovely two bedroom ground floor over 55's apartment in the highly sought Burlington Court complex in central Northampton, close to Abington Park. Exclusively for over 55's, this property offers the perfect place for those seeking tranquillity and comfort, while being surrounded by like-minded neighbours. The apartment briefly comprises; a spacious entrance hall with plenty of storage, an open plan living room and beautifully fitted kitchen, two bedrooms and large four piece bathroom suite. Residents will have the pleasure of relaxing in the beautifully landscaped communal gardens, enjoying the outdoors without the hassle of maintenance.

The property also boasts secure residents parking, communal rooms, a function room and additional bedrooms to hire for when relatives stay.

Additionally, the convenient location of this apartment provides easy access to nearby amenities, including shops, restaurants, public transportation links and Abington Park.

POINTS OF INTEREST

- Two Bedroom Ground Floor Apartment
- Over 55's
- Allocated Parking Space
- Beautiful Fitted Kitchen
- Fitted Wardrobes In Bedroom One
- Garden View
- Communal Areas And Function Room
- Close To Abington Park
- No Upward Chain

GROUND FLOOR
573 sq.ft. (53.2 sq.m.) approx.

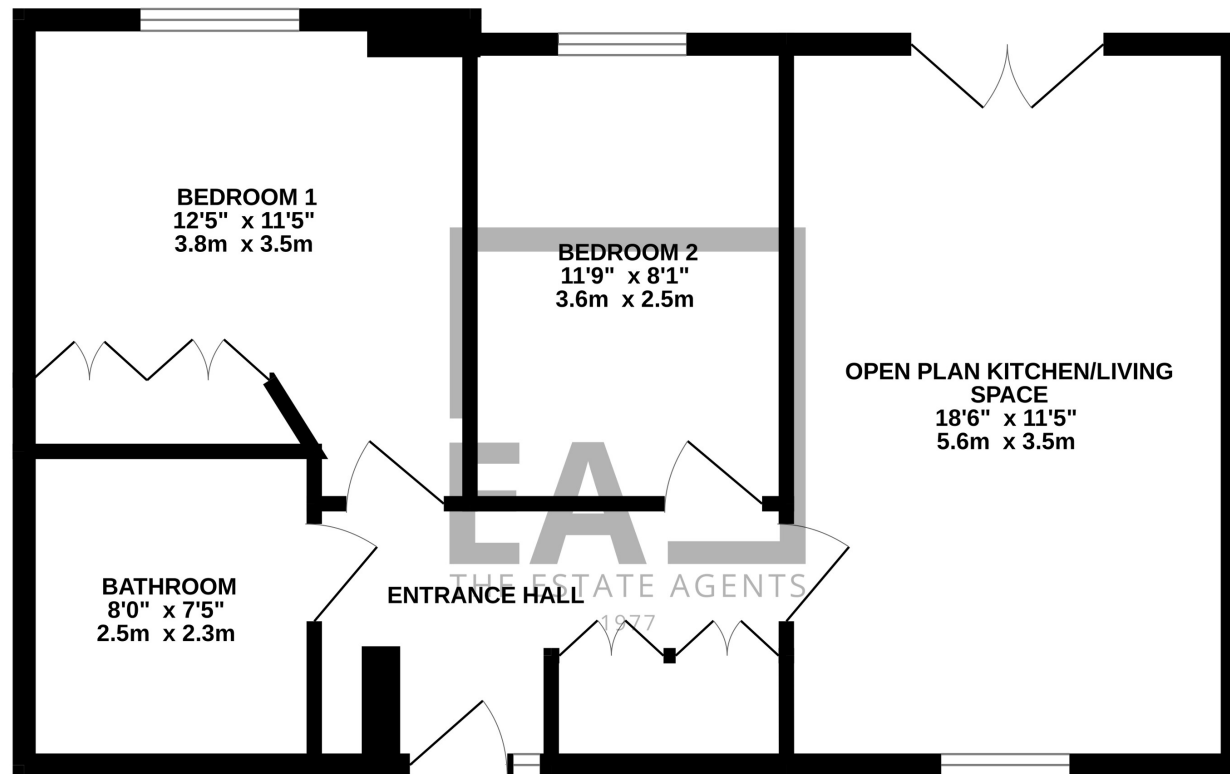

TOTAL FLOOR AREA : 573 sq.ft. (53.2 sq.m.) approx.

Whilst every attempt has been made to ensure the accuracy of the floorplan contained here, measurements of doors, windows, rooms and any other items are approximate and no responsibility is taken for any error, omission or mis-statement. This plan is for illustrative purposes only and should be used as such by any prospective purchaser. The services, systems and appliances shown have not been tested and no guarantee as to their operability or efficiency can be given.
Made with Metropix ©2025