



- One Bedroom Apartment
- Shared Ownership - 40% Share
- Town Centre Position
- Option to Staircase to Full 100% Ownership
- 121 Years Remaining On Lease
- Undercroft Gated Parking
- Balcony
- 31' Kitchen/Living/Dining Space
- £291 Monthly Rent (For Other 60% Share) / £79 Monthly Service Charge / £0 Ground Rent

## 6 Saunders House, Manor Street, Braintree, Essex. CM7 3BD.

Michaels Property Consultants are delighted to offer this rare opportunity to acquire a recently built and beautifully finished one-bedroom apartment, available for sale on a 40% shared ownership basis, with the option to staircase up to 100% ownership.

Occupying a fabulous town-centre location and within short walking distance of the mainline railway station, this stylish and contemporary apartment represents an ideal purchase for buyers with a limited deposit.





# Property Details.

## Accommodation

Door To;

Entrance Hall (Two Storage Cupboards & Utility Cupboard)



Kitchen/Dining Living Space



31' 5" x 10' 7" (9.58m x 3.23m)

## Balcony



8' 0" x 5' 9" (2.44m x 1.75m)

## Bedroom



14' 7" x 9' 0" (4.45m x 2.74m)

## Bathroom



# Property Details.

## Outside

Under-Cover Allocated Parking Space (Accessed Via Electric Gates)

# Property Details.

## Floorplans

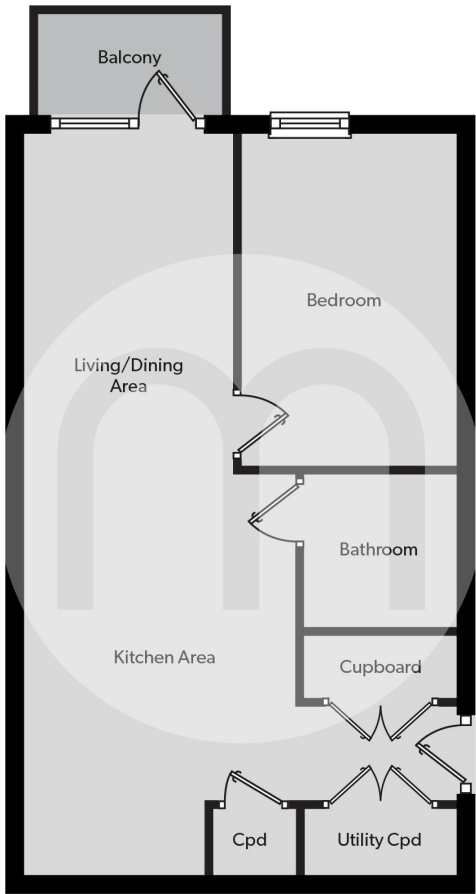

## Location

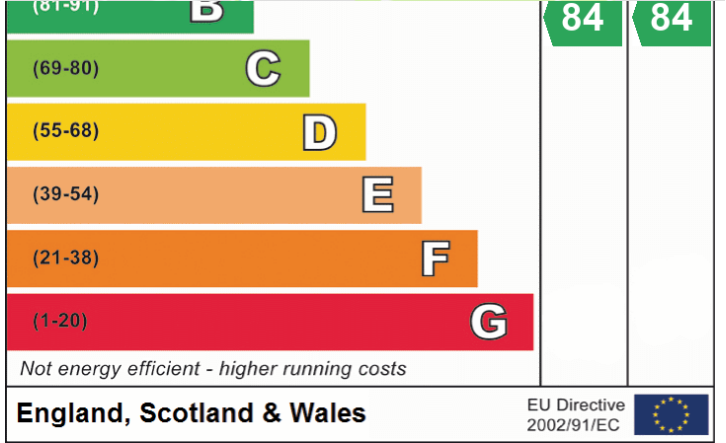

We have not carried out a structural survey and the services, appliances and specific fittings have not been tested. All photographs, measurements, floor plans and distances referred to are given as a guide only and should not be relied upon for the purchase of carpets or any other fixtures or fittings. Gardens, roof terraces, balconies and communal gardens as well as tenure and lease details cannot have their accuracy guaranteed for intending purchasers. Lease details, service ground rent (where applicable) are given as a guide only and should be checked and confirmed by your solicitor prior to exchange of contracts.