

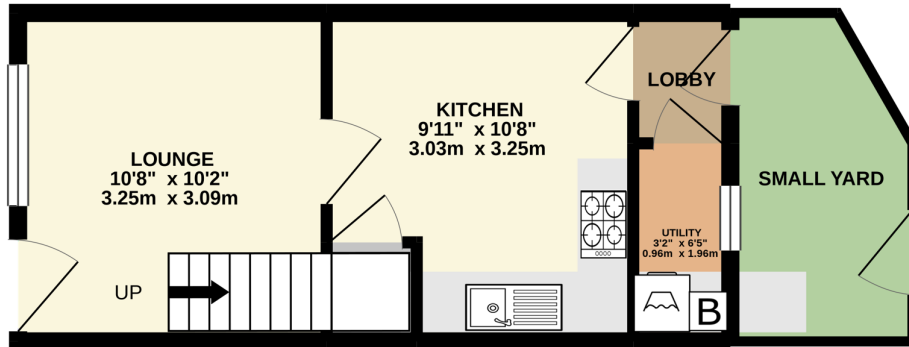

63 Cambridge Road, Hastings, East Sussex, TN34 1EP
Two Bedroom Cottage For Sale In Hastings Town Centre £190,000

GROUND FLOOR
246 sq.ft. (22.9 sq.m.) approx.



1ST FLOOR
211 sq.ft. (19.6 sq.m.) approx.

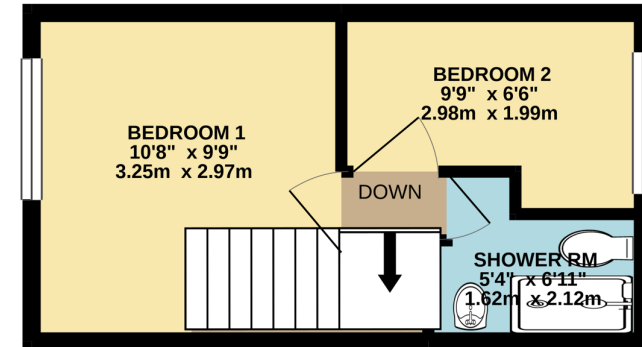

TOTAL FLOOR AREA : 458 sq.ft. (42.5 sq.m.) approx.

Whilst every attempt has been made to ensure the accuracy of the floorplan contained here, measurements of doors, windows, rooms and any other items are approximate and no responsibility is taken for any error, omission or mis-statement. This plan is for illustrative purposes only and should be used as such by any prospective purchaser. The services, systems and appliances shown have not been tested and no guarantee as to their operability or efficiency can be given.
Made with Metropix ©2020

Guide Price £190,000 - £205,000 ** Property Cafe are delighted to offer for sale, this conveniently positioned mid terraced two bedroom cottage style house. The property is presented in neutral colour schemes throughout and is a fantastic opportunity for a first time buyer or investment purchaser with benefits and accommodation including; A secure double glazed entrance door that leads directly into the neutrally decorated lounge with open plan stairwell, access to a fitted kitchen-diner offering a range of modern units, work surface space and room for a small breakfast table; Lobby area with access onto a handy utility room plumbed ready for a washing machine & housing the boiler. To the rear of the property there is small enclosed courtyard garden with rear pedestrian access. On the first floor there is good size main bedroom with 2nd single bedroom, and a shower room comprising of walk in shower cubicle, wash basin & WC. The property is situated close to Hastings town centre & whilst there is no immediate off road parking the property offers easy access to the town, shopping centre, seafront promenade and mainline station. Additional details are available upon request and internal viewings are highly recommended.



Cambridge Road is situated in a very convenient position of Hastings benefitting from a town centre location only being a short walk to Hastings town centre, seafront and transport links including; Regular local bus services and Hastings mainline train station offering regular services to London, Brighton and Eastbourne. Hastings town offers an abundance of supermarkets, local shops, dentists & doctors surgeries in addition to its attractive parks, promenade and Historic old town.

- Guide Price £190,000 - £205,000
 - Ideal First Home or Investment
 - Two bedroom terraced house.
 - Fitted Kitchen & Bathroom
 - Small Enclosed Rear Courtyard Garden
 - Close To Town Centre & Station
- Two well proportioned bedrooms.
 - Boiler Room & Additional Storage
 - Gas Central Heating & Double Glazed
 - Sold With No Onward Chain.
 - Viewing Highly Recommended