



- Four Bedroom Property
- High Ceilings & Period Features Throughout
- Two Garages & Off Road Parking
- Sought After London Road Position
- Complete Onward Chain
- Large Rear Garden
- Basement
- Huge Potential To Improve
- Double Glazed Windows
- Two Reception Rooms & Conservatory

28 London Road, Braintree, Essex. CM7 2LG.

Michaels Property Consultants are delighted to present to the market this well established and deceptively spacious four bedroom Victorian residence occupying an elevated position on the ever sought after London Road, South of the Braintree town centre. New to the market and offered for sale with a complete onward chain, this handsome semi detached property offers spacious accommodation arranged over three floors, lending itself well to a buyer seeking a versatile family home they can really make their own.



Property Details.

Entrance Hall



Lounge



15' 6" x 11' 3" (4.72m x 3.43m)

Dining Room



13' 6" x 10' 8" (4.11m x 3.25m)

Kitchen/Diner



24' 3" (Max) x 9' 6" (7.39m x 2.90m)

Pantry

Inner Lobby

Cloakroom

Conservatory

10' 3" x 9' 7" (3.12m x 2.92m)

Basement

15' 8" x 15' 6" (4.78m x 4.72m)

First Floor Landing

Bedroom One



16' 0" x 15' 6" (4.88m x 4.72m)

Bedroom Two

13' 9" x 10' 7" (4.19m x 3.23m)

Property Details.

Bedroom Three



15' 4" x 9' 7" (4.67m x 2.92m)

Bathroom

Second Floor Landing

Bedroom Four

12' 8" x 9' 2" (3.86m x 2.79m)

Rear Garden



Two Garages & Driveway Parking

Property Details.

Floorplans

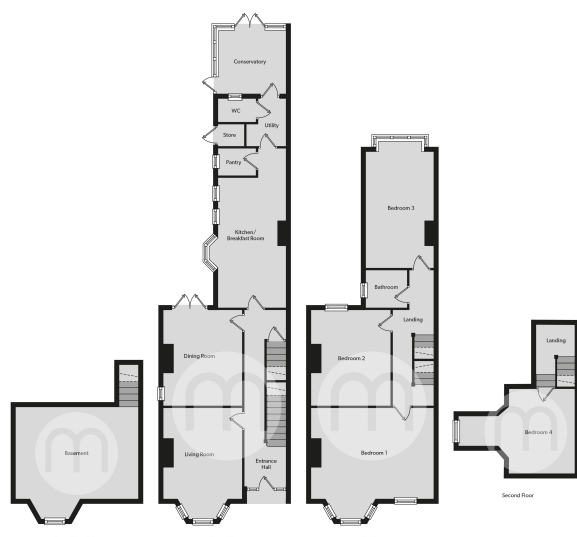

Location

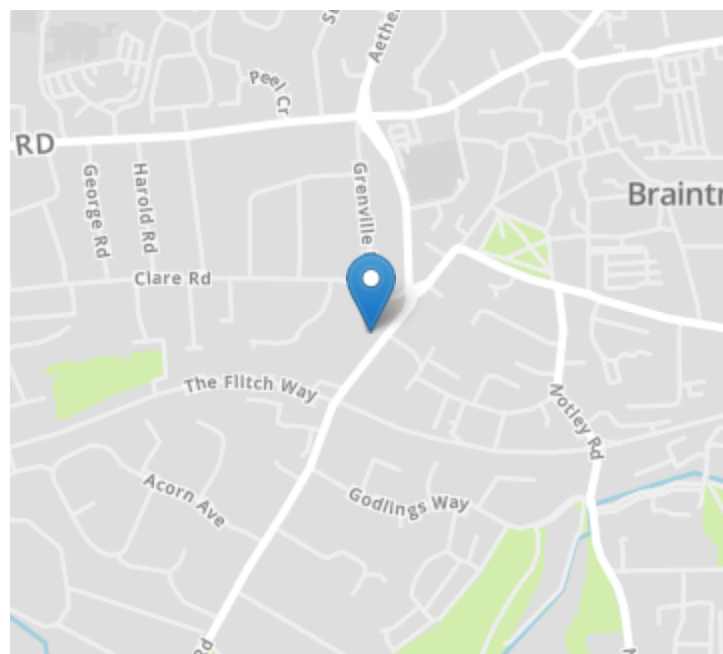

Energy Ratings

We have not carried out a structural survey and the services, appliances and specific fittings have not been tested. All photographs, measurements, floor plans and distances referred to are given as a guide only and should not be relied upon for the purchase of carpets or any other fixtures or fittings. Gardens, roof terraces, balconies and communal gardens as well as tenure and lease details cannot have their accuracy guaranteed for intending purchasers. Lease details, service ground rent (where applicable) are given as a guide only and should be checked and confirmed by your solicitor prior to exchange of contracts.