

87 Bridport Close, Lower Earley, Reading, Berkshire  
. RG6 3DG.

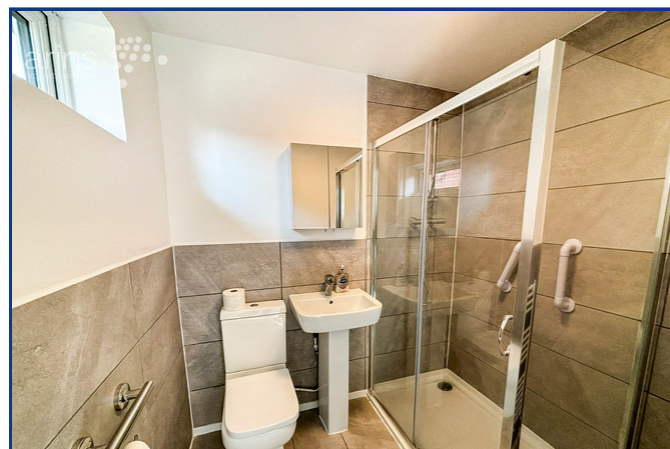

3 Maiden Lane Centre  
Berkshire  
Reading RG6 3HD  
Tel: 0118 926 8260  
www.arins.co.uk



87 Bridport Close, Lower Earley, Reading,  
Berkshire. RG6 3DG.

£1,550 pcm

Offered unfurnished and available now, being situated in a cul-de-sac adjacent to a green, is this beautifully presented detached bungalow which has been recently refurbished. The property enjoys a prime location within walking distance of the Maiden Lane Centre, which offers a variety of shops and amenities. The ASDA superstore complex is just a 20-minute stroll away, with the district centre nearby providing additional retail options such as M&S, Iceland, and an array of eateries. For leisure, the Loddon Valley Leisure Centre, complete with a 25-metre swimming pool, is conveniently close, along with a doctor's surgery and excellent bus routes providing direct access to Reading town centre. The accommodation includes an entrance hall, two generously sized double bedrooms, a modern refitted shower room, a spacious lounge/dining room, and an upgraded kitchen with appliances. Additional features include a nearby garage with ample driveway parking, gas central radiator heating, newly installed double glazing, and a private enclosed rear garden.

- Detached bungalow in a quiet cul-de-sac adjacent to a green
- Spacious living room
- Dining Area
- Upgraded Kitchen with Appliances
- Modern refitted shower room
- Two spacious double bedrooms
- Ample driveway parking and a garage
- Private enclosed rear garden
- Walking distance to local shops and amenities
- Offered Unfurnished and Available Now

These particulars, whilst believed to be accurate are set out as a general outline only for guidance and do not constitute any part of an offer or contract. Intending purchasers should not rely on them as statements or representation of fact, but must satisfy themselves by inspection or otherwise as to their accuracy. We have not carried out a detailed survey nor tested the services, appliances and specific fittings. Room sizes should not be relied upon for carpets and furnishings. The measurements given are approximate. No person in this firm's employment has the authority to make or give any representation or warranty in respect of the property.



Covering Reading, Earley, Lower Earley, Tilehurst, Woodley, Shinfield, Caversham and all other surrounding areas

87 Bridport Close, Lower Earley, Reading, Berkshire  
 . RG6 3DG.



Have you visited our website for our latest property listings?  
[www.arins.co.uk](http://www.arins.co.uk)



GROUND FLOOR

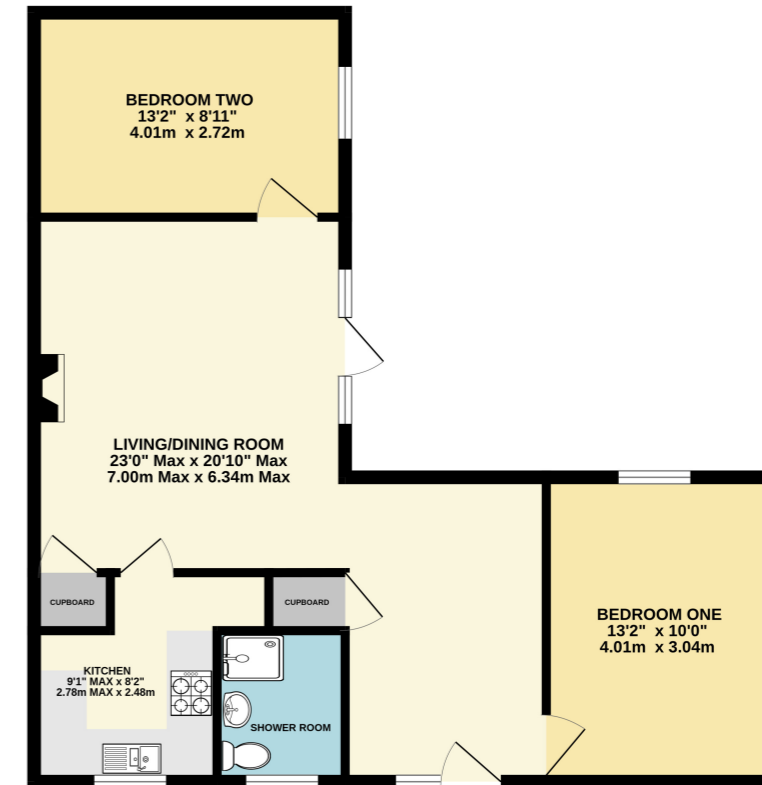

Whilst every attempt has been made to ensure the accuracy of the floorplans contained here, measurements of doors, windows, rooms and any other items are approximate and no responsibility is taken for any error, omission or mis-statement. This plan is for illustrative purposes only and should be used as such by any prospective purchaser. The services, systems and appliances shown have not been tested and no guarantee as to their operability or efficiency can be given.

**Property Description**

**Ground Floor**

**Entrance Hall**

**Lounge/Dining Room**

7m x 6.34m (23' 0" x 20' 10")

**Kitchen**

2.78m x 2.48m (9' 1" x 8' 2")

**Bedroom One**

4.01m x 3.04m (13' 2" x 10' 0")

**Bedroom Two**

4.01m x 2.72m (13' 2" x 8' 11")

**Shower Room**

**Outside**

**Front Garden**

**Garage & Driveway**

**Pleasant Rear Garden**

**Council Tax Band**

D

