



## Regent Square, London, WC1H

£2,175 pcm

- One Bedroom Apartment
- Additional Storage
- Furnished
- Available Now
- Plenty Of Natural Light
- Top Floor
- Moments Away From St. Pancras & Kings Cross Station

## Regent Square, WC1

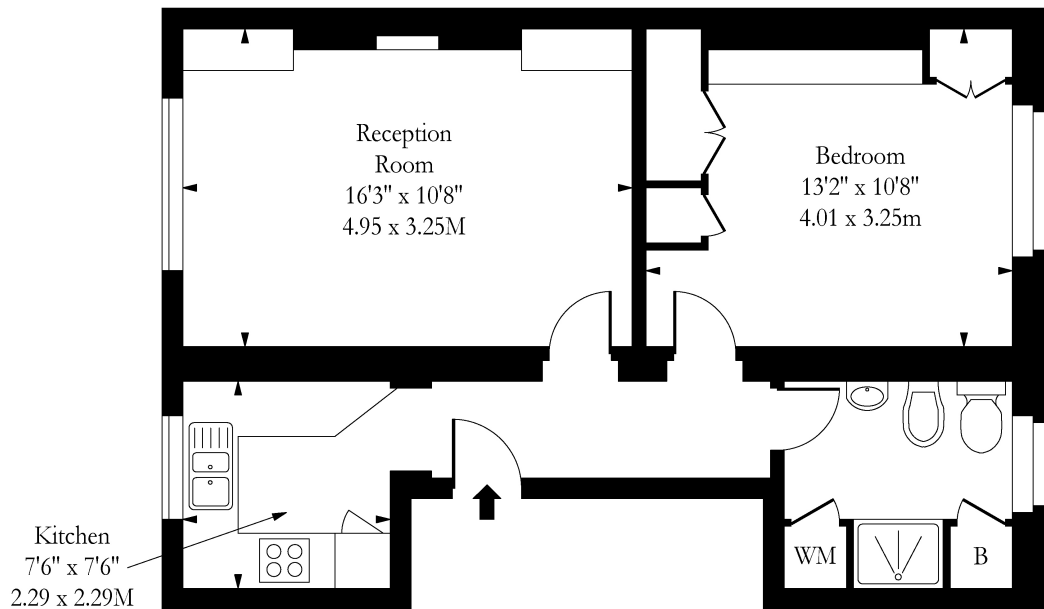
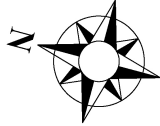

Third Floor

Approx Gross Internal Area 538 Sq Ft - 49.98 Sq M

Measured in accordance with RICS guidelines. Every attempt is made to ensure accuracy  
However all measurements are approximate.

The floor plan is illustrative purposes only and is not to scale

[www.tomekphotography.co.uk](http://www.tomekphotography.co.uk)

