



Newtown

01684 293246



8 Springfield, Newtown, Tewkesbury, GL20 8EX

Located within a quiet cul du sac on the edge of the town centre, this is an immaculately presented home that you could just move straight into.

From the moment you enter the welcoming hallway you will gain a sense of the love and care that has been bestowed on this home by the current owners.

The attractive lounge opens up into the modern kitchen which is fitted with a range of contemporary styled wall and base units and large walk in storage cupboard. There is a central island with seating area and the kitchen benefits from an integrated electric oven, electric multi-oven incorporating a microwave, 5 ring induction hob, extractor, dishwasher and washing machine.

The kitchen is filled with light from the double patio doors which open out into the garden.

On the first floor there are two double bedrooms and a modern shower room. Originally built as three bedroom home, it can readily convert back to 3 bedrooms if required, but presents currently as two spacious double bedrooms.

The shower room again is fitted with a contemporary style with a walk-in shower, vanity unit with inset wash basin and low level wc.



The property has the benefit of gas central heating, Economy 7 electric supply and upvc double glazed windows and doors.

Outside the sunny aspect rear garden is designed with low maintenance in mind and laid with attractive porcelain slabs and complementary gravel borders.

There is gated side access to the driveway which provides ample parking for several vehicles and access to the detached garage. The garage has the benefit of power.

Located in the popular Newtown area on the edge of the Town within easy access to Tewkesbury's wealth of amenities and in particular walking distance to local schools.

Tewkesbury is an excellent commuter base with the motorway and rail networks close by. It enjoys a wide range of sport, culture, education and health facilities and is a popular tourist centre.



Ground Floor

Lounge 15'6"x10'8" (max)
Kitchen/dining room 13'10"x11'9"

First Floor

Bedroom 1 13'9"x11'10"
Bedroom 2 10'11"x9'1"
Shower room 7'4"x6'

Outside

Garden Shed

Tewkesbury Borough Council Tax Band C

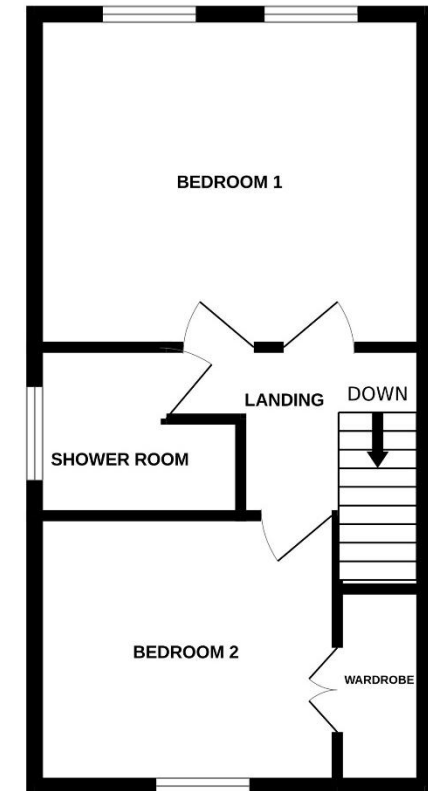
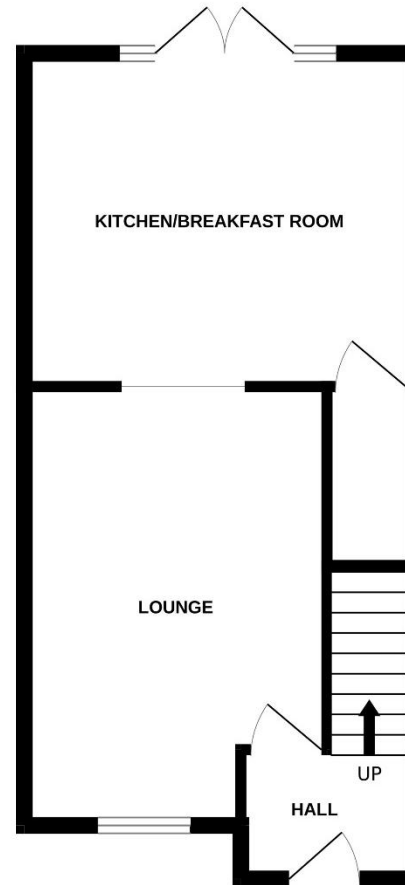
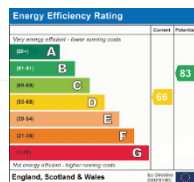

This floorplan is provided for guidance only as an approximate layout of the property and should not be relied upon as a statement of fact.



Offers over £285,000 Freehold

Viewing strictly by arrangement with Engall Castle Ltd
155 High Street Tewkesbury Gloucestershire GL20 5JP
Office hours: Mon – Fri 9am to 5.30pm, Sat 9am to 2pm
email: sales@engallcastle.com

01684 293 246
www.engallcastle.com



Agents Note

These property details are set out as a general outline only and do not constitute any part of an Offer or Contract. Any services equipment, fittings or central heating systems have not been tested and no warranty is given or implied by Engall Castle Ltd that these are in working order. Buyers are advised to obtain verification from their solicitor or surveyor. Fixtures and fittings or other items are not included unless specifically described. All measurements, distances and areas are approximate and for guidance only and should not be relied upon for the purposes of fitting carpets or furniture etc. These property details and all statements within this document are provided without responsibility on behalf of Engall Castle Ltd or its employees or representatives and should not be relied on as statements of fact. Prospective purchasers must satisfy themselves as to the accuracy of all details pertaining to the property.

