

BRIDGE STREET

£199,950



Key Features

- ✓ A well maintained terraced house.
- ✓ Two Double Bedrooms.
- ✓ Large Garden.
- ✓ Potential for off road parking (stpp)



GROUND FLOOR
316 sq ft. (29.3 sq.m.) approx.

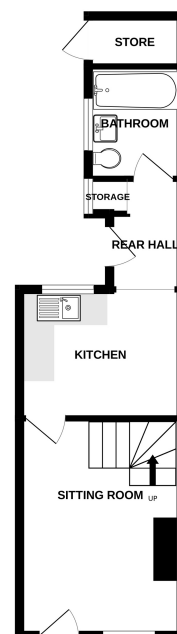

1ST FLOOR
270 sq ft. (25.1 sq.m.) approx.

