

Mayhew Road, Rendlesham, Woodbridge



- DESIRABLE VILLAGE LOCATION
- FOUR BEDROOMS
- TWO GARAGES
- DETACHED TOWN HOUSE
- TWO EN SUITES
- FIRST FLOOR SITTING ROOM & FURTHER GROUND FLOOR RECEPTION ROOM

MARKS & MANN



Mayhew Road, Rendlesham, Woodbridge

Offered for sale with NO ONWARD CHAIN is this FOUR BEDROOM DETACHED town house situated in a cul-de-sac within the village of Rendlesham. The property is set over three floors and would make an ideal family home. Located within walking distance of the local primary school and shop.

The village of Rendlesham is located approximately 5 miles from Woodbridge town centre. Among its many amenities are a well-regarded primary school, a Nursery, a Shop, a Community centre, a Dentist, a Doctor's Surgery, and Two parks, and a strong sense of community. Mayhew Road is located off Sycamore Drive.

£280,000

MARKS & MANN

7 The Square, Martlesham Heath, Ipswich, Suffolk, IP5 3SL.

01473 396 007

contactipswich@marksandmann.co.uk

Website www.marksandmann.co.uk

Mayhew Road, Rendlesham, Woodbridge

Mayhew Road, Rendlesham, Woodbridge

Entrance Hall

Door to front aspect, radiator, under stairs cupboard, stairs to first floor, lino flooring, coved ceiling.

Cloakroom

Double glazed window to side aspect, wash basin and W/C have been removed and this room is being used as a storage room.

Study

3.33m x 2.58m (10' 11" x 8' 6") Double glazed window to front aspect, radiator, coved ceiling.

Kitchen/Diner

5.09m x 3.46m (16' 8" x 11' 4") Window and french door to rear aspect, fitted kitchen with a range of wall and base mounted units, rolltop work surfaces half bowl sink/ drainer unit, integral electric oven with gas hob, cooker hood over, integrated washing machine, dishwasher and fridge / freezer, central heating boiler, inset spotlights, lino flooring.

First Floor Landing

Stairs from entrance hall, stairs to second floor landing, doors to:-

Lounge

5.11m x 3.45m Max (16' 9" x 11' 4" Max) Two double glazed windows, radiator, coved ceiling.

Bedroom One

3.15m x 2.91m (10' 4" x 9' 7") Double glazed window to front aspect, built in wardrobes, radiator, loft access, fitted carpet, coved ceiling.

En Suite

Skylight window to rear aspect, wash hand basin, low level WC, shower cubicle, heated towel rail.

Bedroom Two

3.34m x 2.55m (10' 11" x 8' 4") Double glazed window to front aspect, radiator, fitted carpet, coved ceiling.

Bathroom

Double glazed window to front aspect, suite comprising of; bath with mixer taps and shower attachment over, wash hand basin, low level WC, heated towel rail, coved ceiling.

Second Floor Landing

Stairs rising from first floor landing, doors to:-

Bedroom Three

3.86m x 2.36m (12' 8" x 7' 9") Double glazed window to front aspect, radiator, loft access, laminate flooring, coved ceiling.

Second Floor Bathroom

Part tiled, comprising of, wash hand basin, low level WC and shower cubicle with heated towel rail.

Bedroom Four

3.86m x 2.60m (12' 8" x 8' 6") Double glazed window to rear aspect, radiator, fitted carpet, coved ceiling.

Rear Garden

Laid to lawn, paved patio area, shed to remain with doors to front & rear, fenced surround, raised borders.

Double Tandem Type Garage

Up and over doors, eaves storage.

Disclaimer

In accordance with Consumer Protection from Unfair Trading Regulations, Marks and Mann Estate Agents have prepared these sales particulars as a general guide only. Reasonable endeavours have been made to ensure that the information given in these particulars is materially correct but any intending purchaser should satisfy themselves by inspection, searches, enquiries and survey as to the correctness of each statement. No statement in these particulars is to be relied upon as a statement or representation of fact. Any areas, measurements or distances are only approximate. New build properties - the developer may reserve the right to make any alterations up until exchange of contracts.

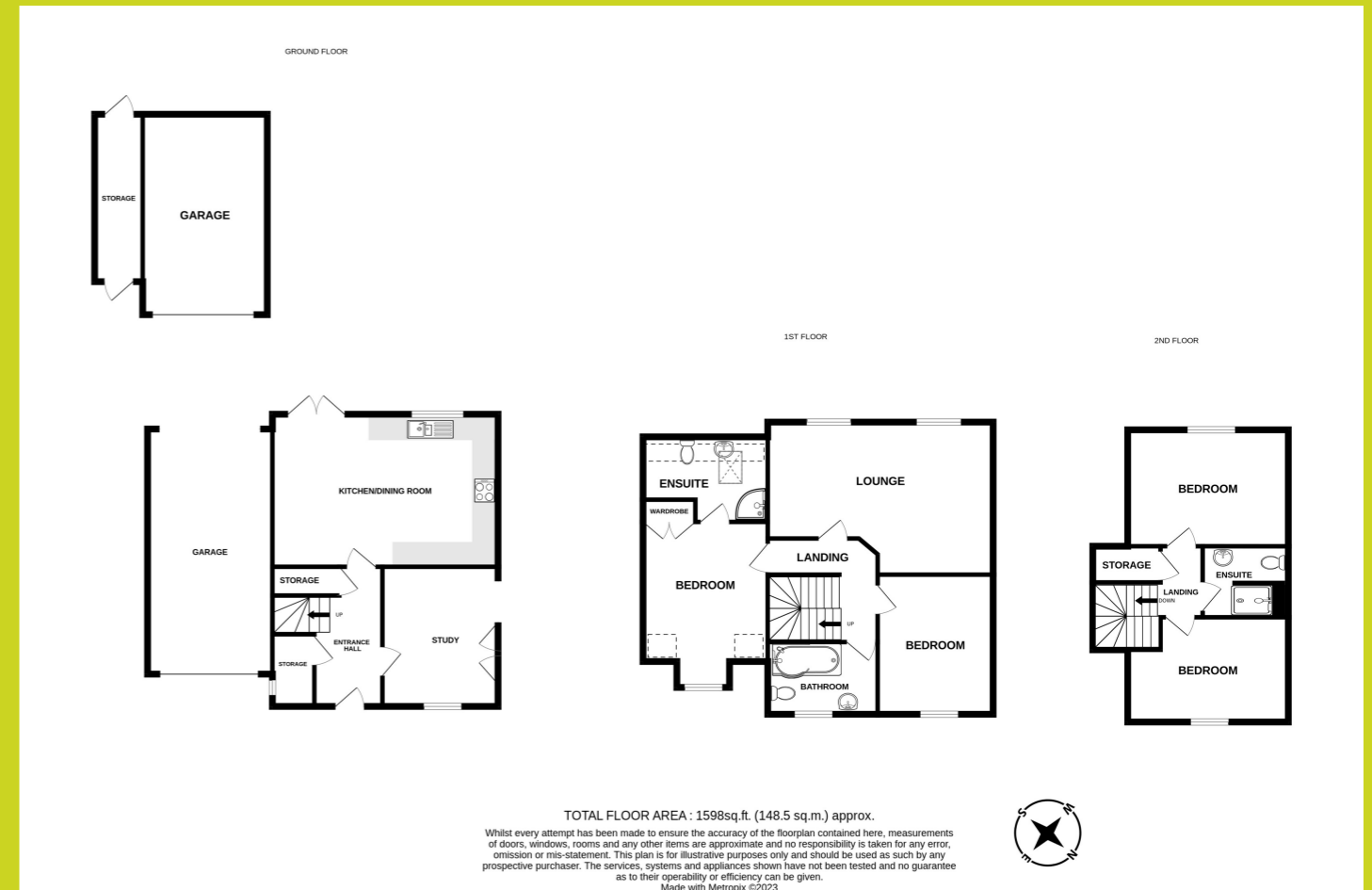

The above floor plans are not to scale and are shown for indication purposes only.