



Day & Co
ESTATE AGENTS

28 Cavendish Street
Keighley
BD21 3RG



13 John Street, Oakworth,
Keighley, West Yorkshire, BD22
7HD

£179,995

T: 01535 664609

W: www.dayandcoestateagents.co.uk

E: keighley@dayandcoestateagents.co.uk

- EPC Rating is D
 - Accommodation Over 4 Floors
 - Modern Fitted Kitchen & Newly Fitted Bathroom
- A Deceptively Spacious Through Terrace
 - Three Bedrooms
 - Popular Village Of Oakworth

SUMMARY

****A DECEPTIVELY SPACIOUS 3 BEDROOM THROUGH TERRACE, ACCOMMODATION OVER 4 FLOORS, EVER POPULAR VILLAGE OF OAKWORTH WITH EXCELLENT ACCESS TO THE LOCAL PRIMARY SCHOOL!**** Modern fitted kitchen with integrated appliances, Newly fitted fully tiled bathroom, tiered front artificial lawn, paved off-road parking - VIEWING HIGHLY RECOMMENDED TO FULLY APPRECIATE!! EPC rating is D.

FULL DESCRIPTION

Situated in the ever popular village location of Oakworth with excellent access to the local primary school is this deceptively spacious three bedroom through terrace. The property offers well presented accommodation over four floors and comprises of a spacious lounge with mutli-fuel burning stove, radiator, and double glazed window to the front. The kitchen has a range of modern base and wall mounted units, integrated appliances to include double oven, hob, extractor fan, fridge and freezer. There is access to a useful basement playroom/cinema room with double glazed window and radiator. To the first floor there are two bedrooms, the larger of which has fitted wardrobes benefiting from views towards Haworth and the Worth Valley. Also on this level is a separate WC. To the second floor there is a further double bedroom with fitted wardrobes, and the house bathroom is also on this level having a newly fitted three piece suite comprising of a 'P' bath with shower over, WC, wash hand basin, fully tiled walls and floor. Externally there is an enclosed tiered artificial lawn to the front, to the rear is a paved parking area.. Viewing highly recommended to fully appreciate, EPC rating is D.

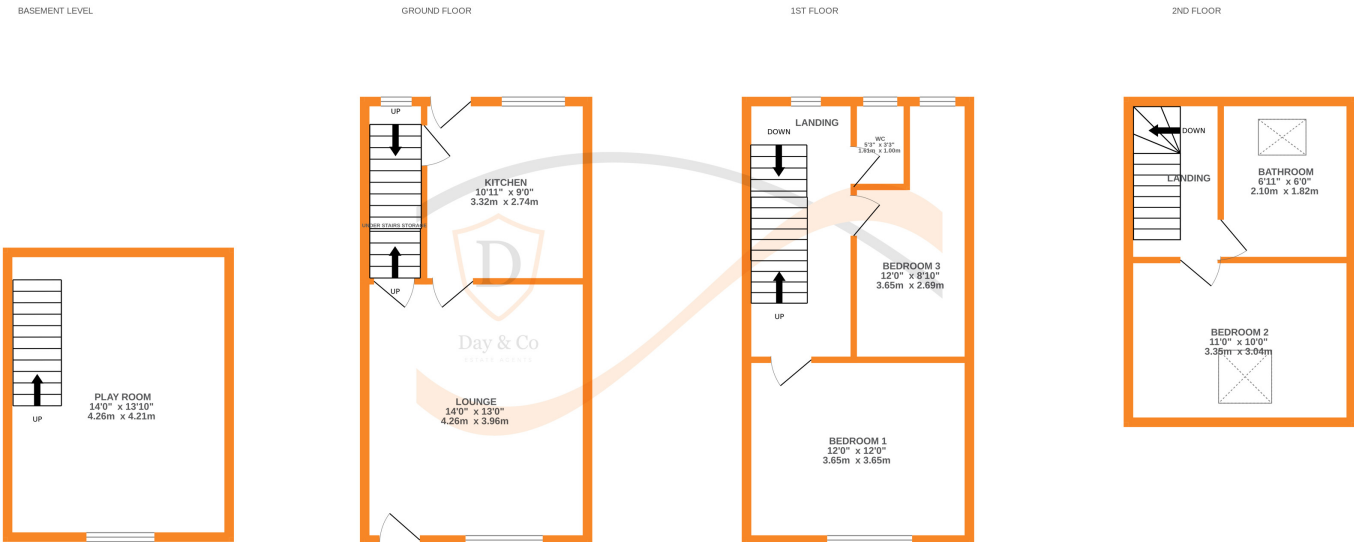

Whilst every attempt has been made to ensure the accuracy of the floorplan contained here, measurements of doors, windows, rooms and any other items are approximate and no responsibility is taken for any error, omission or mis-statement. This plan is for illustrative purposes only and should be used as such by any prospective purchaser. The services, systems and appliances shown have not been tested and no guarantee as to their operability or efficiency can be given.
Made with Metropix ©2025