



MAXWELLS



5 The Old Elephant & Castle, Causeway, Banbury, Oxfordshire. OX16 4SN
Guide Price £250,000 - Share of Freehold



PROPERTY DESCRIPTION

Beautifully converted and wonderfully presented, this Grade II Listed first floor apartment is located just a short walk from the train station and town centre and offers two double bedrooms, en suite to the master, large open plan kitchen/sitting/dining room and allocated parking.

The Old Elephant & Castle is a Grade II Listed selection of properties with the main Ironstone house believing to date back to the late 17th century when it was used as an Inn. Number 5 is a large, first floor apartment offering two double bedrooms with fitted wardrobes and an en suite shower room to the master, a well-appointed bathroom and a large open plan kitchen/sitting/dining room fitted with a comprehensive range of high specification appliances. There are plenty of windows which provide lots of natural light and a private front door opening into an entrance hallway with stairs leading to the apartment.

There is allocated parking for one car in the rear courtyard and the access can be found off Causeway.

The apartments are fitted with the latest, low energy/high efficiency electric heating. They are offered as a share of freehold with 999 year leases (virtual freehold) and will come with a 10 year building warranty.

Services connected include mains water, drainage and electricity; there is no mains gas connected to these apartments. There will be no ground rent payable and we are currently awaiting the projected management fee's from the seller.

POINTS OF INTEREST

- Grade II Listed Apartment Building
- First Floor Apartment
- Two Double Bedrooms with Fitted Wardrobes
- En Suite Shower Room
- Bathroom
- Private Entrance
- Large Kitchen/Sitting/Dining Room
- Allocated Parking
- Share of Freehold on a 999 Year Lease

5 THE OLD ELEPHANT &
CASTLE
70.0 sq.m. (753 sq.ft.) approx.

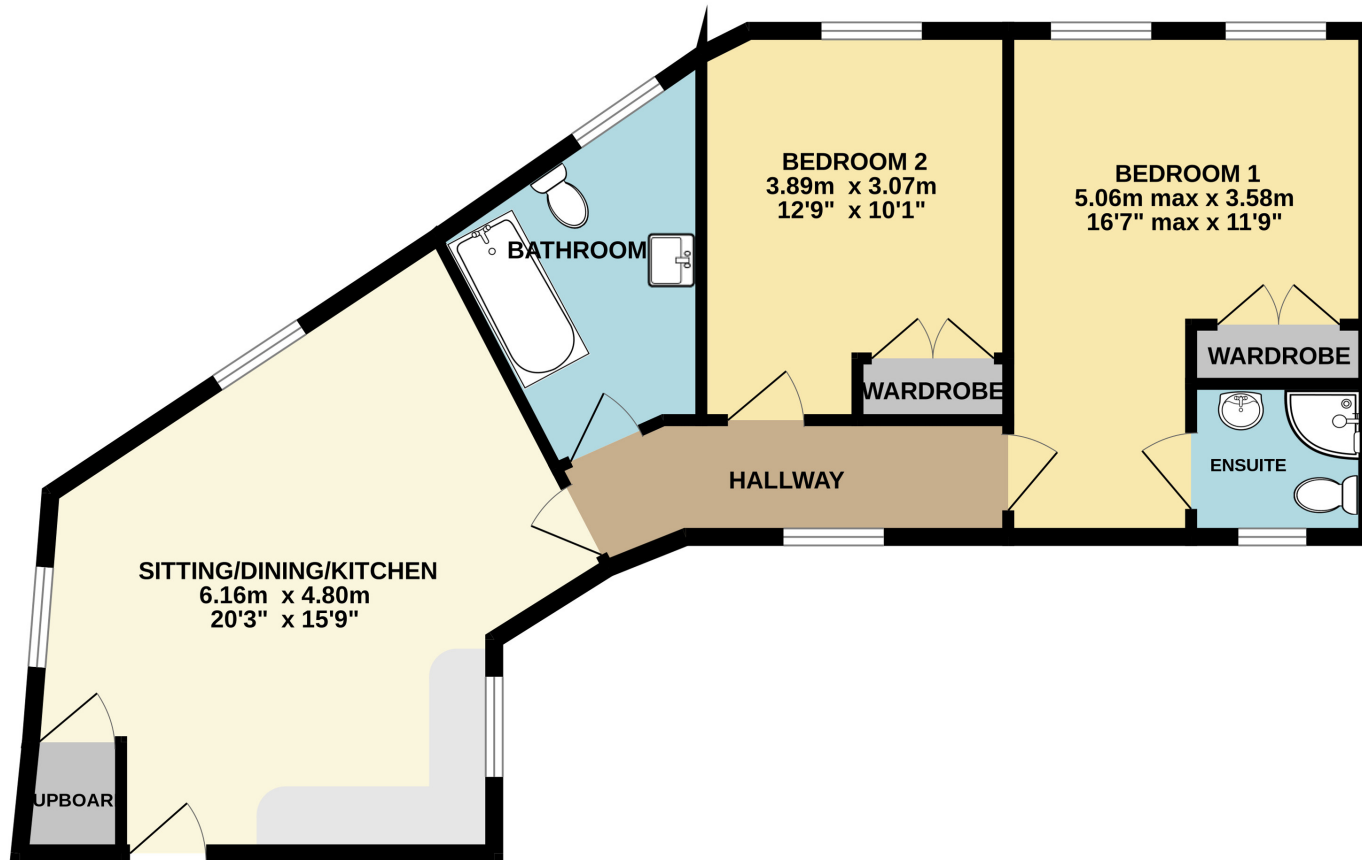

TOTAL FLOOR AREA : 70.0 sq.m. (753 sq.ft.) approx.

Whilst every attempt has been made to ensure the accuracy of the floor plan contained here, measurements of doors, windows, rooms and any other items are approximate and no responsibility is taken for any error, omission or mis-statement. This plan is for illustrative purposes only and should be used as such by any prospective purchaser.
Made with Metropix ©2024