

Bath Office
35 Brock Street, Bath BA1 2LN
T: (+44 (0)1225 333332
E: bath@cobbfarr.com

Bradford on Avon Office
37 Market Street, Bradford on Avon BA15 1LJ
T: (+44 (0)1225 866111
E: bradfordonavon@cobbfarr.com

cobbfarr.com

**COBB
FARR**

Bath & Bradford on Avon

**COBB
FARR**

Bath & Bradford on Avon

Residential Sales



Land North of Frome Road, Southwick, Wiltshire, BA14 9QQ

0.17 hectares of freehold land with outline planning permission for 2 detached self-build houses to meet high energy efficiencies and low carbon regulations.

Tenure: Freehold

£400,000

Situation

The property is situated in the village of Southwick, approximately 4½ miles from the market town of Bradford on Avon and approximately 2 miles from the county town of Trowbridge.

The property itself backs onto Southwick Country Park and The Hope Nature Centre providing countryside walks and a café. The village has a local shop and post office, The Farmhouse public house and a primary school, Ofsted rated Good.

Bradford on Avon provides a range of individual retail outlets together with other amenities to include a railway station, a swimming pool, a library and also a good selection of schools, to include the much renowned St. Laurence School.

The World Heritage City of Bath is approximately 12 miles distant and provides a fuller range of retail outlets together with many other amenities. Other surrounding towns include Frome, Warminster, Melksham and Chippenham. The nearby town of Westbury provides a mainline railway station giving direct access to London Paddington.

Description

0.17 hectares of freehold land with outline planning permission for 2 detached self-build houses to meet high energy efficiencies and low carbon regulations.

Properties access served off an existing privately owned and maintained access onto the A361 Frome Road. All Mains Services available for connection nearby.

Southwick is located to the south of Trowbridge and is convenient for access to nearby towns of Bradford on Avon and Frome, plus the city of Bath. Mainline stations at Bath and Westbury.

Outline Planning Reference PL/2022/05259 for full details online.

For further information, please contact Philip Cobb or Lynette McAlister the sole agents Cobb Farr.

Key Features

- 0.17 hectares of freehold land
- Outline Planning Permission for 2 detached houses
- Outline Planning Permission reference PL/2022/05259
- Sole Agent Cobb Farr

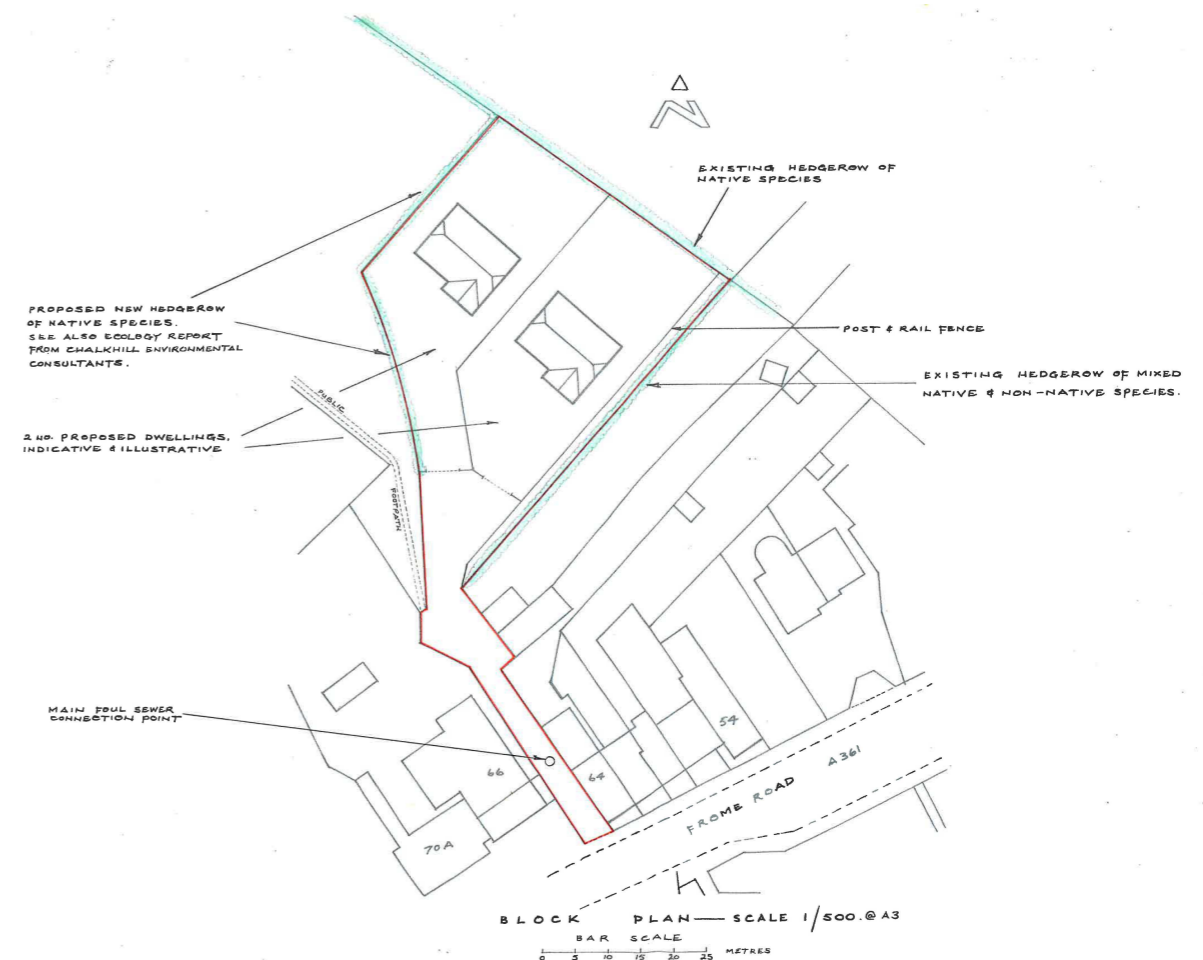

General Information

All Mains Services available for connection nearby.

Important Notice: Cobb Farr, their clients and any joint agents give notice that: They assume no responsibility for any statement that may be made in these particulars. These particulars do not form part of any offer or contract and must not be relied upon as statements or representations of fact. Any areas, measurements or distances are approximate. The text, photographs and plans are for guidance only and are not necessarily comprehensive. It should not be assumed that the property has all necessary planning; building regulation or other consents and Cobb Farr have not tested any services, equipment or facilities. Purchasers must satisfy themselves by inspection or otherwise.