



Bennett Place,
Bradwell



OneAgency

01782 970222

hello@oneagencygroup.co.uk



Offers in Region of £140,000

A three bedroom semi-detached house in the popular location of Bradwell. The property benefits from two reception rooms, first floor bathroom and gardens to front and rear. The property is in need of some improvement, an ideal first time buy or investment. Located close to Newcastle Town, commuter links such as A500 & M6. Viewing is highly advised!





Ground Floor

Hallway

3.10m x 1.77m (10' 2" x 5' 10") Entered through the front door, radiator and carpet flooring.

Reception Room One

3.17m x 3.11m (10' 5" x 10' 2") A double glazed window, radiator and carpet flooring.

Reception Room Two

4.09m x 3.69m (13' 5" x 12' 1") A double glazed window, storage cupboard, radiator and carpet flooring.

Kitchen

1.93m x 1.30m (6' 4" x 4' 3") Stainless steel sink basin, space for a cooker, plumbing for a washing machine, double glazed window and door to the rear.

First Floor

Bedroom One

3.81m x 3.16m (12' 6" x 10' 4") A double glazed window, radiator and carpet flooring.

Bedroom Two

3.30m x 3.05m (10' 10" x 10' 0") A double glazed window, cupboard with combi boiler, radiator and carpet flooring.

Bedroom Three

2.47m x 1.81m (8' 1" x 5' 11") A double glazed window, radiator and carpet flooring.

Bathroom

2.01m x 1.65m (6' 7" x 5' 5") Bath unit, pedestal hand wash basin, low level W/C, radiator and carpet flooring.

External

Front - A paved driveway and lawned garden.

Rear - A paved patio and lawned garden.

AGENTS NOTES

The council tax band is B. The local authority is Newcastle-under-Lyme.

We understand probate has been granted, but deeds missing and an application is with Land Registry to reconstruct the deeds.



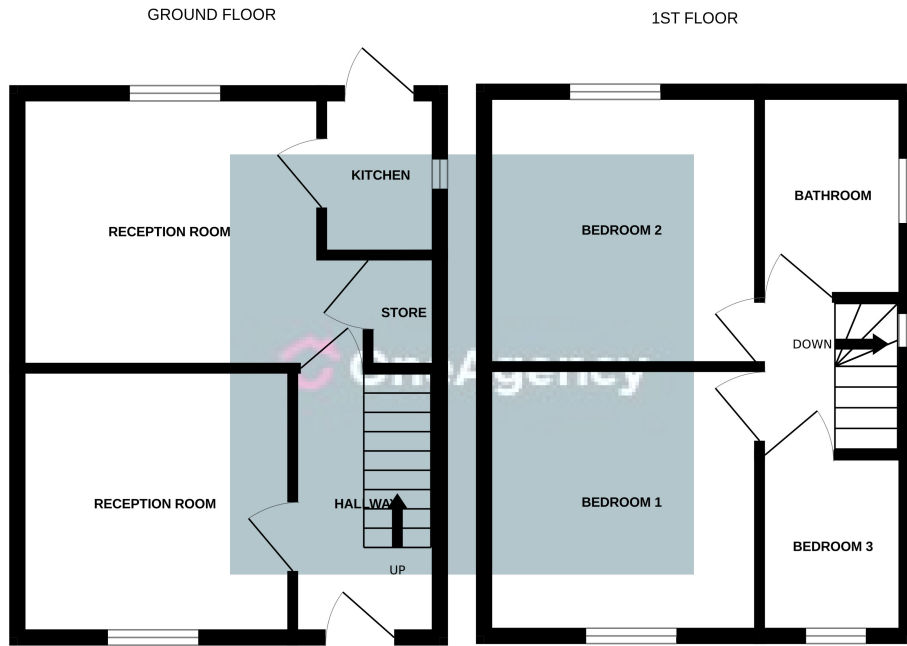

Whilst every attempt has been made to ensure the accuracy of the floorplan contained here, measurements of doors, windows, rooms and any other items are approximate and no responsibility is taken for any error, omission or mis-statement. This plan is for illustrative purposes only and should be used as such by any prospective purchaser. The services, systems and appliances shown have not been tested and no guarantee as to their operability or efficiency can be given.
Made with Metropix ©2024

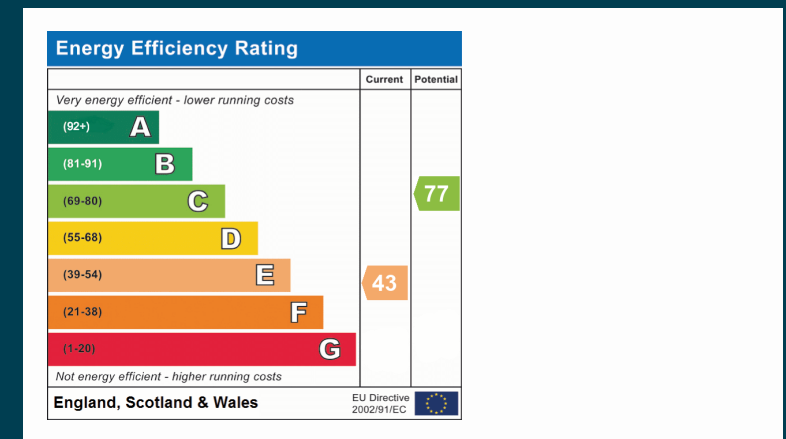

OneAgency, 9 & 10 Ridge House Drive, Festival Park, Stoke-on-Trent, ST1 5SJ

01782 970222

hello@oneagencygroup.co.uk

Every attempt has been made to ensure accuracy, however, all measurements are approximate and for illustrative purposes only. **Not to scale.**

In accordance with The Consumer Protection from Unfair Trading Regulations 2008 the following particulars have been prepared in good faith and they are not intended to constitute part of an offer or contract. We have not carried out a structural survey and the services, appliances and specific fittings have not been tested. All photographs, measurements, floor plans and distances referred to are given as a guide only and should not be relied upon for the purchase of carpets or any other fixtures and fittings. Lease details, service charges and ground rent (where applicable) are given as a guide only and should be checked and confirmed by your Solicitor prior to exchange of contracts.