



Manor Crescent

Manor Crescent | Hitchin | Hertfordshire | SG4 9LY

www.stonegate-estates.co.uk



MANOR CRESCENT

Property Description

A 'Chain Free' home standing on a generous corner garden plot within the sought-after SG4 9.. postcode area of Hitchin.

This well-presented three-bedroom semi-detached chalet bungalow offers flexible living accommodation in a highly desirable residential location. The property features a welcoming entrance hall, a lounge with patio doors overlooking the rear garden, a refitted kitchen and bathroom.

Three bedrooms offering convenience and versatility with the added benefit of walk-in eaves storage.

Outside there is a garage and driveway providing off road parking along with a generous garden benefitting from the corner position which wraps around the side and to the front creating a private space to enjoy and offering potential to extend the current home to further enhance this family home (STPP)

Located in the sought after Hitchin residential area, this property is within walking distance of the town centre, market place, train station, and popular schools. Commuting is made easy with the A1 motorway nearby and excellent train routes straight into Kings Cross.

Surrounded by rural walks and a bustling town centre filled with restaurants, coffee shops, and local independent traders, this home offers the perfect blend of peaceful living and convenience in the sought after market town of Hitchin.

Don't miss out on the opportunity to view this family home and wonderful opportunity. Call now to arrange a viewing on this 'Chain Free' home.

£600,000 Freehold



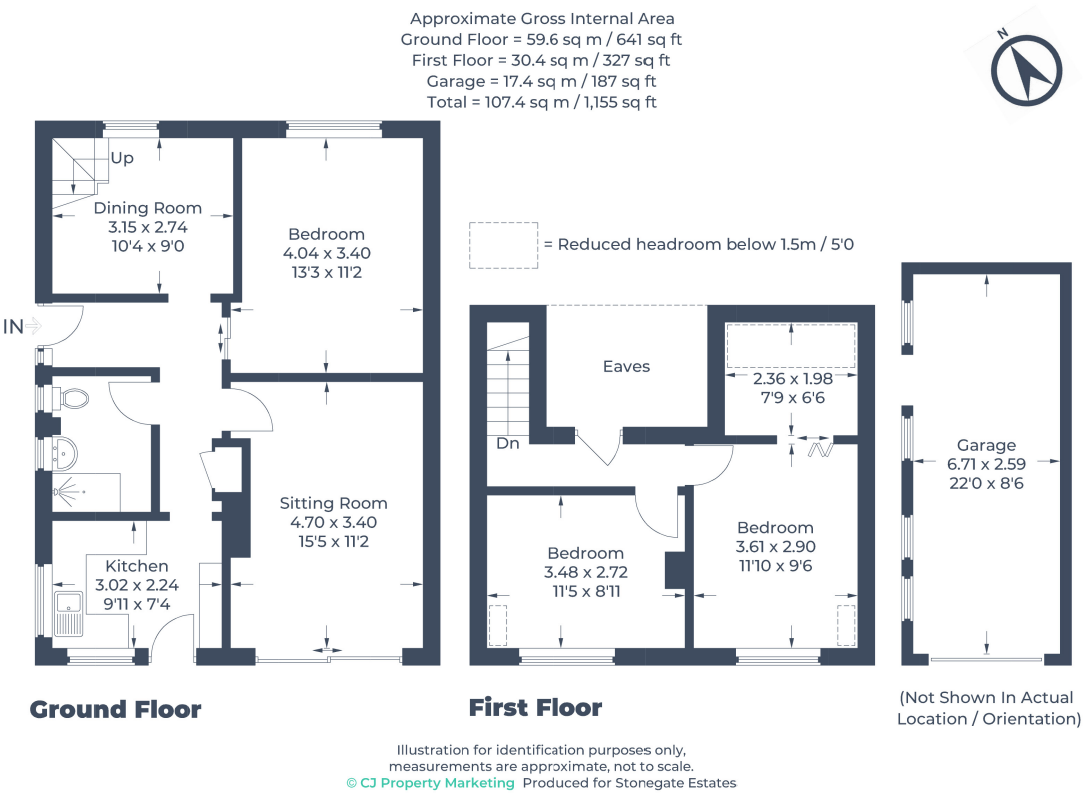



- Corner Position
- SG4 9.. Postcode
- Garage & Off Road Parking
- Great Location
- Close to Town Centre & Rail Station
- Generous Size Rear Garden
- New Gas Central Heating in 2023
- New Flooring

EPC Rating: D

Stonegate Estate Agents

01462 438979

sales@stonegate-estates.co.uk | www.stonegate-estates.co.uk

