



11 Hermitage Court Edgell Road, Staines-upon-Thames, TW18 2DR

WELL PRESENTED AND SPACIOUS ONE BEDROOM APARTMENT IN SOUGHT AFTER DEVELOPMENT WITHIN MOMENTS OF TOWN CENTRE & STATIONS. The property benefits from a spacious lounge/diner, separate modern fitted kitchen, large double bedroom, modern white bathroom suite and a long lease. Viewings Highly Recommended!

ROOM DESCRIPTIONS

FLOORPLAN

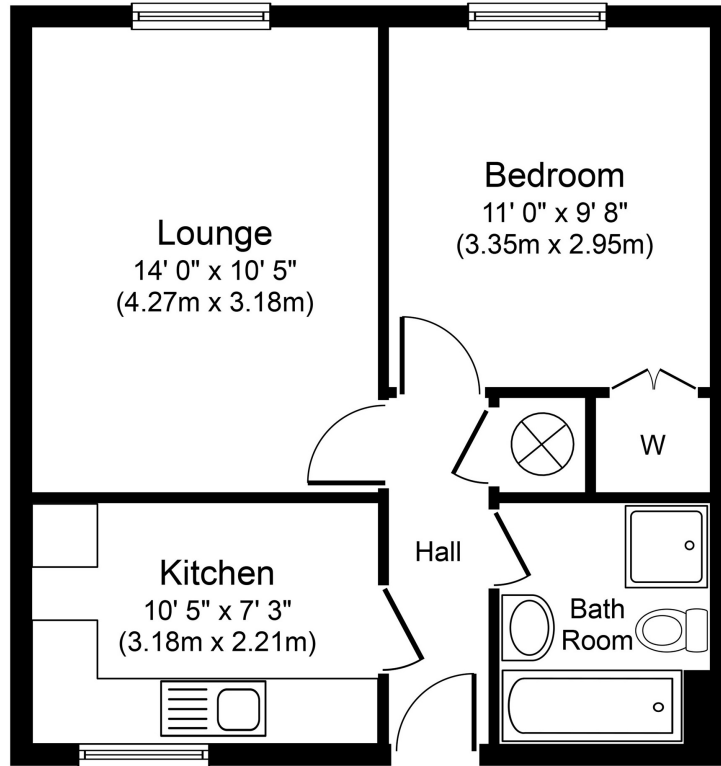

Approximate Floor Area
429 sq. ft.
(39.9 sq. m.)

Whilst every attempt has been made to ensure the accuracy of the floor plan contained here, measurements of doors, windows, rooms and any other items are approximate and no responsibility is taken for any error, omission, or mis-statement. This plan is for illustrative purposes only and should be used as such by any prospective purchaser or tenant. The services, systems and appliances shown have not been tested and no guarantee as to their operability or efficiency can be given.
Copyright V360 Ltd 2020 | www.houseviz.com

127a, High Street, Staines-upon-Thames, TW18 4PD

01784 451458

staines@gregory-brown.co.uk