

Edgware is a popular suburb in North West London situated 20 minutes from the City centre. Principally a shopping and residential area, it has excellent transport links via both Canons Park Jubilee & Edgware's Northern Line underground station and is ideal for drivers with its easy access to the M1 and M25.

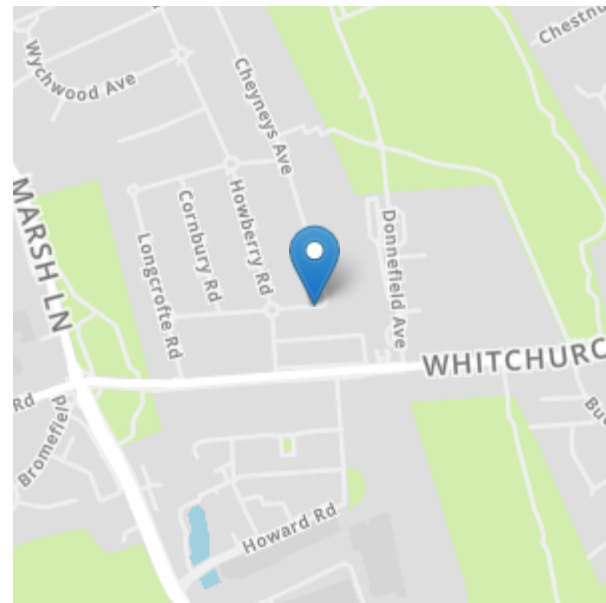

Watersfield Way, Edgware. HA8 6RZ. Freehold

Superbly Maintained Bright & Airy Extended 5 Bedroom Property. The house has been skilfully extended and renovated to create two extra bedrooms/study plus a bathroom in the loft area. This is an ideal family home with a newly renovated modern kitchen and bathrooms throughout. Located in this prime position being a short walk to Canons Park Jubilee line train station and shopping facilities, with numerous excellent local state and private schools close by, this property should be viewed internally to be fully appreciated. Canons Park open spaces and playground are also a short walk away.

- 5 Bedroom Family Home
 - Close To Canons Park Jubilee Line Station
 - Two Reception Rooms
 - Off Street Parking
 - Two Bathrooms
 - Bright & Airy Throughout
 - Car Charging Point
- Superb Condition Throughout
 - Extended Kitchen/Diner
 - Internal Viewing Highly Recommended
 - Guests Cloakroom
 - South Facing Rear Garden
 - High Specification Throughout

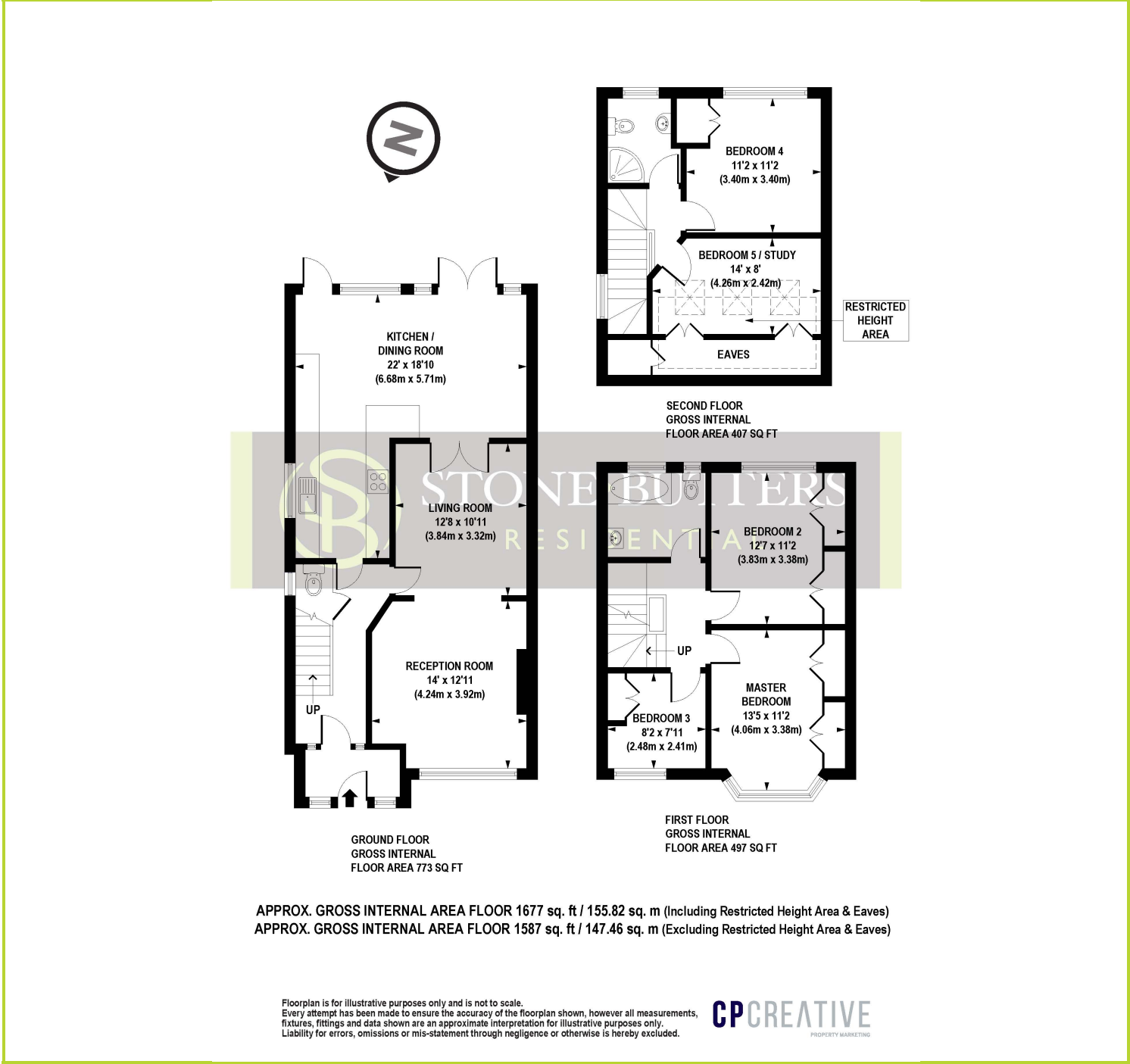

(Floor plans are not to scale and measurements are given for guidance only)

