

Truuli



Bigginwood Road, London, SW16

£775,000 Freehold

- Semi detached family home
- Downstairs shower room and upstairs bathroom
- Ensuite to primary bedroom
- Off street parking for multiple cars
- Easy access into Streatham or Crystal Palace
- Guide price £775,000 - £800,000

2, Lansdowne Road, Croydon, Surrey, CR9 2ER

Tel: 0330 043 0002

Email: save@truuli.co.uk Web: www.truuli.co.uk

Bigginwood Road, London, SW16

£775,000 Freehold

*** Guide price £775,000 - £800,000 *** A superb double-fronted four bedroom period family home located on Bigginwood Road, Streatham. The property is presented, in our opinion, in good condition and is within easy reach of Norbury Park.

Ground Floor
873 sq.ft. (81.1 sq.m.) approx.

1st Floor
640 sq.ft. (59.4 sq.m.) approx.

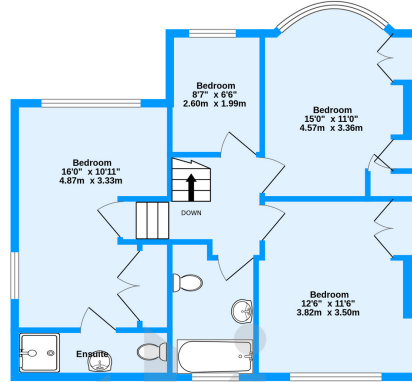
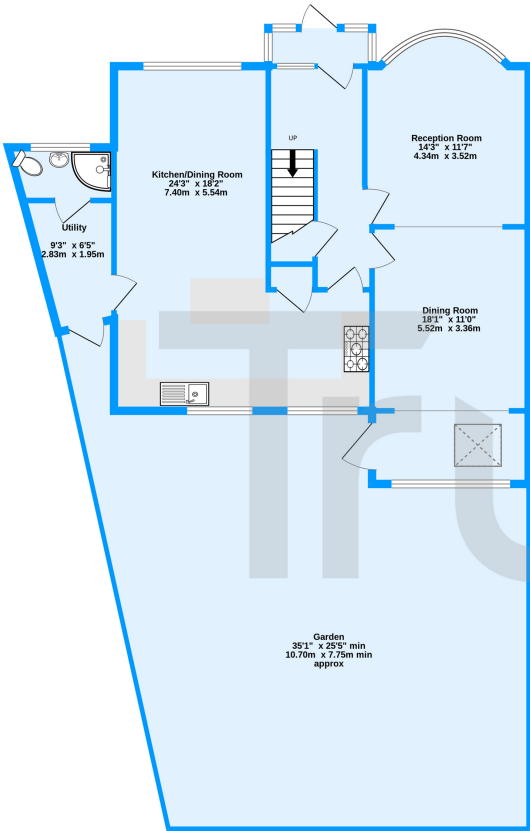

Bigginwood Road, Norbury, SW16

TOTAL FLOOR AREA: 1513 sq.ft. (140.5 sq.m.) approx.
Measurements are approximate. Not to scale. Illustrative purposes only
Made with Metropix ©2023

