



One Bedroom Apartment
High Street, Rainham, Gillingham, Kent, ME8 8AT

Guide Price £150,000
Leasehold

High Street, Rainham, Gillingham, Kent, ME8 8AT

Guide Price £150,000

Leasehold

Description

* Guide Price £150,000 - £170,000 * An exceptional collection of newly renovated apartments, forming part of Durland House, a distinguished Grade II listed former care home, thoughtfully converted to combine contemporary living with charming period character. This attractive gated development comprises six beautifully finished apartments, each completed to a high specification while retaining an array of original features — from exposed ceiling beams and characterful fireplaces to restored original woodwork throughout the communal areas and individual homes. To the first floor are four stylish one-bedroom apartments, each offering a spacious double bedroom, modern open-plan living/kitchen area, a well-appointed bathroom, and a separate W.C./utility room. These thoughtfully designed layouts maximise both space and practicality, ideal for first-time buyers, downsizers, or investors alike. On the ground floor, a generously proportioned one-bedroom apartment provides more traditional accommodation, featuring a separate lounge, kitchen/breakfast room, double bedroom, bathroom, and direct access to a private courtyard garden. Also on the ground floor is an impressive two double bedroom apartment, boasting two bathrooms, an additional W.C., and a spacious open-plan kitchen/living area. This charming home further benefits from an inglenook fireplace and access to a private courtyard garden, blending historic character with modern comfort. Each apartment benefits from one allocated parking space within the secure gated grounds. Perfectly positioned in the heart of Rainham, the development enjoys excellent access to a wide range of local amenities, shops, and transport links, all just moments from the doorstep. All apartments are offered chain free and ready to buy now, presenting a rare opportunity to acquire a unique home within a landmark building. EPC awaited. Please note the building can be purchased as a whole, call the Greyfox sales team in Rainham to discuss further.

Key Features

- Grade II Listed Conversion
- One Double Bedroom
- Allocated Parking For One Car
- Open Plan Lounge/Kitchen & Diner
- Central Rainham Location Close To Amenities & Transport Links
- Bathroom & Separate W.C
- First Floor Apartment With Period Features
- Chain Free

Local Area

Rainham in the Medway towns is located descending towards the banks of the river Medway, approximately 39 miles from London. The ancient Watling Street main road (A2) runs through the town with the M2 motorway on the southern edge with good links to the M25/M20. There are a good number of shops and facilities within the town, a mainline station and a selection of local schools including Rainham Mark Grammar School.

GROUND FLOOR
479 sq.ft. (44.5 sq.m.) approx.

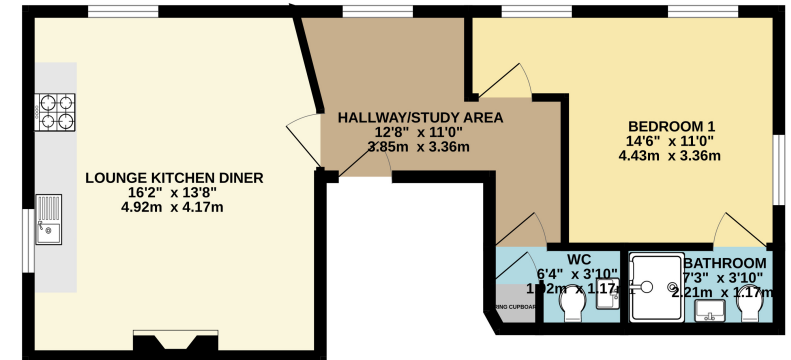

TOTAL FLOOR AREA: 479 sq.ft. (44.5 sq.m.) approx.
Whilst every attempt has been made to ensure the accuracy of the floorplan contained here, measurements of doors, windows, rooms and any other items are approximate and no responsibility is taken for any error, omission or mis-statement. This plan is for illustrative purposes only and should be used as such by any prospective purchaser. The services, systems and appliances shown have not been tested and no guarantee as to their operability or efficiency can be given.
Made with Metropix ©2025



Property Location

High Street, Rainham, Gillingham, Kent, ME8 8AT

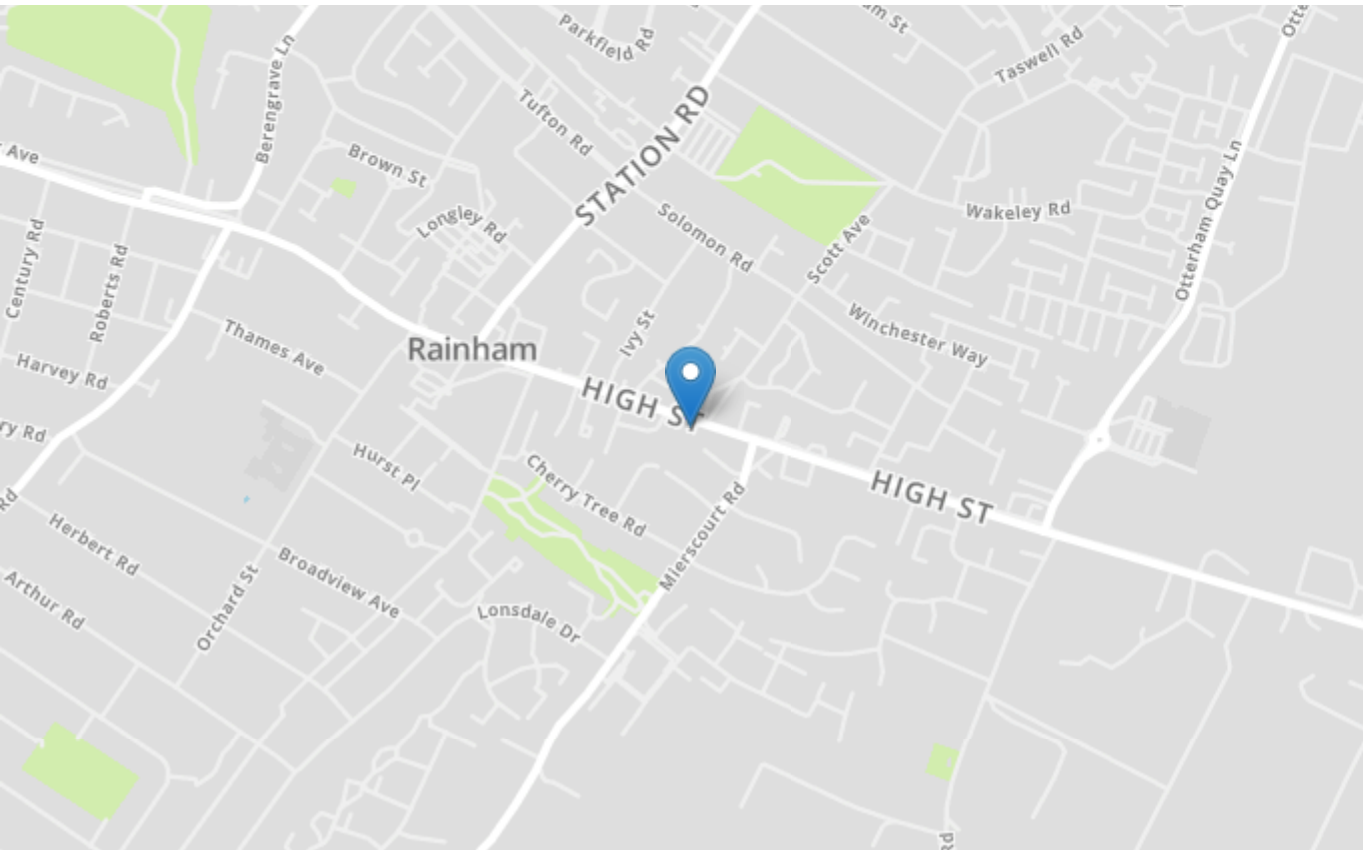

Tenure	Leasehold
Lease Term	125 Years
Ground Rent	£300 Per Annum
Service Charge	£1,950 Per Annum
Local Authority	Medway
Council Tax	Band C

Greyfox Walderslade

Unit 2, Thetford House
Walderslade Village Centre
Walderslade Road
Chatham
Kent
ME5 9LR
Tel: 01634 672227 Email:
walderslade@greyfox.co.uk

Greyfox Rainham

67C High Street
Rainham
Kent
ME8 7HS
Tel: 01634 377737 Email:
rainham@greyfox.co.uk

Agent Notes

These particulars are prepared as a general guide to a broad description of the property and should not be relied upon as a statement or representation of fact and do not constitute part of an offer or contract. The seller does not make or give nor do our employees or Greyfox have authority to make or give any representation or warranty to the property. We have not carried out a structural survey and the services, appliances and specific fittings have not been tested. All photographs, measurements, floorplans and distances referred to are given as a guide only and should not be relied upon for the purchase of carpets or any other fixtures or fittings. Lease details, service charges and ground rent (where applicable) and council tax are given as a guide only and should be checked and confirmed by you on inspection and your solicitor prior to exchange of contracts. If there are any points of particular importance to you we will be pleased to check the information for you and to confirm that the property remains available. This is particularly important should you be travelling some distance to view and where statements have been made by us to the effect that the information has not been verified. The copyright of all details, photographs and floorplans remain exclusive to Greyfox. For details of our privacy policy and referral fee arrangements with any of our selected partner companies please visit <https://www.greyfox.co.uk/legal/privacy> and <https://www.greyfox.co.uk/referral-fees>.