



Roman Road, East Ham, London. E6 3RY.



PRICE
£400,000
To
£425,000

Transport Information

0.6 miles to Beckton DLR Station, with a plethora of buses taking you towards East Ham Station for the District and Hammersmith & City Lines

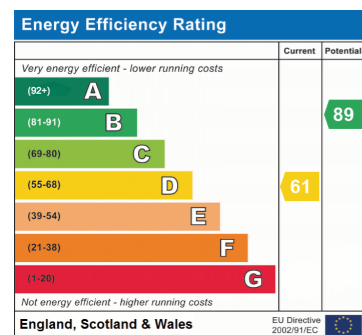

These particulars are only a general outline for the guidance of intending purchasers or lessees and do not constitute in whole or in part an offer or a Contract. Reasonable endeavours have been made to ensure that the information given in these particulars is materially correct but any intending purchaser or lessee should satisfy themselves by inspection, searches, enquiries and survey as to the correctness of each statement.

What's next?

If you are interested in viewing this property or putting in an offer please call the office on 02084705252.

We are based just two doors down from East Ham Station.

- Two Double Bedrooms
- Rear Garden with Outbuilding
- Mid-Terraced House
- Bright and Spacious Throughout
- Fantastic Condition and Decorative Order





Roman Road, East Ham. E6 3RY.

Guide Price: £400,000 to £425,000 Freehold
Please be aware this is a sale by tender property, and the prospective purchaser may have to pay an Introduction Fee to Aston Fox and viewings are strictly by appointment ONLY.

A fantastic property opportunity for first time buyers and BTL investors!

Upon entering the property, you find yourself in a spacious lounge with dining area, and a fitted kitchen with direct access to the rear garden. You also have the modern family bathroom on the ground floor, the going up to the first floor you will find two spacious double bedrooms with plenty of room for furniture. This home is completed by an outbuilding to the rear of the property, perfect for optimising storage space!

The property is located close to the award-winning Brampton Manor School, near bus routes, A13 and a short walk from the Greenway and Lonsdale Park. It is situated within a reasonable distance of Beckton DLR station and an array of shopping facilities at The Asda Centre and Gallions Reach. Call now to arrange your viewing!

Council Tax Band: B
Council: Newham
Annual Cost: £1,444

What the owner says...

This is a great home, we've loved living here! Sadly moving as we need more rooms, you will love the area and community here!

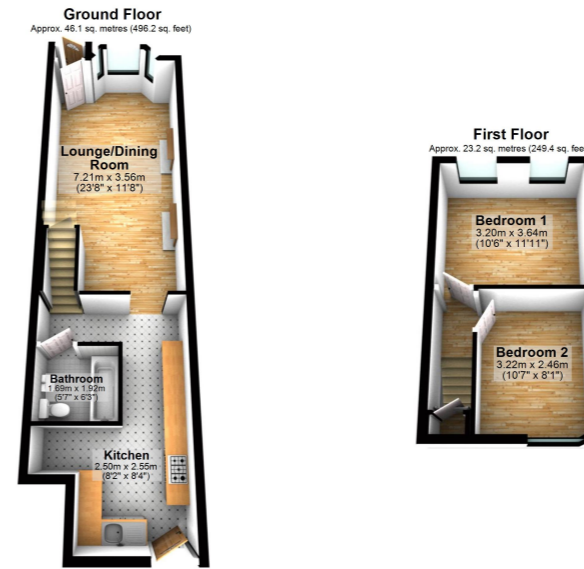

Total area: approx. 69.3 sq. metres (745.6 sq. feet)
Roman Road, East Ham

Accommodation Ground Floor

Lounge / Diner
23' 8" x 11' 8" (7.21m x 3.56m)

Kitchen
8' 5" x 8' 2" (2.57m x 2.49m)

Bathroom
10' 7" x 8' 1" (3.23m x 2.46m)

Garden 35ft

Outbuilding
11' 9" x 7' 10" (3.58m x 2.39m)

First Floor

Bedroom One
11' 11" x 10' 6" (3.63m x 3.20m)

Bedroom Two
10' 7" x 8' 1" (3.23m x 2.46m)

