



- Two Bedroom Mews House
- Private & Exclusive Development Consisting Of Just 10 Properties
- Garage & Allocated Parking
- Circa 1100SQFT Of Accommodation
- Gas Boiler Replaced in 2023
- Annual Service Charge - £1,155.38 (Includes Buildings Insurance & Sink/Reserve Fund For Exterior Works)
- En Suite's To Both Bedrooms
- No Onward Chain
- Generous & Versatile Living Accommodation
- Unique Addition To The Market

Flat 5, 375 Lea Court, Baddow Road, Chelmsford, Essex. CM2 7QQ.

Michaels Property Consultants are delighted to present to the market this rather unique opportunity to acquire this two bedroom Freehold mews house, occupying an enviable position within 'Lea court', a private and exclusive development in Great Baddow consisting of just 10 properties. New to the market and offered for sale with no onward chain, this superb property offers versatile accommodation arranged over two floors spanning in excess of 1100sqft, representing an ideal purchase for a buyer seeking both a combination of space combined with exquisite architectural design.



Property Details.

Ground Floor

Entrance Hall



Cloakroom/WC

Kitchen/Diner



14' 5" x 11' 7" (4.39m x 3.53m)

Living Room



19' 1" x 13' 0" (5.82m x 3.96m)

First Floor

Bedroom One



14' 6" MAX x 11' 7" (4.42m x 3.53m)

Property Details.

En Suite One



Bedroom Two



13' 1" x 10' 7" (3.99m x 3.23m)

En Suite Two



Outside

Well Maintained Communal Gardens



Single Garage & Parking

Property Details.

Floorplans

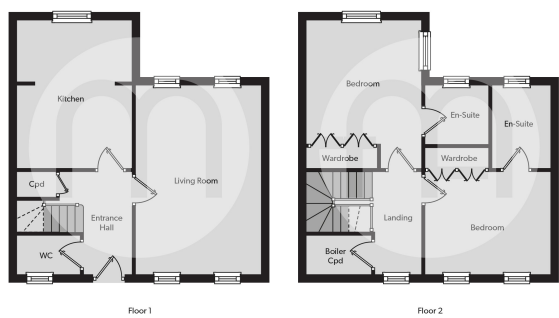

Location

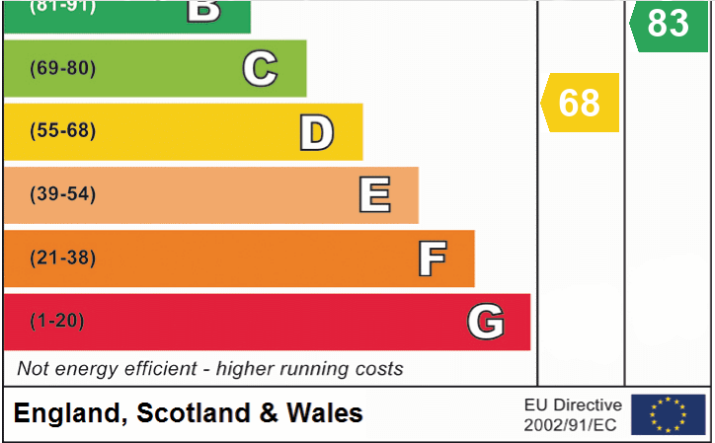

We have not carried out a structural survey and the services, appliances and specific fittings have not been tested. All photographs, measurements, floor plans and distances referred to are given as a guide only and should not be relied upon for the purchase of carpets or any other fixtures or fittings. Gardens, roof terraces, balconies and communal gardens as well as tenure and lease details cannot have their accuracy guaranteed for intending purchasers. Lease details, service ground rent (where applicable) are given as a guide only and should be checked and confirmed by your solicitor prior to exchange of contracts.