

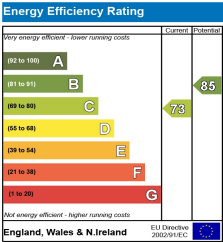

Brunswick Street West, Hove, BN3 1EL  
Offers In Excess of £750,000

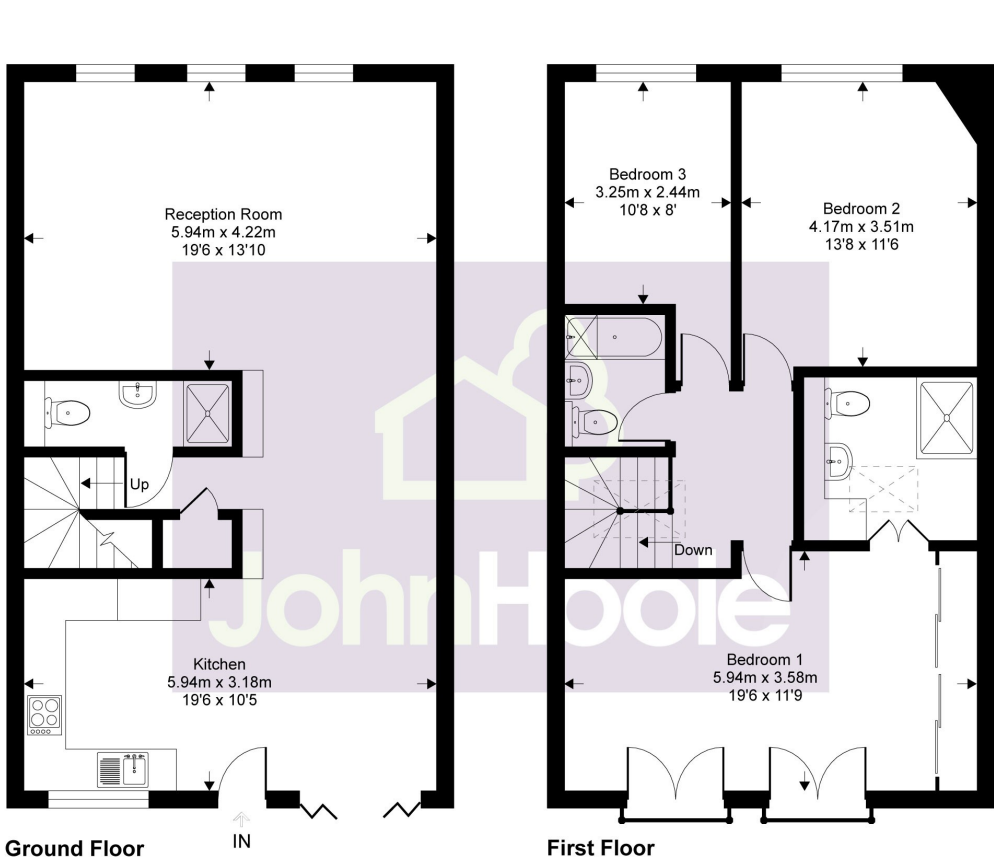

**Brunswick St West, BN3**  
Approximate Gross Internal Area = 124.9 sq m / 1345 sq ft



This floor plan is for representation purposes only as defined by the RICS code of Measuring Practice (and IPMS where requested) and should be used as such by any prospective purchaser. Whilst every attempt has been made to ensure the accuracy contained here, the measurement of doors, windows and rooms is approximate and no responsibility is taken for any error, omission or mis-statement. Specifically no guarantee is given on the total area of the property if quoted on the plan. Any figure provided is for guidance only and should not be used for valuation purposes.

Copyright Casaphotos Ltd. 2022 - Produced for John Hoole

01273 555115  
info@johnhoole.co.uk  
johnhoole.co.uk  
214 Dyke Road | Brighton | BN1 5AA

Agents note: All measurements are approximate and whilst every attempt has been made to ensure accuracy they are for general guidance only and must not be relied on. The fixture and fittings referred to have not been tested and therefore no guarantee can be given that they are in working order. Internal photographs are reproduced for general information and it must not be inferred that any item shown is included with the property.







Situated in a quiet mews of Regency coach houses in the heart of Hove, this charming three bedroom and three bathroom home is only moments away from all that Brighton and Hove have to offer. Combined with the buzz of the city on your doorstep and the charm of living in the Brunswick Town conservation area, this is a fantastic opportunity to enjoy the best of both worlds.

Behind the wide double fronted facade with its Juliet balconies, the easy flowing layout of the ground floor offers a large kitchen and dining area, with a concealed downstairs shower room, leading to a generous family lounging and TV/entertainment space. Upstairs the bright landing leads to three double bedrooms and two bathrooms, one an en-suite shower/dressing room and the other a family bath/shower room. Wood floors, white walls and plenty of character combine with contemporary design features to create a wow factor throughout the property and a home that the whole family will love. Boasting a private parking space too, this spectacular property would suit anyone looking for an exclusive and luxurious home by the sea.



- MEWS HOUSE IN CENTRAL HOVE
- BRUNSWICK TOWN CONSERVATION AREA
- CONTEMPORARY STYLING TO COMPLEMENT PERIOD FEATURES
- SPACIOUS OPEN PLAN LIVING AREA WITH SOLID WOODEN FLOORING
- GROUND FLOOR SHOWER SUITE
- 3 BEDROOMS - MASTER WITH EN SUITE
- OFF ROAD PARKING
- UNDERFLOOR HEATING
- OVER 1300 SQ FT ACCOMMODATION
- CLOSE TO SEAFRONT AND AMENITIES