



Atlantis Court, Brunswick Park Road, London, N11

£1,400 pcm

- Circa 530 sq ft
- Ground Floor Flat
- Open Plan Kitchen/Reception
- Spacious Bedroom With Ample Storage Space
- Contemporary Bathroom
- Recently Built Development
- Allocated Parking Space
- Modern Apartment
- One Bedroom

Atlantis Court, Brunswick Park Road, London, N11

£1,400 pcm

A luxury one bedroom apartment positioned on the ground floor of this recently built development offering circa 530 sq ft (49 sq M) of internal space and a allocated parking space.

This superb flat benefits from a stylish open plan kitchen/reception room area, a fully carpeted bedroom and a contemporary bathroom. Further key features include an allocated parking space and ample storage.

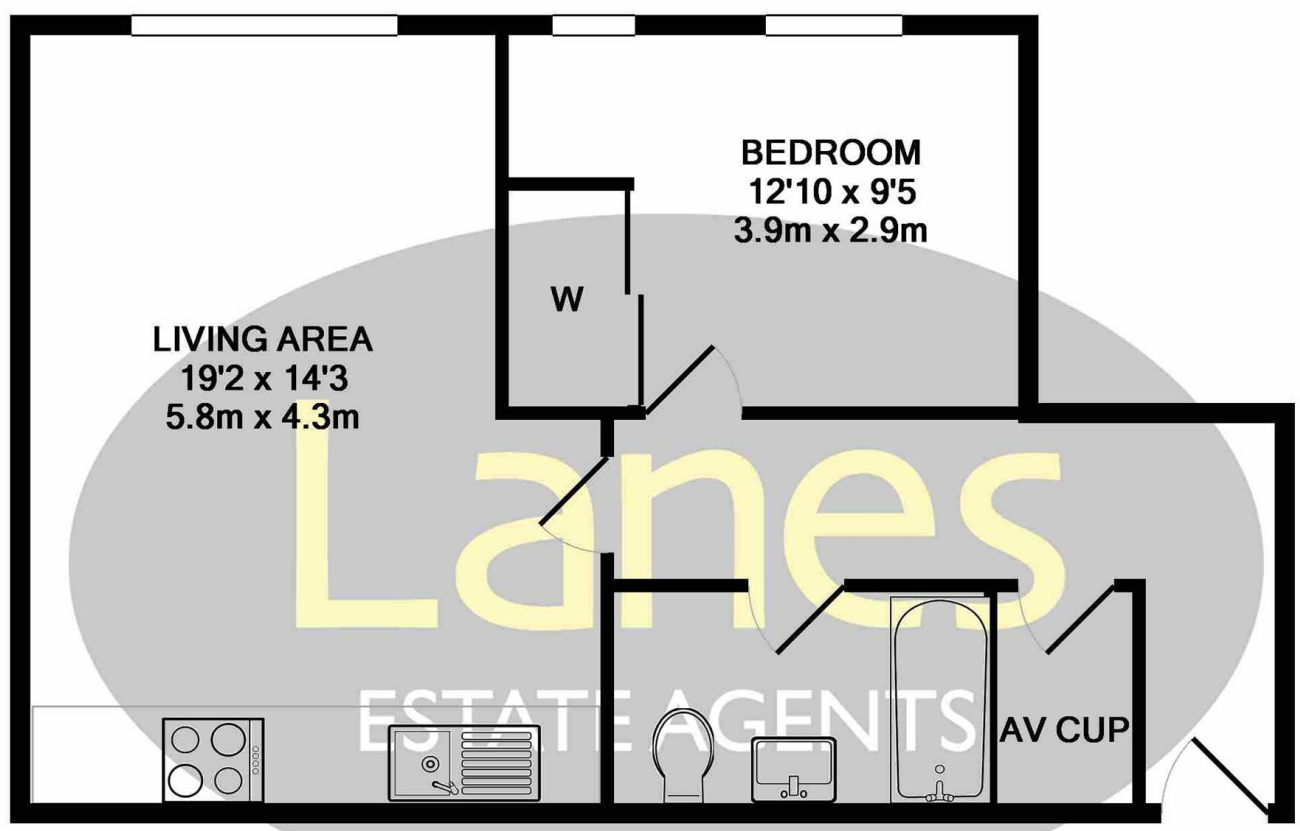

2 ATLANTIS COURT TOTAL APPROX. FLOOR AREA 531 SQ.FT. (49.3 SQ.M.)

Whilst every attempt has been made to ensure the accuracy of the floor plan contained here, measurements of doors, windows, rooms and any other items are approximate and no responsibility is taken for any error, omission, or mis-statement. This plan is for illustrative purposes only and should be used as such by any prospective purchaser. The services, systems and appliances shown have not been tested and no guarantee as to their operability or efficiency can be given
Made with Metropix ©2018

