

Day & Co  
ESTATE AGENTS

28 Cavendish Street

Keighley

BD21 3RG



5 James Street, Oakworth,  
Keighley, West Yorkshire, BD22  
7PE

£215,000

T: 01535 664609

W: [www.dayandcoestateagents.co.uk](http://www.dayandcoestateagents.co.uk)

E: [keighley@dayandcoestateagents.co.uk](mailto:keighley@dayandcoestateagents.co.uk)

- Superbly Presented Through Terrace
  - Spacious Dining Kitchen With Boot Room & Separate WC
  - Front Garden & Patio
  - EPC Rating D
- Three Double Bedrooms
  - Bathroom With Four Piece Suite
  - Ever Popular Village Of Oakworth

SUMMARY

**\*\*A SUPERBLY PRESENTED 3 BEDROOM THROUGH TERRACE, POPULAR VILLAGE LOCATION OF OAKWORTH WITH EXCELLENT ACCESS TO THE PRIMARY SCHOOLS & VILLAGE AMENITIES!!\*\*** Having deceptively spacious accommodation over three floors, bathroom with 4 piece suite, front garden & patio, rear yard - **VIEWING ESSENTIAL TO FULLY APPRECIATE!!** EPC RATING D.

FULL DESCRIPTION

Of interest to a variety of buyers is this superbly presented three bedroom through terrace situated in the ever popular village location of Oakworth with excellent access to village amenities and the primary school. The deceptively spacious accommodation comprises of an entrance hall, the lounge has a wood brining stove, double glazed window to the front and a radiator. The spacious dining kitchen has a range of modern base and wall mounted units, Range style cooker, stone flagged flooring and breakfast bar. There is a useful boot room with access to a separate WC. To the first floor there are two double bedrooms, the spacious house bathroom has a four piece suite comprising of a shower cubicle, freestanding bath, WC, wash hand basin, heated towel rail, double glazed window to the side. To the second floor a further double bedroom with under eaves storage and double glazed window to the front. Externally there is an enclosed garden and patio and a rear yard. Viewing essential to fully appreciate, EPC Rating D.

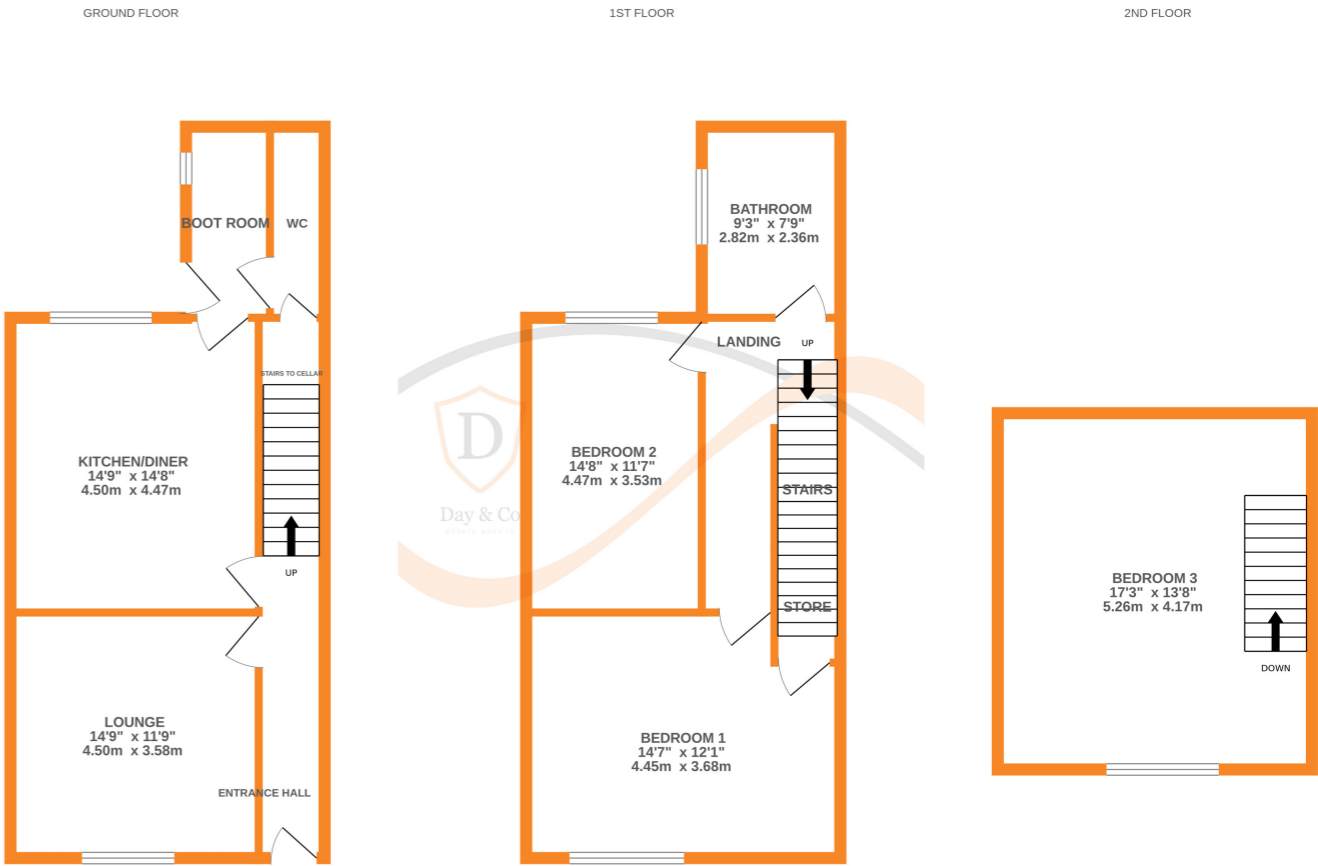

Whilst every attempt has been made to ensure the accuracy of the floorplan contained here, measurements of doors, windows, rooms and any other items are approximate and no responsibility is taken for any error, omission or mis-statement. This plan is for illustrative purposes only and should be used as such by any prospective purchaser. The services, systems and appliances shown have not been tested and no guarantee as to their operability or efficiency can be given.  
Made with Metropix ©2025