



Runnalow, Letchworth Garden City, Hertfordshire. SG6 4DS







## 2 Bedroom Detached Bungalow £475,000 Freehold

A well-presented, two-bedroom, detached bungalow located in a quiet residential area just a short walk from Letchworth town center. Complete with driveway, garage, and stunning mature 120ft rear garden.

- Fantastic potential to extend STPP
- Driveway and detached garage
- Quiet residential area
- 0.6 miles to town centre
- Well presented
- Freehold
- 120ft rear garden
- EPC rating - D. Council tax band - D



**GENERAL DESCRIPTION:****GROUND FLOOR:****Entrance Hall:**

Combi Boiler housed in cupboard. Storage. Loft hatch. Radiator.

**Lounge:**

Abt. 12' 4" x 11' 9" (3.76m x 3.58m) Double-glazed bay window to front aspect. Radiator. Carpet. Tv point.

**Kitchen:**

Abt. 7' 5" x 8' 8" (2.26m x 2.64m) Double-glazed window to rear aspect. Upvc door to conservatory. Tiled floor. Tiled splashback. Worktops with wall and base units. Sink & drainer. Plumbed appliances.

**Conservatory:**

Abt. 7' 3" x 14' 2" (2.21m x 4.32m) Part brick built. UPVC door to rear garden. Double-glazed windows to rear and sides. Radiator. Tiled floor.

**Bedroom one:**

Abt. 12' 2" x 10' 8" (3.71m x 3.25m) Double-glazed bay window to front aspect. Radiator. Carpet. Built-in cupboard. Built-in storage over and to sides of bed.

**Bedroom two:**

Abt. 10' 6" x 8' 4" (3.20m x 2.54m) Carpet. Radiator. Double UPVC doors to the conservatory. Built-in cupboards. Currently utilized as snug.

**Bathroom:**

Obscured double glazed window to rear. Heated towel rail. Bath with wall-mounted shower and glass screen. Fully tiled floor and walls. Wall-mounted basin. Low-level WC. Extractor fan.

**EXTERIOR:****Front garden:**

Block paved three-car driveway. Hedged screening. Lawn. Timber gate.

**Garage:**

Block paved three-car driveway. Hedged screening. Lawn. Timber gate.







These particulars are a guide only and do not constitute an offer or a contract. The floor plan is for identification purposes only and not to scale. All measurements are approximate and should not be relied upon if ordering furniture, white goods and flooring etc. We have presented the property as we feel fairly describes it but before arranging a viewing or deciding to buy, should there be anything specific you would like to know about the property please enquire. Satchells have not tested any of the appliances or carried out any form of survey and advise you to carry out your own investigations on the state, condition, structure, services, title, tenure, and council tax band of the property. Some images may have been enhanced and the contents shown may not be included in the sale. Satchells routinely refer to 3rd party services for which we receive an income from their fee. If you would like us to refer you to one of these services please ask one of our staff who will pass your details on. We advise you check the availability of the property on the day of your viewing.



## Ground Floor

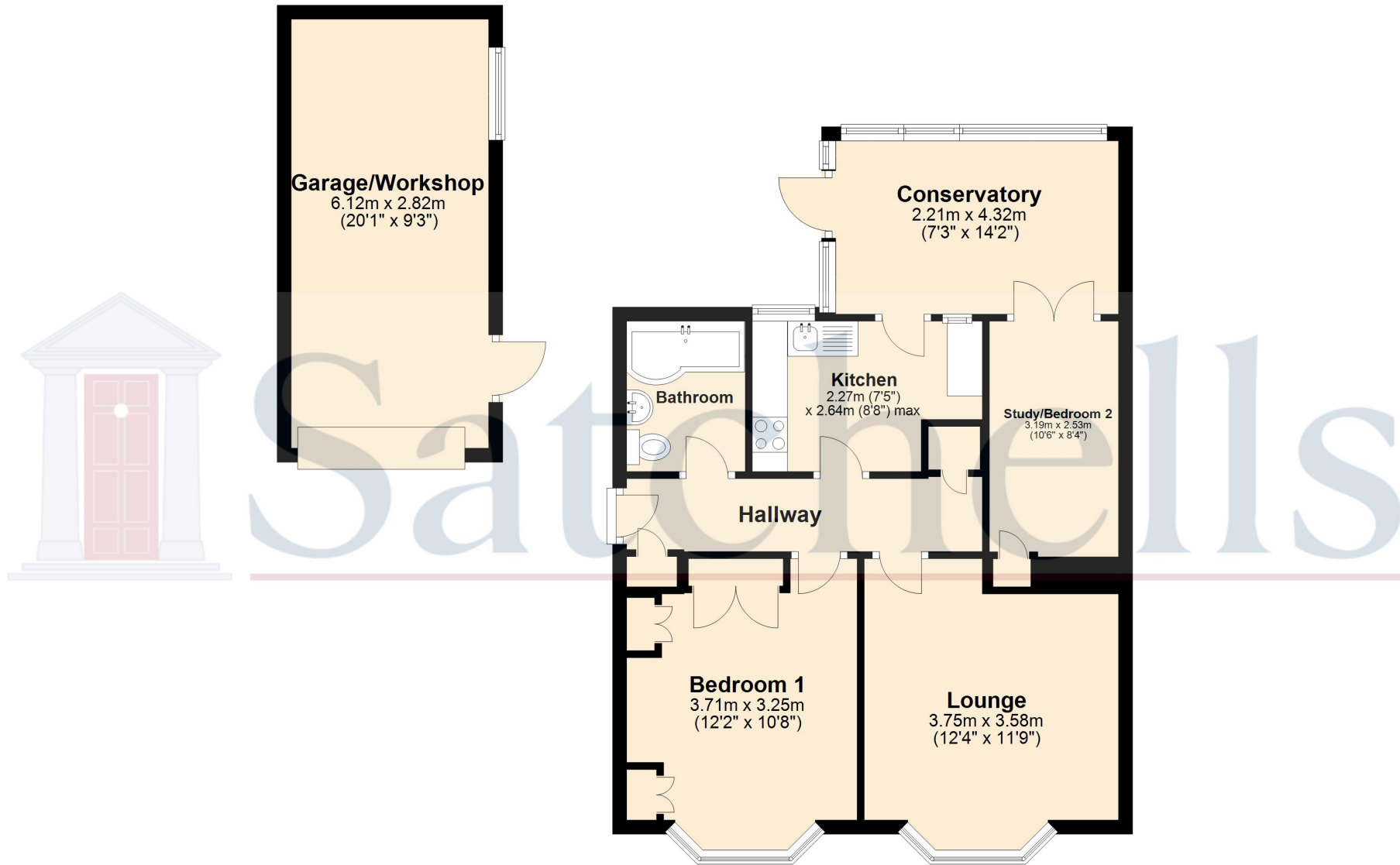

For illustrative purposes only - NOT TO SCALE - Measurements shown are approximate. The size and position of doors, windows, appliances and other features are approximate.  
Plan produced using PlanUp.