

FOR
SALE



Chessington Road, West Ewell, Surrey KT19 9XF

£220,000 - Leasehold



252, Chessington Road, Ewell, Epsom, KT19 9XF 0208 394 2555 sales@jacksonnoon.com

PROPERTY SUMMARY

JACKSON NOON ESTATE AGENTS are pleased to offer this WELL PRESENTED ONE BEDROOM FLAT located close to EWELL WEST STATION AND LOCAL AMENITIES with lounge/diner, MODERN KITCHEN AND BATHROOM, double glazing, gas central heating.....IDEAL FIRST TIME BUY.....CALL NOW TO VIEW.

POINTS OF INTEREST

- *One Bedroom First Floor Flat*
- *Lounge/Diner*
- *Modern Kitchen & Bathroom*
- *Double Glazing*
- *Gas Central Heating*
- *Close To Ewell West Station*
- *Ideal First Time Or Investment Buy*



ROOM DESCRIPTIONS

Front Door to

Lounge/Diner

23' 9" x 9' 0" (7.24m x 2.74m) Radiator, air conditioning unit, laminate floor, skylight window

Lobby

Tiled floor, cupboard with space for tumble dryer

Kitchen

17' 5" x 5' 1" (5.31m x 1.55m) Single drainer 1 1/2 bowl stainless steel sink unit inset in roll top work surface, range of cupboards and units, wall mounted boiler, plumbing for autowash, space for fridge and freezer, fitted oven and hob, extractor, access to loft, tiled walls and floor, skylight window

Bedroom 1

15' 3" x 14' 1" (4.65m x 4.29m) Radiator, feature fireplace, access to loft, air conditioning unit, double glazed window

Modern Bathroom

Comprising panel enclosed bath with mixer tap, fitted shower, low level wc, wash hand basin, heated towel rail, tiled walls and floor, two double glazed windows

Chessington Road

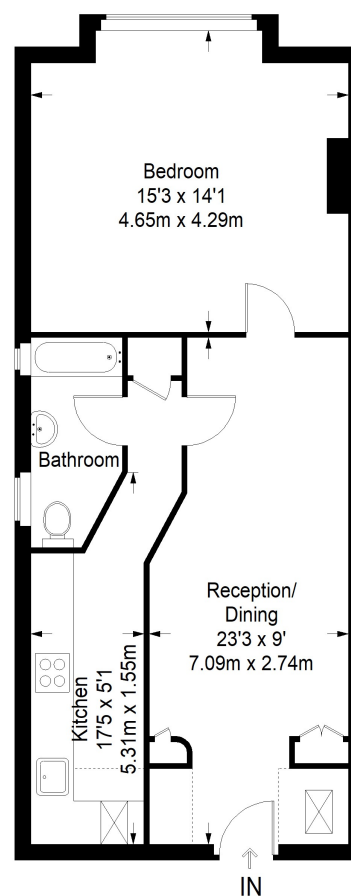

First Floor = 547 sq ft

Approximate Gross Internal Area
FIRST FLOOR = 547 sq ft / 50.82 sq m
Total = 547 sq ft / 50.82 sq m

This plan is for layout guidance only. Not drawn to scale unless stated. Windows and door openings are approximate. Whilst every care is taken in the preparation of this plan, please check all dimensions, shapes and compass bearings before making any decisions reliant upon them. (ID357409)