





- Entrance Hall
- Lounge
- Kitchen Dining Room
- Two Good Size Bedrooms
- Two Good size Bedrooms
- Large Bathroom
- Large Rear Garden
- Off Road Parking.
- Cul-De-Sac Location

Description

A well proportioned two bedroom end mews style house, occupying a cul-de-sac location in this popular Cheshire village. the property would make an ideal first time home or would be equally suited to someone looking at downsizing. With PVCu double glazed windows and gas central heating. The accommodation comprises: Entrance hall, lounge, kitchen dining room, first floor landing, two good size bedrooms and bathroom. Outside there is an open plan front garden along with a drive for off road parking and there is a large, lawned back garden.



Location
Tenure

EPC Rating:



Ground Floor

Approx. 28.2 sq. metres (303.3 sq. feet)

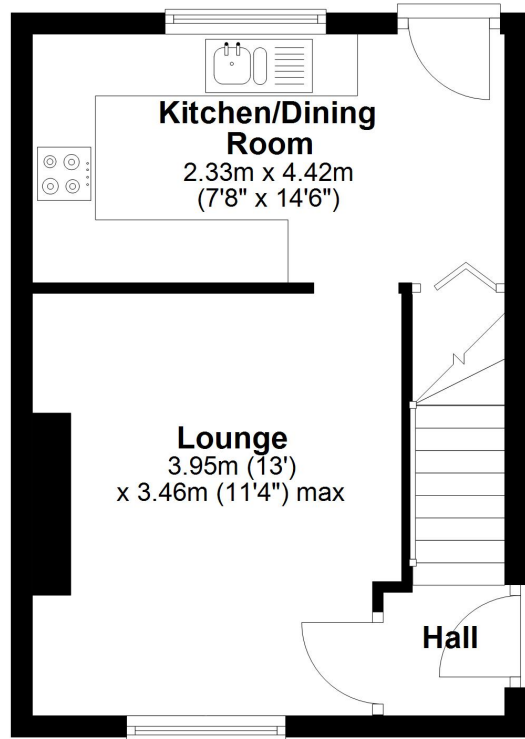

First Floor

Approx. 28.2 sq. metres (303.3 sq. feet)

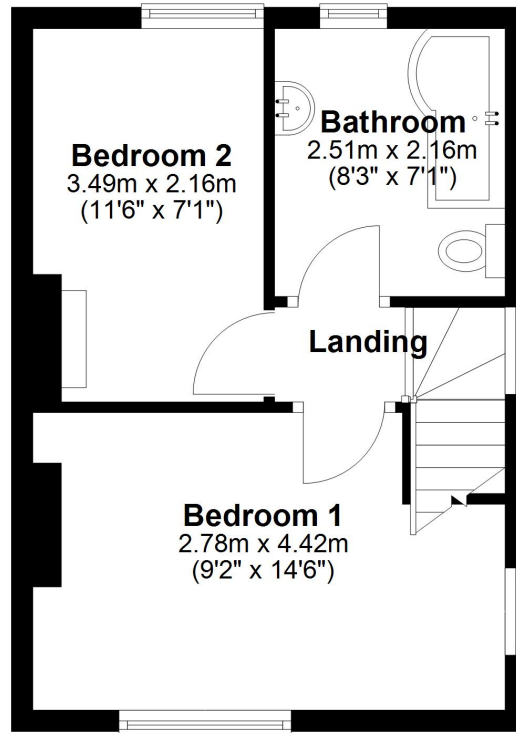

Total area: approx. 56.4 sq. metres (606.7 sq. feet)



Williams Estates is the trading name of Williams Estates (Ltd). Registered address 33, The Green, Hartford, Northwich, Cheshire, CW8 1QA.

Reg number 07682683. Director Andrew P Williams