



Three Bedroom Terraced House
Glencoe Road, Chatham, Kent, ME4 5QD

Offers in Excess of £245,000
Freehold

Glencoe Road, Chatham, Kent, ME4 5QD

Offers in Excess of £245,000

Freehold

Description

This is a great opportunity for the first time buyer and if you are looking for a home you can move straight into, then this is the one. The current owners have presented and maintained throughout. The accommodation comprises of storm porch and door leading into the reception room, which is currently being used as the dining room, this is a great room to entertain with family and friends. Continuing through to the second reception room this is a lovely room to unwind and chill in, with a cosy and relaxing feel. The kitchen offers a range of wall and base units, worksurfaces, integrated gas hob and electric oven. Also has the benefit of offering a utility room which also includes fridge/ freezer, washer, dryer, dishwasher and fitted storage unit. The bathroom is located on the ground floor with a modern fitted bathroom suite and shower.

Moving upstairs, you are welcomed to three bedrooms, two of which are double and the third is off the second bedroom and is currently being utilised as a walk in wardrobe, but would make a good size third bedroom. The rear garden is mainly laid to lawn, with a patio area, and enclosed with a fence surround. This beautiful home needs to be viewed to appreciate what it has to offer. Please call the sales team for further details.

Key Features

- An ideal first time buy
- Three bedroom terraced
- Immaculately presented
- Two reception rooms
- Popular location
- Convenient for Chatham Town Centre
- Tastefully decorated
- Garden

Local Area

Chatham is located within the Medway towns with good transfer links by rail into Central London and Ebbsfleet International plus road connections to the M2/M25 & M20. Amenities include a bustling Town Centre, the Historic Dockyard, Capstone Ski & Snowboard centre and nearby Gillingham FC and Rochester Castle & Cathedral.

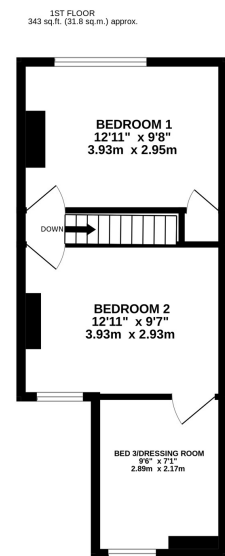
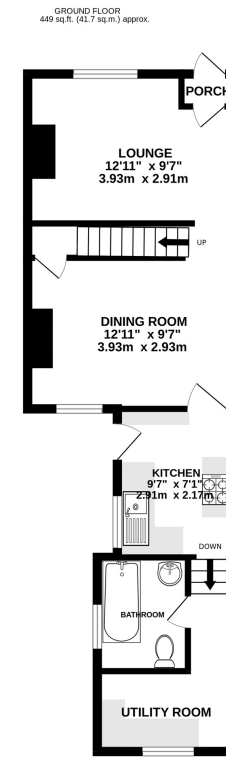

TOTAL FLOOR AREA : 791 sq.ft. (73.5 sq.m.) approx.

Whilst every attempt has been made to ensure the accuracy of the floorplan contained here, measurements of doors, windows, rooms and any other items are approximate and no responsibility is taken for any error, omission or mis-statement. This plan is for illustrative purposes only and should be used as such by any prospective purchaser. The services, systems and appliances shown have not been tested and no guarantee as to their operability or efficiency can be given.

Made with Metropix ©2024



Property Location

Glencoe Road, Chatham, Kent, ME4 5QD

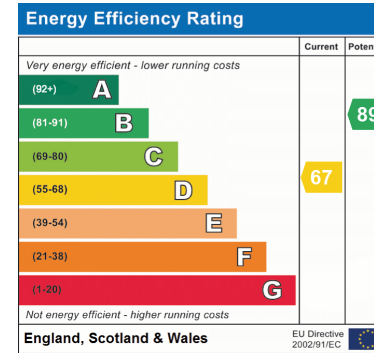
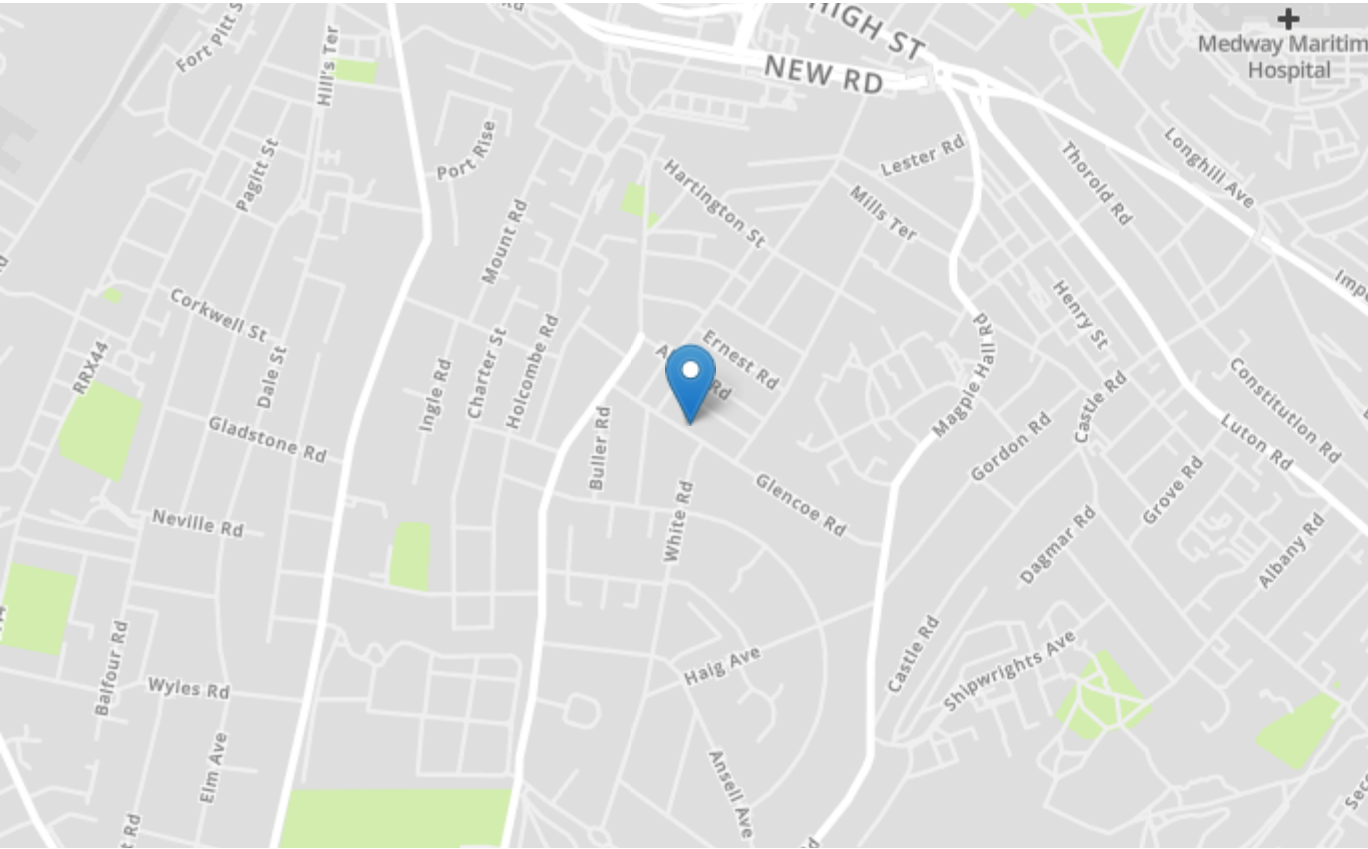

Tenure	Freehold
Lease Term	N/A
Ground Rent	N/A
Service Charge	N/A
Local Authority	Medway
Council Tax	Band B

Greyfox Walderslade

Unit 2, Thetford House
Walderslade Village Centre
Walderslade Road
Chatham
Kent
ME5 9LR
Tel: 01634 672227 Email:
walderslade@greyfox.co.uk

Greyfox Rainham

67C High Street
Rainham
Kent
ME8 7HS
Tel: 01634 377737 Email:
rainham@greyfox.co.uk

Agent Notes

These particulars are prepared as a general guide to a broad description of the property and should not be relied upon as a statement or representation of fact and do not constitute part of an offer or contract. The seller does not make or give nor do our employees or Greyfox have authority to make or give any representation or warranty to the property. We have not carried out a structural survey and the services, appliances and specific fittings have not been tested. All photographs, measurements, floorplans and distances referred to are given as a guide only and should not be relied upon for the purchase of carpets or any other fixtures or fittings. Lease details, service charges and ground rent (where applicable) and council tax are given as a guide only and should be checked and confirmed by you on inspection and your solicitor prior to exchange of contracts. If there are any points of particular importance to you we will be pleased to check the information for you and to confirm that the property remains available. This is particularly important should you be travelling some distance to view and where statements have been made by us to the effect that the information has not been verified. The copyright of all details, photographs and floorplans remain exclusive to Greyfox. For details of our privacy policy and referral fee arrangements with any of our selected partner companies please visit <https://www.greyfox.co.uk/legal/privacy> and <https://www.greyfox.co.uk/referral-fees>.