

FOR SALE

£320,000

Manor Road, Hoylake, Wirral, Merseyside. CH47 3DE



Well Proportioned Traditional Semi Detached Family Home! Offered with the added benefit of no onward chain this three/four bedroom property is ideally located for those seeking the perfect balance of spacious accommodation, convenience and a rarity for central Hoylake with is having off road parking. Manor Road is an excellent choice if your looking to be within walking distance to schools, shops and a train station! Hoylake is a bustling town with a broad range of amenities perfect with the beach just a short stroll and you have parks, restaurants and bars on your doorstep.





Ground Floor

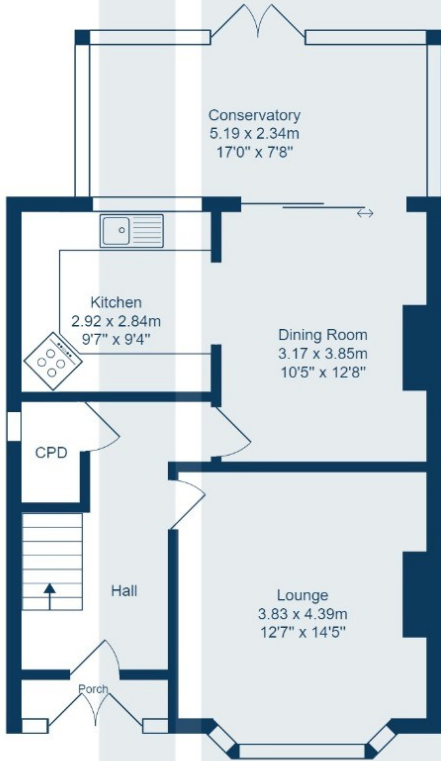

1st Floor

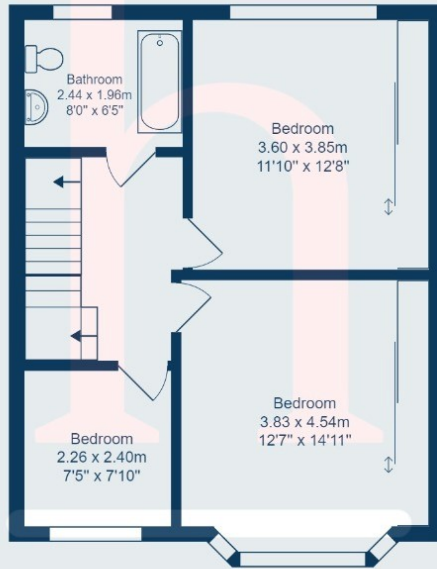

2nd Floor

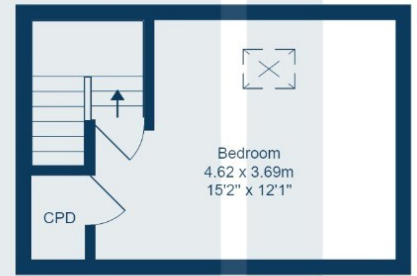

Total Area: 133.6 m<sup>2</sup> ... 1438 ft<sup>2</sup>

All measurements are approximate and for display purposes only.