



Carre Mews, London, SE5 9LS

Cow & Co
LONDON



A rare opportunity to acquire this beautifully presented 3 bedroom mews house overlooking Myatts Field Park.

Comprising three double bedrooms, two bathrooms, south facing patio garden and fabulous a south facing roof terrace overlooking Myatts Fields.

There is also a secure off street parking space, which is very useful as parking in the area is difficult to come by due to its close proximity to Oval and Loughborough Junction stations.



- Three Bedrooms
- Two bathrooms
- Mews house
- South facing roof terrace
- Private courtyard garden
- Moments away from Myatts Fields
- Immaculate condition throughout
- Close to Oval tube station

Carre Mews, SE5

Approximate Gross Internal Area
 Ground Floor = 28.6 sq m / 415 sq ft
 First Floor = 33.8 sq m / 364 sq ft
 Second Floor = 16.8 sq m / 181 sq ft
 Total = 89.2 sq m / 960 sq ft

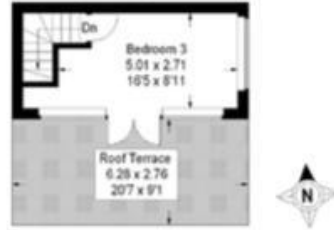

Second Floor



First Floor



Ground Floor

This plan is for layout guidance only. Not drawn to scale unless stated. Windows and door openings are approximate. Whilst every care is taken in the preparation of this plan, please check all dimensions, shapes and compass bearings before making any decisions reliant upon them. (D151587)

Energy Efficiency Rating		Current	Potential
<i>Very energy efficient - lower running costs</i>			
(92 to 100)	A		
(81 to 91)	B		87
(69 to 80)	C	76	
(55 to 68)	D		
(39 to 54)	E		
(21 to 38)	F		
(1 to 20)	G		
<i>Not energy efficient - higher running costs</i>			
England, Wales & N.Ireland		EU Directive 2002/91/EC	

Tel: 0208 065 0010
 Email: thehub@cowandco-london.com
 Web: cowandco-london.com

Agents note: All measurements are approximate and whilst every attempt has been made to ensure accuracy they are for general guidance only and must not be relied on. The fixture and fittings referred to have not been tested and therefore no guarantee can be given that they are in working order. Internal photographs are reproduced for general information and it must not be inferred that any item shown is included with the property.

Cow & Co
 LONDON