

Truuli



Chipstead Avenue, Thornton Heath, Surrey, CR7

£425,000 Freehold

- Ready to move in
- Close to a plethora of local transport and amenities
- Space to extend (STPP)
- Thornton Heath Recreation ground within easy access
- Modern kitchen
- Easy access of Thornton Heath mainline station
- Guide price £425,000 - £450,000

2, Lansdowne Road, Croydon, Surrey, CR9 2ER

Tel: 0330 043 0002

Email: save@truuli.co.uk Web: www.truuli.co.uk

Chipstead Avenue, Thornton Heath, Surrey, CR7

£425,000 Freehold

*** Guide price £425,000 - £450,000 *** A wonderfully bright and stylish three bedroom end of terrace house for sale, located on a quiet residential street within reach of Thornton Heath mainline station.

Ground Floor
399 sq.ft. (37.1 sq.m.) approx.

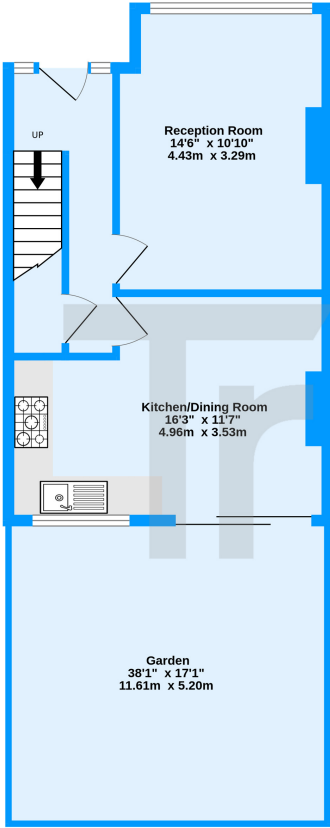

1st Floor
386 sq.ft. (35.8 sq.m.) approx.

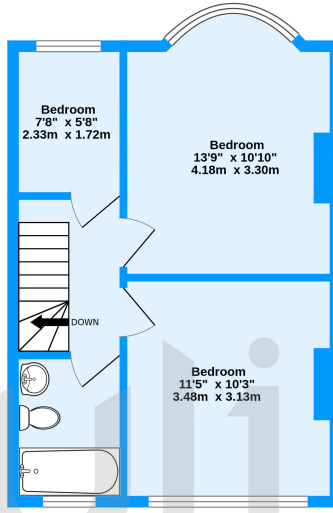

Chipstead Avenue, Thornton Heath, CR7
TOTAL FLOOR AREA: 785 sq.ft. (72.9 sq.m.) approx.
Measurements are approximate. Not to scale. Illustrative purposes only
Made with Metropix ©2023

