



## Apartment 13, Close Beg Ballawattleworth Estate, Peel, Isle of Man . IM5 1XF

Very spacious and well presented two bedroom apartment with new bathroom, new carpets and new kitchen. The apartment also enjoys distant rural views towards Peel Hill and the convenience of close proximity to restaurant, gym, pre-school, shop and dentist.



**£225,000 Leasehold**

## PROPERTY DESCRIPTION

---

Manxmove Estate Agents are delighted to present this wonderfully spacious first-floor apartment, located in a highly sought-after area on the Isle of Man. This beautifully presented property has recently undergone a full refurbishment, with new carpets, a modernized bathroom, and a contemporary kitchen with new white goods.

Situated in a prime location, this apartment offers convenient access to a range of local amenities, including a popular restaurant, gym, pre-school, shop, and dentist — making it perfect for both families and professionals alike.

### **\*\*Key Features:\*\***

- Generously sized first-floor apartment
- Recently fitted carpets, kitchen, and bathroom
- Close to a popular restaurant, gym, pre-school, shop, and dentist
- No onward chain – a hassle-free move
- Ideal for first-time buyers or those looking for a low-maintenance property

Don't miss out on this excellent opportunity to secure a move-in-ready apartment in a vibrant and well-connected area.

Call Manxmove today to arrange your viewing!

**INCLUSIONS** - Carpets, curtains, blinds and light fittings.

**TENURE** - Leasehold with active management company in place, charges circa £800 per annum

## FEATURES

---

- Large Purpose Built Apartment
- Recently Renovated Throughout
- 2 Bedrooms plus Modern Bathroom
- Open Plan Kitchen/Lounge/Diner
- Communal Entrance Shared with One Other Apartment
- Close to Gym, Restaurant, Shop and Nursery
- Allocated Parking Space
- No Onward Chain



## Property Images

---



## FLOORPLAN



GROUND FLOOR  
860 sq.ft. (79.9 sq.m.) approx.

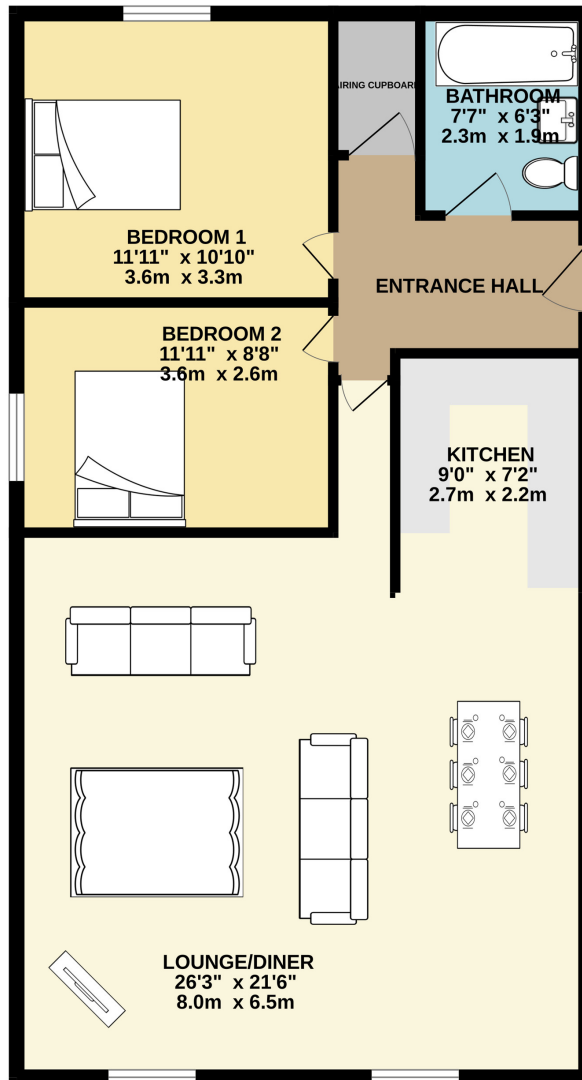

TOTAL FLOOR AREA : 860 sq.ft. (79.9 sq.m.) approx.

Whilst every attempt has been made to ensure the accuracy of the floorplan contained here, measurements of doors, windows, rooms and any other items are approximate and no responsibility is taken for any error, omission or mis-statement. This plan is for illustrative purposes only and should be used as such by any prospective purchaser. The services, systems and appliances shown have not been tested and no guarantee as to their operability or efficiency can be given.  
Made with Metropix ©2025

**DISCLAIMER:** Whilst Manxmove Ltd believe that these details are correct, neither Manxmove Ltd or their clients guarantee their accuracy in any way. Consequently, these details are not to be used to form part of any legally binding contract. Prospective purchasers or tenants are advised to visit this property to satisfy themselves as to the correctness of these details. Please note, we use wide angle camera lenses in order to show as much of each room as possible. This is not intended to mislead any prospective purchasers or tenants in any way and an honest verbal description is always available prior to viewing if required.

Manxmove Estate Agents - Douglas  
Victoria Road, Douglas, IM2 4HD  
01624 619966  
info@manxmove.im