



Glebe Road, Letchworth Garden City, Hertfordshire. SG6 1DY





4 Bedroom End of Terrace House

£425,000 Freehold

Offered to the market chain free, this extended three bedroom (four plus annex) plus study property is ideally located within walking distance of the town centre, shops, Norton Common Nature Reserve, and the mainline station. offering spacious accommodation throughout as well as a separate one-bedroom self-contained ANNEX. This property further benefits from a large driveway and enclosed rear garden.

- CHAIN FREE
- FREEHOLD
- Separate one bedroom annex
- Extended
- End terrace
- Large driveway
- Separate WC
- Walking distance to town and mainline station
- Four bedrooms + Study
- EPC rating D. Council tax band C

Ground Floor:**Living Room:**

Abt. 12' 0" x 14' 0" (3.66m x 4.27m) Laminate flooring. Double glazed window to front aspect. Radiator. Electric fire. French doors opening into:

Dining Room:

Abt. 8' 0" x 17' 2" (2.44m x 5.23m) Laminate flooring. Double glazed window to side aspect. Radiator. Storage cupboard. French doors opening through from living room. Internal door through to:

Kitchen:

Abt. 8' 9" x 12' 1" (2.67m x 3.68m) Tiled flooring. Worktops with a range of wall and base mounted units. Space for cooker, fridge freezer and plumbed appliances. Double glazed window to rear aspect. Small lobby with radiator, cloakroom and door to back garden.

Cloakroom:

Suite comprising wash basin and WC. Double glazed privacy window to rear aspect. Radiator. Tiled floor. Tiled walls.

First Floor:**Bedroom One:**

Abt. 10' 0" x 14' 1" (3.05m x 4.29m) Carpet. Radiator. Double glazed window to front aspect. Storage cupboard.

Bedroom Two:

Abt. 13' 2" x 7' 10" (4.01m x 2.39m) Carpet. Radiator. Double glazed window to rear aspect.

Bedroom Three:

Abt. 8' 8" x 8' 8" (2.64m x 2.64m) Carpet. Radiator. Double glazed window to rear aspect.

Study:

Abt. 6' 4" x 7' 10" (1.93m x 2.39m) Carpet. No window.

Bathroom:

Carpet. Double glazed privacy window to side aspect. Extractor fan. Heated towel rail. Bath with mixer taps, glass screen and wall mounted electric shower. WC.

Annex:**Entrance Hall:**

Laminate flooring. UPVC door to front.

Living Room:

Abt. 17' 4" x 10' 2" (5.28m x 3.10m) Laminate flooring. Worktop with base mounted units. Two double glazed windows to side aspect. Electrical sockets.

Bedroom 4:

Abt. 11' 9" x 10' 2" (3.58m x 3.10m) Laminate flooring. Two double glazed windows to side and rear aspect. Electrical sockets.

Bathroom:

Laminate flooring. Double glazed privacy window to side aspect. Shower with glass screen and wall mounted shower. WC. Wash basin. Tiled walls

Outside:**Front Garden:**

Driveway leading to front door and rear garden. Drop kerb to front. Gravel area providing additional parking.

Rear Garden:

Mostly laid to lawn and enclosed with fencing and mature hedges and trees. Pathway leading to annex and rear of garden which provides two garden sheds.

Additional Information:**Agents Note:**

Draft details yet to be approved by the vendor and may be subject to change.





These particulars are a guide only and do not constitute an offer or a contract. The floor plan is for identification purposes only and not to scale. All measurements are approximate and should not be relied upon if ordering furniture, white goods and flooring etc. We have presented the property as we feel fairly describes it but before arranging a viewing or deciding to buy, should there be anything specific you would like to know about the property please enquire. Satchells have not tested any of the appliances or carried out any form of survey and advise you to carry out your own investigations on the state, condition, structure, services, title, tenure, and council tax band of the property. Some images may have been enhanced and the contents shown may not be included in the sale. Satchells routinely refer to 3rd party services for which we receive an income from their fee. If you would like us to refer you to one of these services please ask one of our staff who will pass your details on. We advise you check the availability of the property on the day of your viewing.



Ground Floor

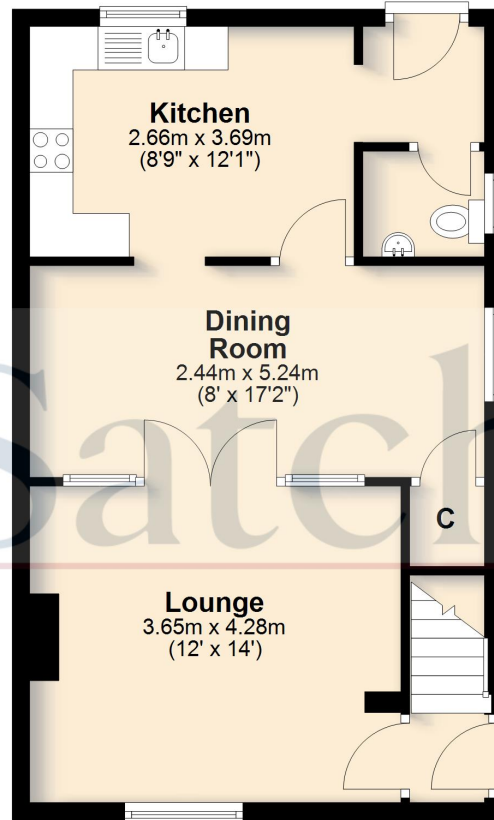
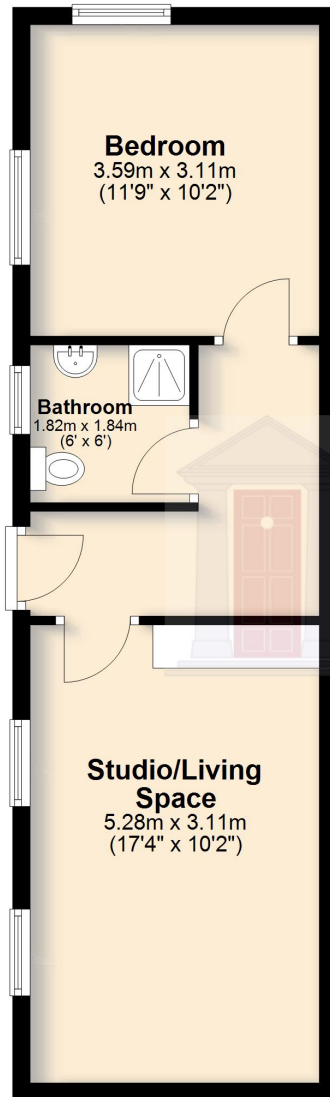

First Floor

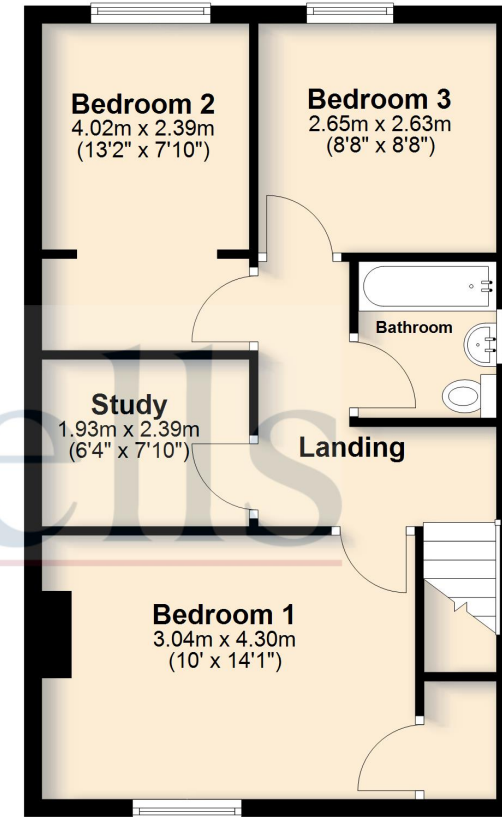

For illustration purposes only - NOT TO SCALE - Measurements shown are approximate. The size and position of doors, windows, appliances and other features are approximate.
Plan produced using PlanUp.