



Oakwood Estates are proud to present to the market this spacious three-bedroom semi-detached home, ideally situated on Stoke Poges Lane. Offering approximately 1,022 sq ft of internal accommodation, this property presents an excellent opportunity for families and investors alike, with generous living space and scope for modernisation.

Upon entering, you are welcomed by a central hallway leading through to the main living areas. To the rear of the property, the bright and airy living room provides a comfortable setting with pleasant outlooks over the garden, creating a relaxing space for everyday living. Flowing seamlessly from here is an additional reception area which acts as a natural extension of the living room, ideal for use as a dining space, family area, or open-plan entertaining zone. The kitchen is well-proportioned and arranged in a practical U-shape layout, offering ample worktop and storage space, with modern cabinetry and integrated appliances already in place.



The first floor comprises three well-sized bedrooms, including a generous principal bedroom, a second double bedroom, and a third room suitable for use as a child's bedroom, guest room, or home office. A family bathroom serves all bedrooms, with further potential for updating to suit individual tastes.

Externally, the property benefits from a substantial frontage with driveway parking for up to two vehicles, providing convenient off-street parking. The home also offers excellent potential for extension or reconfiguration (subject to the usual planning permissions), making it an attractive long-term investment.

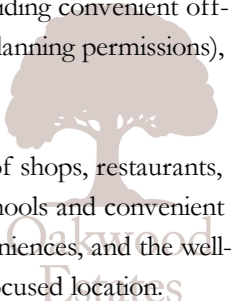
Located on Stoke Poges Lane, the property is within easy reach of Slough town centre, offering a wide range of shops, restaurants, and transport links including direct rail services into London. The area is also well-served by reputable local schools and convenient access to major road networks such as the M4 and M25. Nearby amenities include local parks, everyday conveniences, and the well-regarded Sri Guru Singh Sabha Gurdwara, adding to the appeal of this well-connected and community-focused location.



Property Information

-  3 BEDROOMS
-  SEMI DETACHED HOUSE
-  SCOPE TO EXTEND STPP

-  2 BATHROOMS
-  DRIVEWAY PARKING

					
x3	x2	x2	x3	Y	N
Bedrooms	Reception Rooms	Bathrooms	Parking Spaces	Garden	Garage

Floor Plan

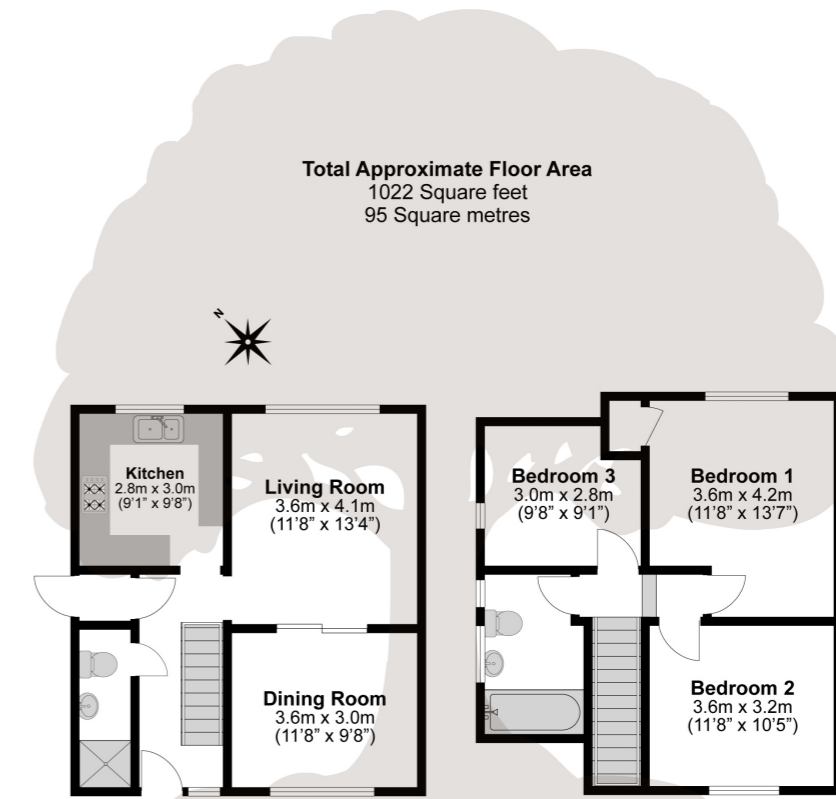

Oakwood Estates

Council Tax
Band D

Prospective purchasers should be aware that these sales particulars are intended as a general guide only and room sizes should not be relied upon for carpets or furnishing. We have not carried out any form of survey nor have we tested any appliance or services, mechanical or electrical. All maps are supplied by Goview.co.uk from Ordnance Survey mapping. Care has been taken in the preparation of these sales particulars, which are thought to be materially correct, although their accuracy is not guaranteed and they do not form part of any contract.

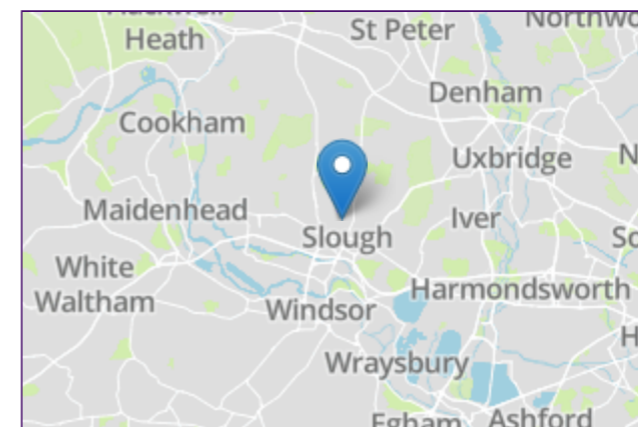

Energy Efficiency Rating		Current	Potential
Very energy efficient - lower running costs			
(92+)	A		
(81-91)	B		87
(69-80)	C		
(55-68)	D	66	
(39-54)	E		
(21-38)	F		
(1-20)	G		
Not energy efficient - higher running costs			
England, Scotland & Wales			
EU Directive 2002/91/EC			