

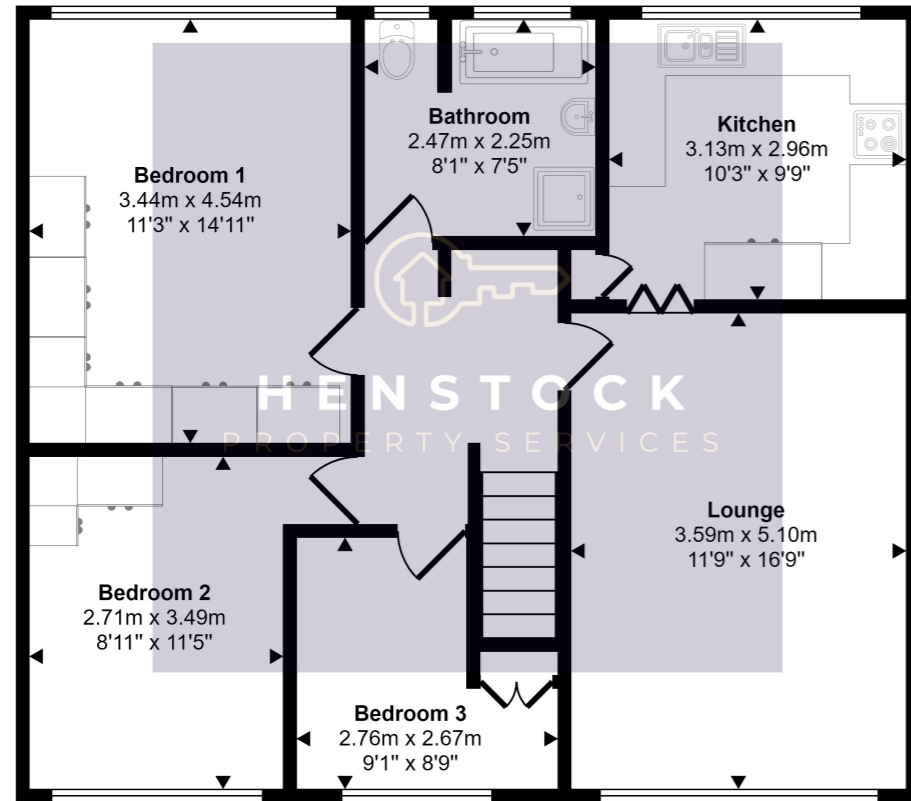

HENSTOCK
PROPERTY SERVICES

Approx Gross Internal Area
77 sq m / 825 sq ft



Floorplan

This floorplan is only for illustrative purposes and is not to scale. Measurements of rooms, doors, windows, and any items are approximate and no responsibility is taken for any error, omission or mis-statement. Icons of items such as bathroom suites are representations only and may not look like the real items. Made with Made Snappy 360.

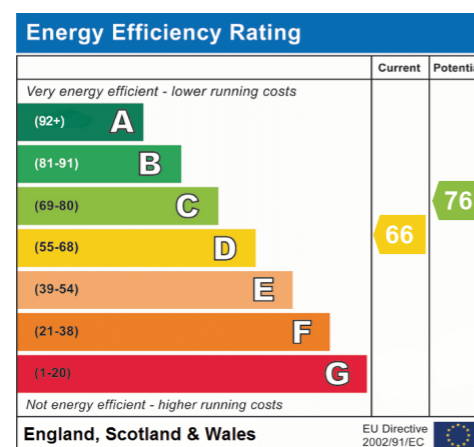

33 Heywood Old Road, Middleton, Manchester, Lancashire M24 4QS

- 3 BEDROOMED UPPER FLOOR MAISONNETTE
- NO CHAIN
- MODERN BATHROOM
- GAS CENTRAL HEATING

£125,000



PROPERTY DESCRIPTION

Henstock Property Services are delighted to bring to the market this 2 bedroomed upper floor maisonette set in this popular residential area. The living accommodation briefly comprises; private entrance with stairs up to landing area, lounge, fitted kitchen, 3 bedrooms and a bathroom. The property also has the benefit of gas central heating and double glazed windows. Ideally situated in this extremely popular spot within easy reach of schools, shops/supermarkets, leisure/fitness facilities, good public transport services and a short distance from the M60 & M62 motorway links.

UPPER FLOOR

Entrance

Lawned garden to front, private entrance door with stairs up to apartment, with landing area to all rooms.

Lounge

5.25m x 3.62m (17' 3" x 11' 11") views to front, double radiator.

Kitchen

Views to rear, real oak units, marble effect worktops, freestanding electric cooker, built in fridge and freezer, 1 1/2 bowl stainless steel sink and chrome mixer tap, plumber for washer, fully tiled walls, tiled floor, small built in storage cupboard, double radiator.

Bedroom 1

Views to front, built in wardrobes, double radiator.

Bedroom 2

Views to rear, built in wardrobes and drawer packs, double radiator.

Bedroom 3

L shaped room, views to front, built in storage cupboard, single radiator.

Bathroom

Views to rear, modern white suite comprising; bath, double base walk in shower cubicle with wall mounted flexi hose and rain showers, floating wall mounted vanity sink with storage below, close coupled w.c, fully tiled walls, tiled floor, spotlights,

