



The Crescent, Letchworth Garden City, Hertfordshire. SG6 1SW





3 Bedroom Semi-Detached House £475,000 Leasehold

A nicely presented three-bedroom family home situated in a fantastic area within walking distance to the train station. The property benefits from two separate reception rooms, gas central heating, driveway, large garden and garage.

- Three bedrooms
- Open plan kitchen/diner
- Ideal family home
- Close to station
- Extension potential - STPP
- Driveway
- Fantastic location
- Two reception rooms
- Council tax band C
- EPC rating D





Ground Floor



First Floor

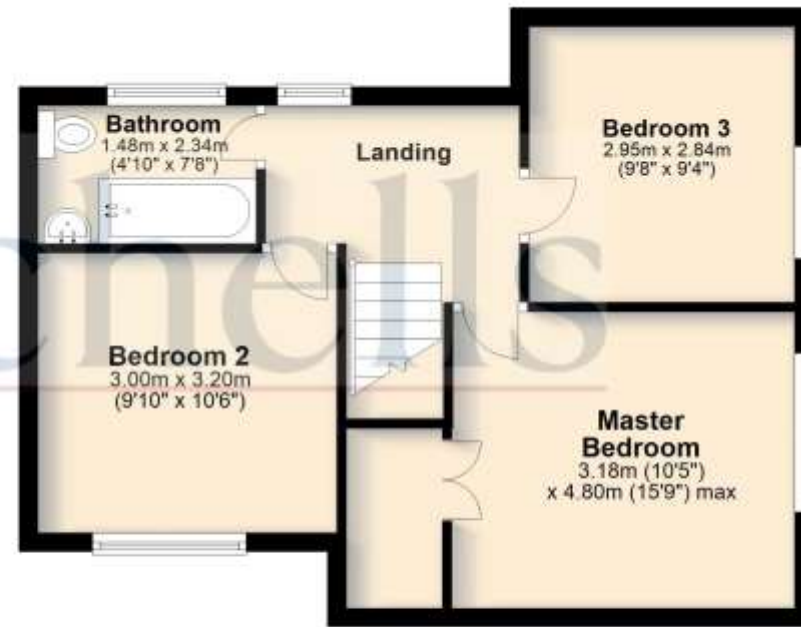

For illustrative purposes only - NOT TO SCALE - Measurements shown are approximate. The size and position of doors, windows, appliances and other features are approximate.
Plan produced using PlanUp.