

34a Mountview Road, Orpington, Kent, BR6 0HW

Property Images







Ground Floor

Approx. 90.3 sq. metres (971.5 sq. feet)

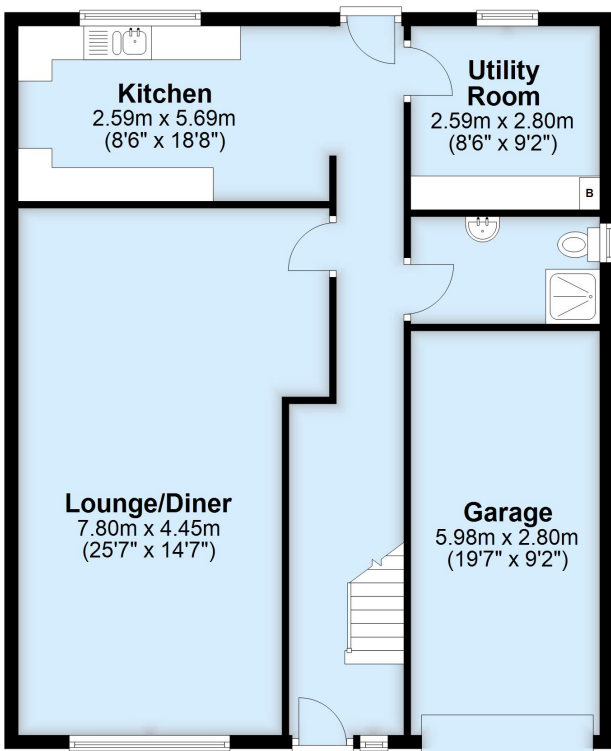

First Floor

Approx. 64.5 sq. metres (694.3 sq. feet)

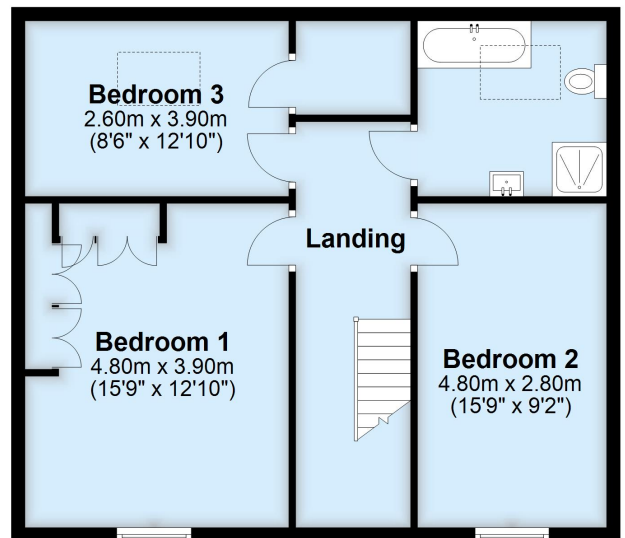

Total area: approx. 154.8 sq. metres (1665.8 sq. feet)

This plan is for general layout guidance and may not be to scale.
Plan produced using PlanUp.