



14 Grosvenor Road West, Baldock, Hertfordshire. SG7 6NZ





3 Bedroom Semi-Detached House offers in Excess of £600,000 Freehold

A three double bedroom, semi-detached property set in possibly the most popular cul-de-sac in Baldock. The property has been extended to the rear to make a modern open plan kitchen/family room with off street parking and a larger than average rear garden, this really is a great family home.

- Three bedrooms
- Extended kitchen
- Semi-detached
- Off street parking
- Large rear garden
- Stunning condition
- Awaiting EPC. Council tax band D

Ground Floor:

Hallway:

Abt. 13' 0" x 7' 0" (3.96m x 2.13m) Laminate flooring. Radiator. Under stairs storage cupboard. Doors to all rooms. Luxury vinyl tile flooring. Stairs to first floor.

Kitchen:

Abt. 24' 0" x 18' 0" (7.32m x 5.49m) Range of fitted wall and base units with quartz work tops . Sink and drainer unit with boiling water tap. Plumbing for washing machine and dishwasher. Rangemaster five ring hob, oven and extractor. Double glazed windows and doors to garden and two skylights. Radiator. Luxury vinyl tile flooring.

Music Room:

Abt. 10' 6" x 9' 2" (3.20m x 2.79m) Opens to lounge. Radiator. Parquet flooring.

Lounge:

Abt. 13' 5" x 12' 3" (4.09m x 3.73m) Double glazed bay window to front aspect. Radiator. Parquet flooring.

WC:

Abt. 5' 6" x 2' 5" (1.68m x 0.74m) Suite comprising low level WC and hand wash basin. Double glazed window to side aspect. Tiled floor.

First Floor:

Landing:

Abt. 7' 9" x 5' 6" (2.36m x 1.68m) Double glazed window to side aspect. Fitted carpet.

Bedroom One;

Abt. 11' 6" x 13' 2" (3.51m x 4.01m) Double glazed bay window to front aspect. Radiator. Fitted carpet.

Bedroom Two:

Abt. 11' 6" x 9' 0" (3.51m x 2.74m) Double glazed bay window to rear aspect. Radiator. Fitted carpet.

Bedroom Three:

Abt. 12' 9" x 7' 9" (3.89m x 2.36m) Double glazed window to front aspect. Radiator. Laminate flooring.

Bathroom:

Suite comprising low level WC, panelled bath with power shower and wash hand basin. Double glazed frosted window. Heated towel rail. Tiled floor and walls.

Outside:**Front Garden:**

Block paved front drive with parking for two cars.

Rear Garden:

Larger than average, mainly laid to lawn with patio and mature flower beds.

Additional Information:**Agents Note:**

Draft details yet to be approved by the vendor and maybe subject to change.





These particulars are a guide only and do not constitute an offer or a contract. The floor plan is for identification purposes only and not to scale. All measurements are approximate and should not be relied upon if ordering furniture, white goods and flooring etc. We have presented the property as we feel fairly describes it but before arranging a viewing or deciding to buy, should there be anything specific you would like to know about the property please enquire. Satchells have not tested any of the appliances or carried out any form of survey and advise you to carry out your own investigations on the state, condition, structure, services, title, tenure, and council tax band of the property. Some images may have been enhanced and the contents shown may not be included in the sale. Satchells routinely refer to 3rd party services for which we receive an income from their fee. If you would like us to refer you to one of these services please ask one of our staff who will pass your details on. We advise you check the availability of the property on the day of your viewing.



Ground Floor

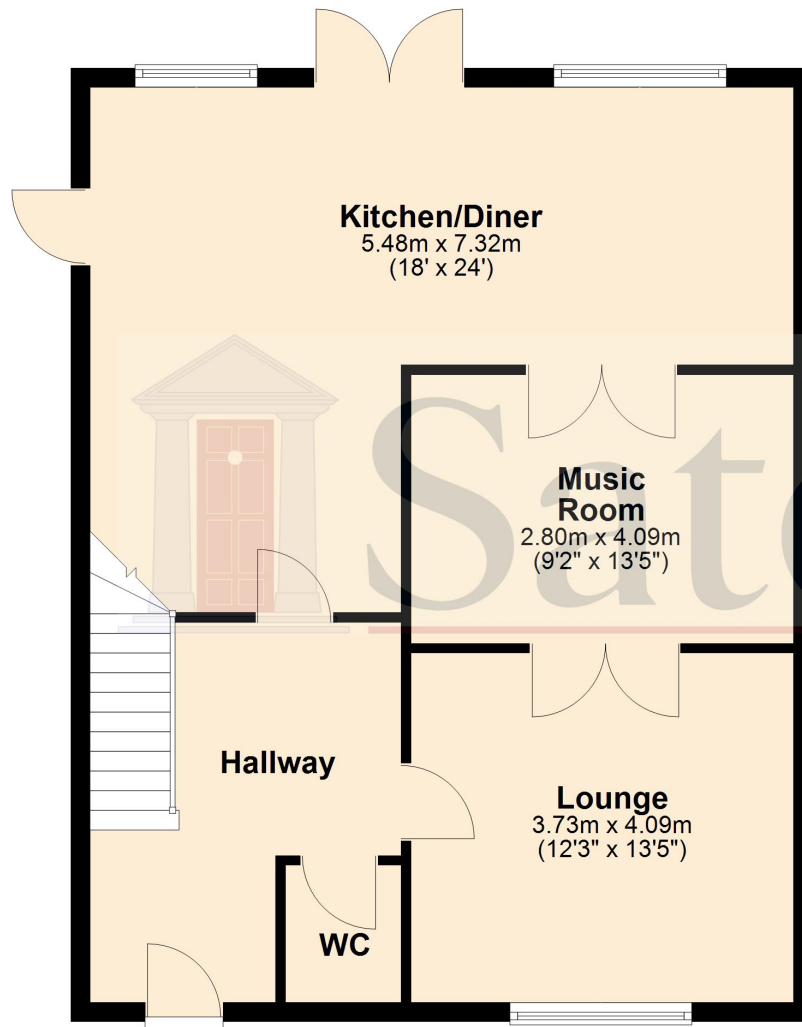

First Floor

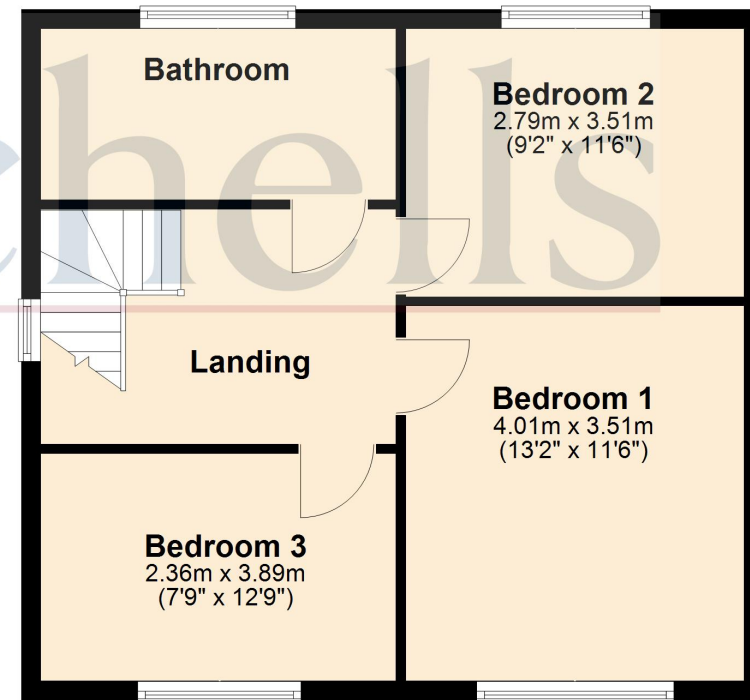

For illustration purposes only - NOT TO SCALE - Measurements shown are approximate. The size and position of doors, windows, appliances and other features are approximate.
Plan produced using PlanUp.